

KEY PLAN
N.T.S.

LEGEND

- SITE BOUNDARY
- UNDERGROUND GARAGE LIMITS
- PROPOSED ELEVATION
- PROPOSED SUBDIVISION ELEVATION
- PROPOSED INTERSECTION ELEVATION
- PROPOSED HIGH POINT
- ORIGINAL SURVEY
- PROPOSED TERRACING (MAX 3:1)
- SURFACE SLOPE
- MAJOR/EMERGENCY OVERLAND FLOW DIRECTION (> 1:100 YR)
- DEPRESSED CURB
- DC
- FINISHED FLOOR ELEVATION
- GARAGE FINISHED FLOOR ELEVATION
- UNDERSIDE OF FOOTING ELEVATION
- BUILDING ENTRANCE
- BOREHOLE NUMBER
- GROUND SURFACE ELEVATION (m)
- GROUND WATER ELEVATION (m)
- MAXIMUM WATER LEVEL (STATIC)
- MAX. PONDING VOLUME (m³)
- AREA ID
- MAX. PONDING AREA (m²)
- MAX. WATER LEVEL (STATIC)
- PONDING DEPTH (STATIC)

No.	ISSUE / REVISION	DDMMYY
4	ISSUED FOR FOURTH ENGINEERING SUBMISSION	04/03/25
3	ISSUED FOR THIRD ENGINEERING SUBMISSION	10/10/24
2	ISSUED FOR SECOND ENGINEERING SUBMISSION	28/07/24
1	ISSUED FOR FIRST ENGINEERING SUBMISSION	14/12/23

THESE DRAWINGS HAVE BEEN PRODUCED BY J.L. RICHARDS & ASSOCIATES LIMITED AND ARE SUBJECT TO COPYRIGHT AND USE RESTRICTIONS SET OUT IN THE APPLICABLE PROJECT CONTRACT. ANY USE, REUSE, OR MODIFICATION OF THESE DRAWINGS FOR PURPOSES OTHER THAN THE ORIGINAL PROJECT OR EXECUTION OF THE DESCRIBED WORK IS NOT PERMITTED OR ENDORSED WITHOUT THE PRIOR WRITTEN AUTHORIZATION OF J.L.R. J.L.R. MAKES NO WARRANTIES, EITHER EXPRESS OR IMPLIED, OF THE SUITABILITY OR FITNESS OF THESE DRAWINGS FOR ANY OTHER PURPOSE, AND ANY PARTY WHICH CHOOSES TO USE, MODIFY, OR OTHERWISE RELY ON THESE DRAWINGS WITHOUT J.L.R.'S AUTHORIZATION ACCEPTS THESE LIMITATIONS AND DOES SO AT THEIR SOLE RISK AND WITHOUT LIABILITY TO J.L.R.

VERIFY SHEET SIZE AND SCALES. THE BAR TO THE RIGHT IS 25mm IF THIS IS A FULL SIZE DRAWING.

SCALE: 1:200

CLIENT:

CONSULTANT:

PROFESSIONAL STAMP

PROJECT NORTH

PROJECT:

NAVAN RESIDENTIAL AND COMMERCIAL BLOCK 14

2983 NAVAN ROAD OTTAWA, ONTARIO

DRAWING:

GRADING AND PONDING PLAN

DESIGN: KF/MM

DRAWN: KC

CHECKED: KF

JLR #: 29899-002

DRAWING #:

C02

	1:100 Year Storage Volume (m³)	Roof Drain Release Rate (L/s)
Building A	51	2
Building B	51	2

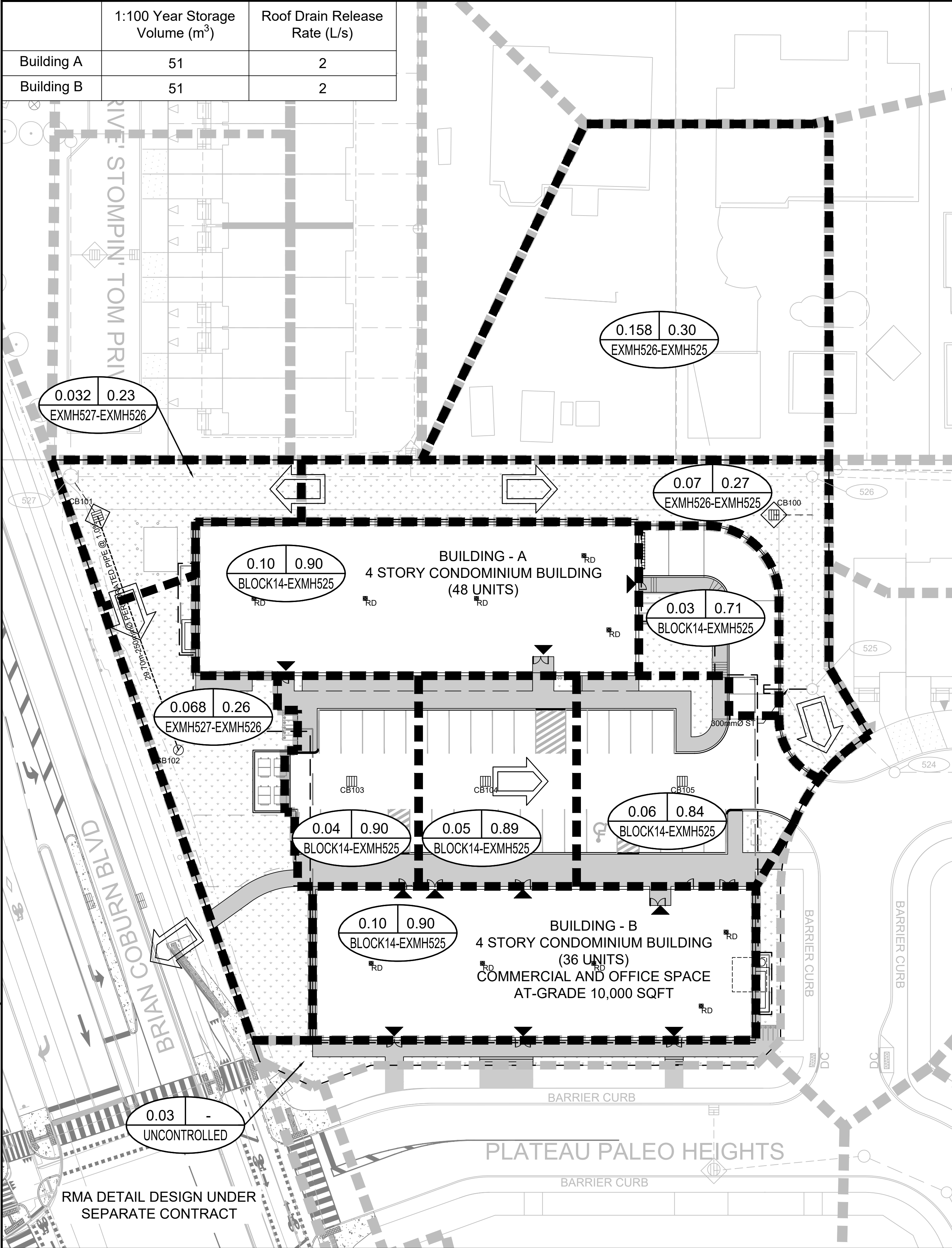

STORM DRAINAGE

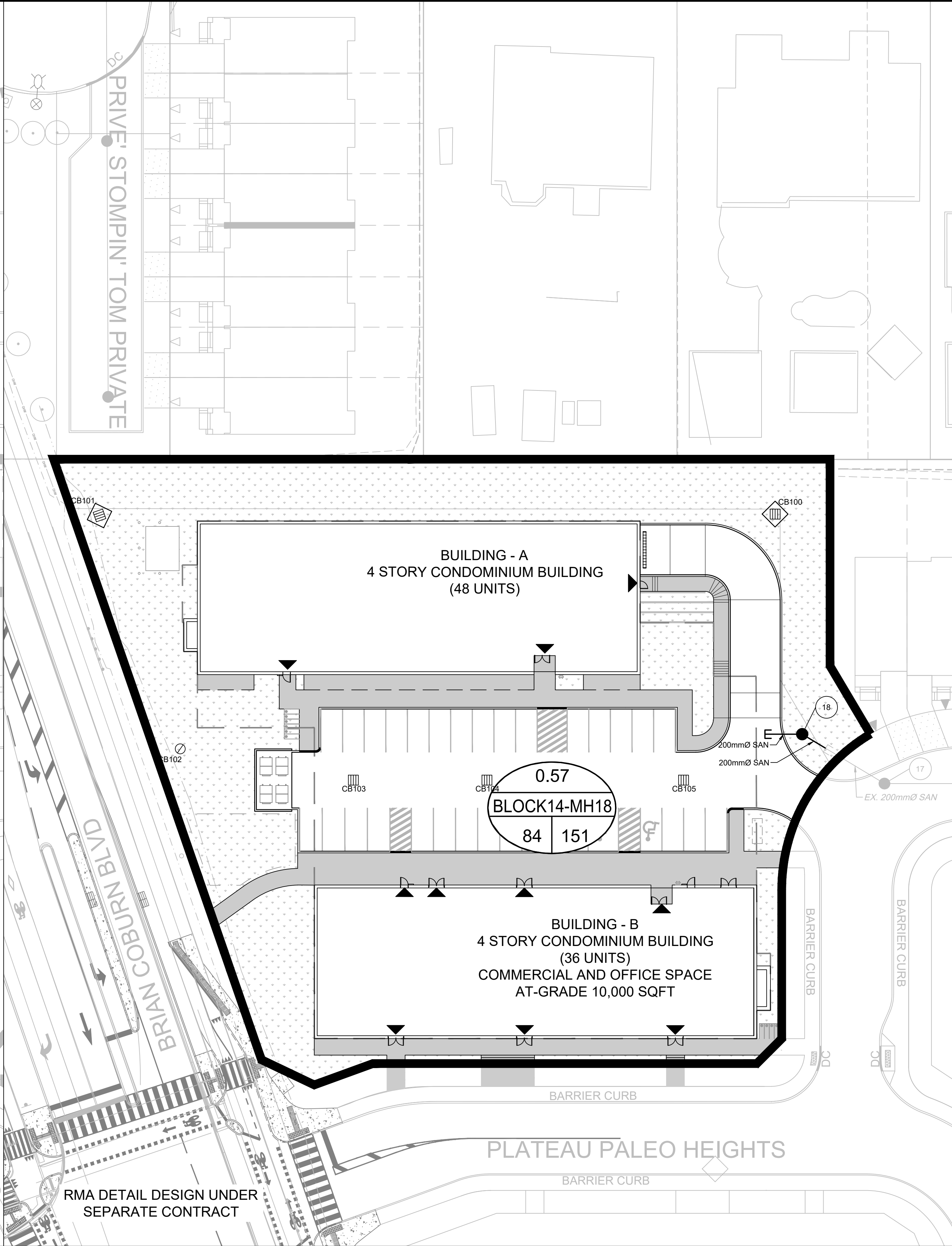

SANITARY DRAINAGE

KEY PLAN
N.T.S.

LEGEND

ISSUED FOR FOURTH ENGINEERING SUBMISSION

ISSUED FOR THIRD ENGINEERING SUBMISSION

ISSUED FOR SECOND ENGINEERING SUBMISSION

ISSUED FOR FIRST ENGINEERING SUBMISSION

No.

ISSUE / REVISION

DD/MM/YY

THESE DRAWINGS HAVE BEEN PRODUCED BY J.L. RICHARDS & ASSOCIATES LIMITED AND ARE SUBJECT TO COPYRIGHT AND USE RESTRICTIONS SET OUT IN THE APPLICABLE PROJECT CONTRACT. ANY USE, REUSE, OR MODIFICATION OF THESE DRAWINGS FOR PURPOSES OTHER THAN THE ORIGINAL PROJECT OR EXECUTION OF THE DESCRIBED WORK IS NOT PERMITTED OR ENDORSED WITHOUT THE PRIOR WRITTEN AUTHORIZATION OF J.L.R. J.L.R. MAKES NO WARRANTIES, EITHER EXPRESS OR IMPLIED, OF THE SUITABILITY OR FITNESS OF THESE DRAWINGS FOR ANY OTHER PURPOSE, AND ANY PARTY WHICH CHOOSES TO USE, MODIFY, OR OTHERWISE RELY ON THESE DRAWINGS WITHOUT J.L.R.'S AUTHORIZATION ACCEPTS THESE LIMITATIONS AND DOES SO AT THEIR SOLE RISK AND WITHOUT LIABILITY TO J.L.R.

VERIFY SHEET SIZE AND SCALES. THE BAR TO THE RIGHT IS 25mm IF THIS IS A FULL SIZE DRAWING.

SCALE: 1:300

CLIENT:

CONSULTANT:

CONSULTANT:

PROFESSIONAL STAMP

PROJECT NORTH

PROJECT:

NAVAN RESIDENTIAL AND COMMERCIAL BLOCK 14

2983 NAVAN ROAD OTTAWA, ONTARIO

DRAWING:

STORM AND SANITARY DRAINAGE PLANS

DESIGN:

CF/MM

DRAWN:

KC

CHECKED:

KF

JLR #:

29899-002

DRAWING #:

C03