

CROSSING	STM INV	STM OBV	SAN INV	SAN OBV	WTR TOP	WTR BTM	NOTES
1	67.54	67.69			67.00	66.85	EX-ABANDONED W/M
2			67.37	67.57	67.04	66.89	EX-ABANDONED W/M
3	67.55	67.85	68.05	68.25			
4					67.11	66.96	REMOVE EX-ABANDONED W/M AS REQUIRED
5	67.61	67.91			67.11	66.96	
6			67.21	67.41	68.06	67.91	DEFLECT W/M OVER SEWER, INSULATE W/2

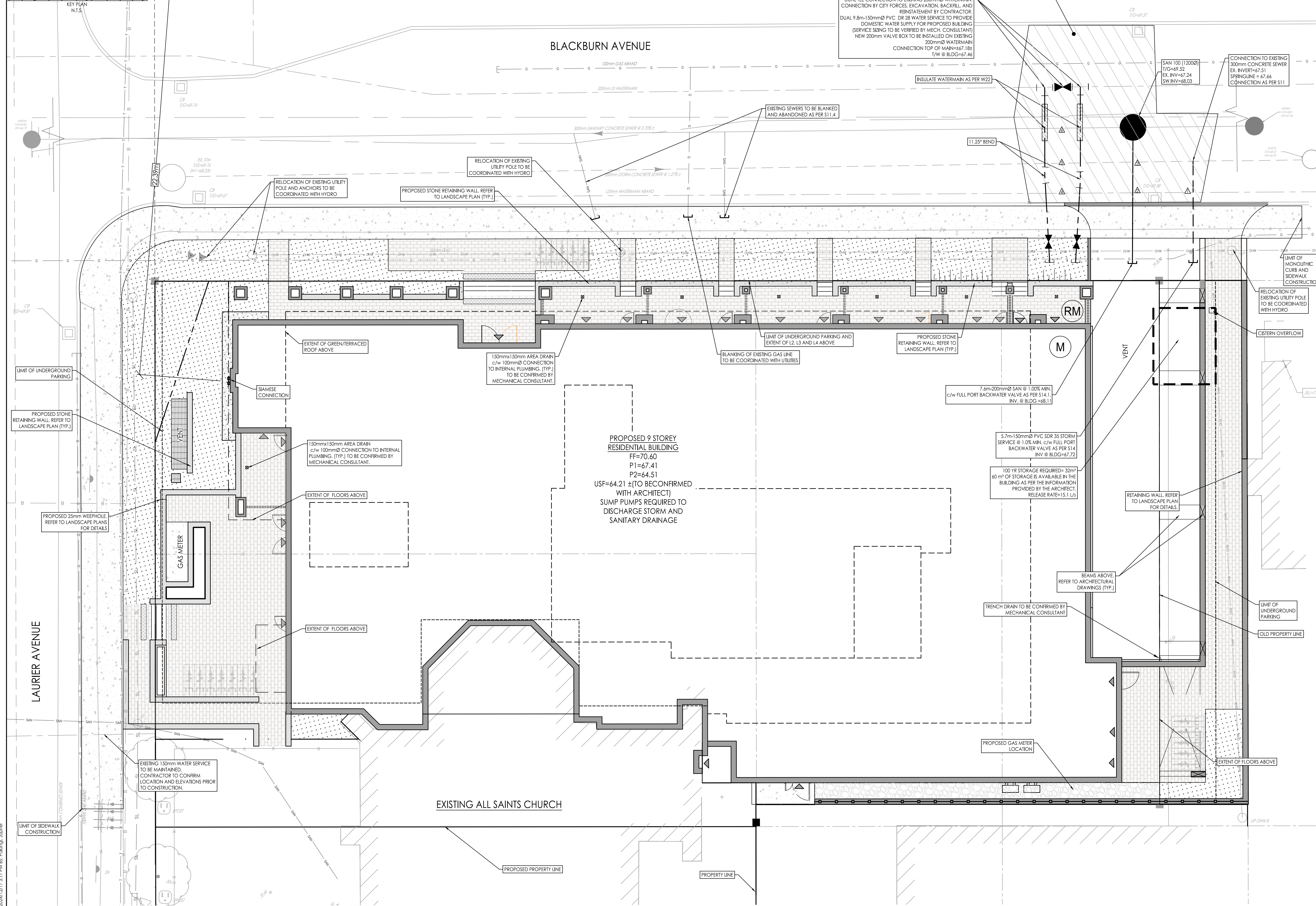
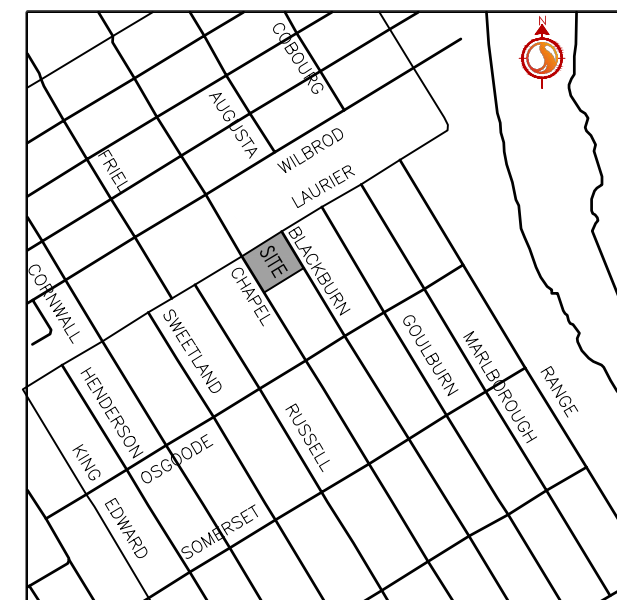

Copyright Reserved
 The Contractor shall verify and be responsible for all dimensions. DO NOT scale the drawing - any errors or omissions shall be reported to Stantec without delay.
 The Copyrights to all designs and drawings are the property of Stantec. Reproduction or use for any purpose other than that authorized by Stantec is forbidden.

Legend

	PROPOSED WATERMAIN
	PROPOSED VALVE AND VALVE BOX
	PROPOSED SANITARY SEWER
	PROPOSED STORM SEWER
	150mm x 150mm AREA DRAIN
	EXISTING WATERMAIN
	EXISTING VALVE AND VALVE BOX
	EXISTING FIRE HYDRANT
	EXISTING SANITARY SEWER
	EXISTING STORM SEWER
	EXISTING CATCHBASIN
	PROPOSED WATER METER
	PROPOSED REMOTE WATER METER
	EXISTING CABLE
	EXISTING BELL
	EXISTING TELUS
	EXISTING TRAFFIC
	EXISTING HYDRO
	EXISTING STREETLIGHT
	EXISTING GAS MAIN
	LANDSCAPED AREA- REFER TO LANDSCAPE PLAN

- Notes**
- SERVICE LATERALS TO CONNECT TO EXISTING MAIN AS PER CITY STANDARD S11.
 - CONTRACTOR TO LOCATE EXISTING SERVICES AND ANY CONFLICTS WITH EXISTING SERVICES MUST BE REPORTED TO THE ENGINEER PRIOR TO CONTINUING WITH CONSTRUCTION.
 - LOCATION OF EX. STORM, WATER AND SANITARY SERVICING WITHIN SITE TO BE CONFIRMED PRIOR TO CONSTRUCTION. SEWERS SHALL BE REROUTED/RECONNECTED AS SHOWN TO MAINTAIN SERVICING TO EX. BUILDINGS.
 - SITE PLAN PREPARED BY LINEBOX STUDIO INC. DATED SEPT. 09, 2024
 - TOPOGRAPHIC SURVEY SUPPLIED BY STANTEC CONSULTING, DATED AUG. 16 2023
 - DEVELOPMENT AND CONSTRUCTION TO ADHERE TO CITY SEWER AND WATER GUIDELINES, BY-LAWS, STANDARD DETAIL DRAWINGS, APPROVED PRODUCTS (ALL AS AMENDED) AND MECP REGULATIONS AND E-LAWS (AS AMENDED).
 - CONTRACTOR IS REQUIRED TO REGULARLY CLEAN DEBRIS AND KEEP DUST DOWN ON ALL ROADWAYS AFFECTED BY SITE.
 - SITE RELEASE RATES
 - TOTAL RELEASE RATE FROM SITE: 15.1 L/s

Revision

Rev	Description	By	Appd.	YY.MM.DD
2	ISSUED FOR REVIEW	JP	PM	24.09.13
1	ISSUED FOR REVIEW	JP	PM	24.05.19

File Name: 160401789-08.dwg
 Dwn. Chkd. Dgn. YY.MM.DD

Permit-Seal

Client/Project
 WINDMILL DEVELOPMENT GROUP LTD.
 THE EVERGREEN ON BLACKBURN
 Ottawa, ON

Title
 SITE SERVICING PLAN

Project No. 160401789
 Drawing No. SSP-1
 Scale 1:100
 Sheet 3 of 7
 Revision 2
 DWG# 19193

V:\Projects\160401789-08.dwg Design Drawing Detailed Design\160401789-08.dwg
 2024/12/17 3:17 PM J.P. ANDROZ
 ORIGINAL SHEET - ARCH-D