

W:\active\160401789\design\drawing\Detailed Design\160401789-DB.dwg  
2024/09/13 1:24 PM By: Palangj, Jupiter

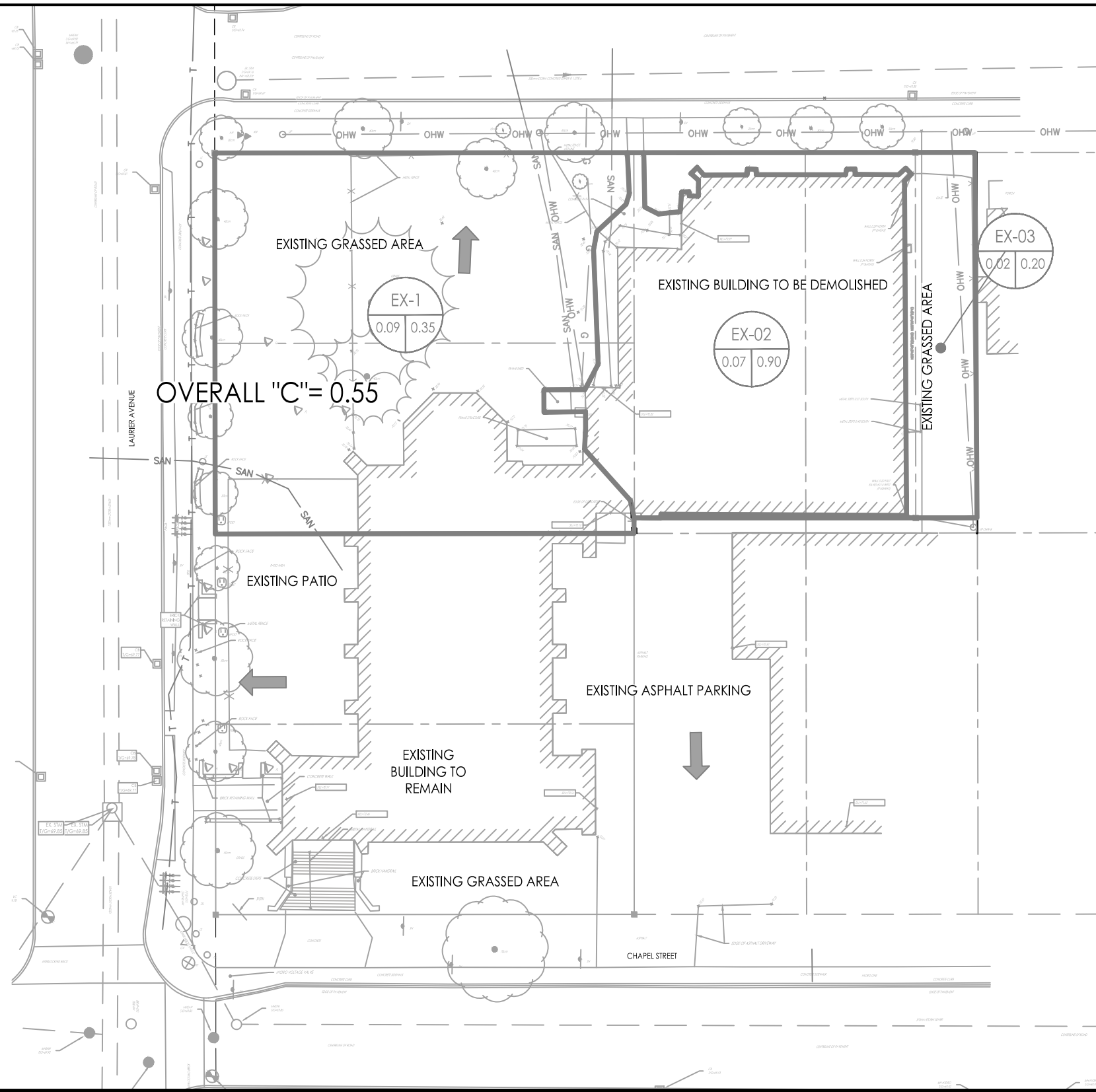

AUG, 2024  
160401789

ORIGINAL SHEET - ANSI B

**Stantec**  
Stantec Consulting Ltd.  
300 - 1331 Clyde Avenue  
Ottawa ON  
Tel. 613.722.4420  
www.stantec.com

**Legend**

	AREA ID		EXISTING DIRECTION OF OVERLAND FLOW
	RUNOFF COEFFICIENT		EXISTING STORM SEWER
	STORM DRAINAGE AREA ha.		EXISTING CATCHBASIN
	EXISTING STORM DRAINAGE BOUNDARY		

Client/Project  
WINDMILL DEVELOPMENT GROUP LTD.  
WINDMILL - ALL SAINTS  
High-Rise Development - Zoning By-law and Official Plan Amendment

Figure No.  
3.0

Title  
**EXISTING  
STORM DRAINAGE PLAN**