

C:\Users\michael.murphy\Documents\124123-L0.dwg, L0, Oct 29, 2024, 3:29pm, mmmurphy

NOTE:  
 THE POSITION OF ALL POLE LINES, CONDUITS,  
 WATERMAINS, SEWERS AND OTHER  
 UNDERGROUND AND OVERGROUND UTILITIES AND  
 STRUCTURES IS NOT NECESSARILY SHOWN ON  
 THE CONTRACT DRAWINGS, AND WHERE SHOWN,  
 THE ACCURACY OF THE POSITION OF SUCH  
 UTILITIES AND STRUCTURES IS NOT GUARANTEED.  
 BEFORE STARTING WORK, DETERMINE THE EXACT  
 LOCATION OF ALL SUCH UTILITIES AND  
 STRUCTURES AND ASSUME ALL LIABILITY FOR  
 DAMAGE TO THEM.

**NOT FOR  
CONSTRUCTION**

No.	REVISION	DATE	BY
1	ISSUED FOR SITE PLAN APPLICATION	OCT 29/24	RGJ

SCALE

DESIGN	MJT
CHECKED	RGJ
DRAWN	MJT
CHECKED	RGJ
APPROVED	RGJ

FOR REVIEW ONLY	



**NOVATECH**  
 Engineers, Planners & Landscape Architects  
 Suite 200, 240 Michael Cowpland Drive  
 Ottawa, Ontario, Canada K2M 1P6  
 Telephone: (613) 254-9643  
 Facsimile: (613) 254-5867  
 Website: www.novatech-eng.com

LOCATION  
 CITY OF OTTAWA  
 99 BILL LEATHAM, 2 & 20 LEIKEN DRIVE  
 DRAWING NAME  
**LANDSCAPE PLAN**

PROJECT No.	124123
REV	REV # 1
DRAWING No.	124123-L0



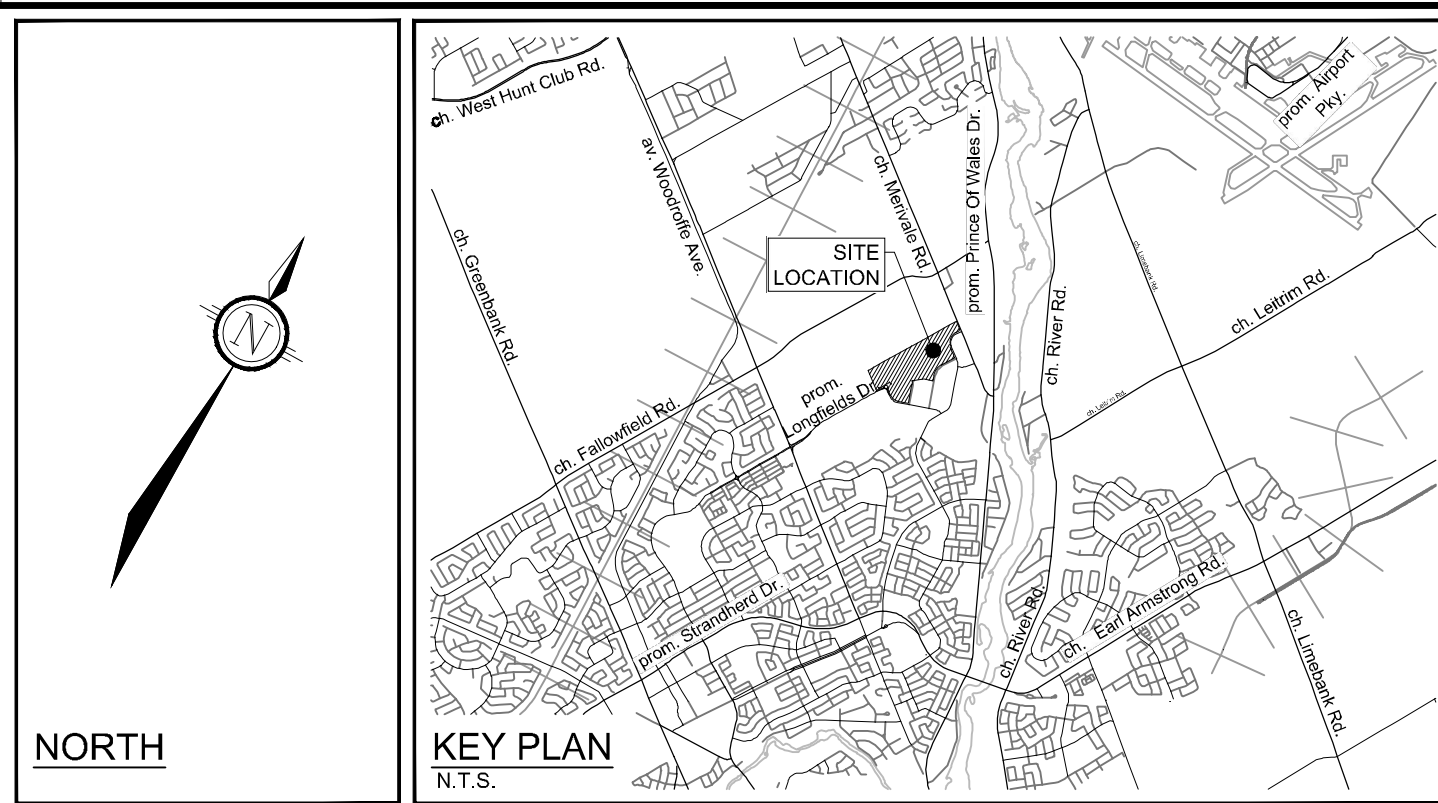
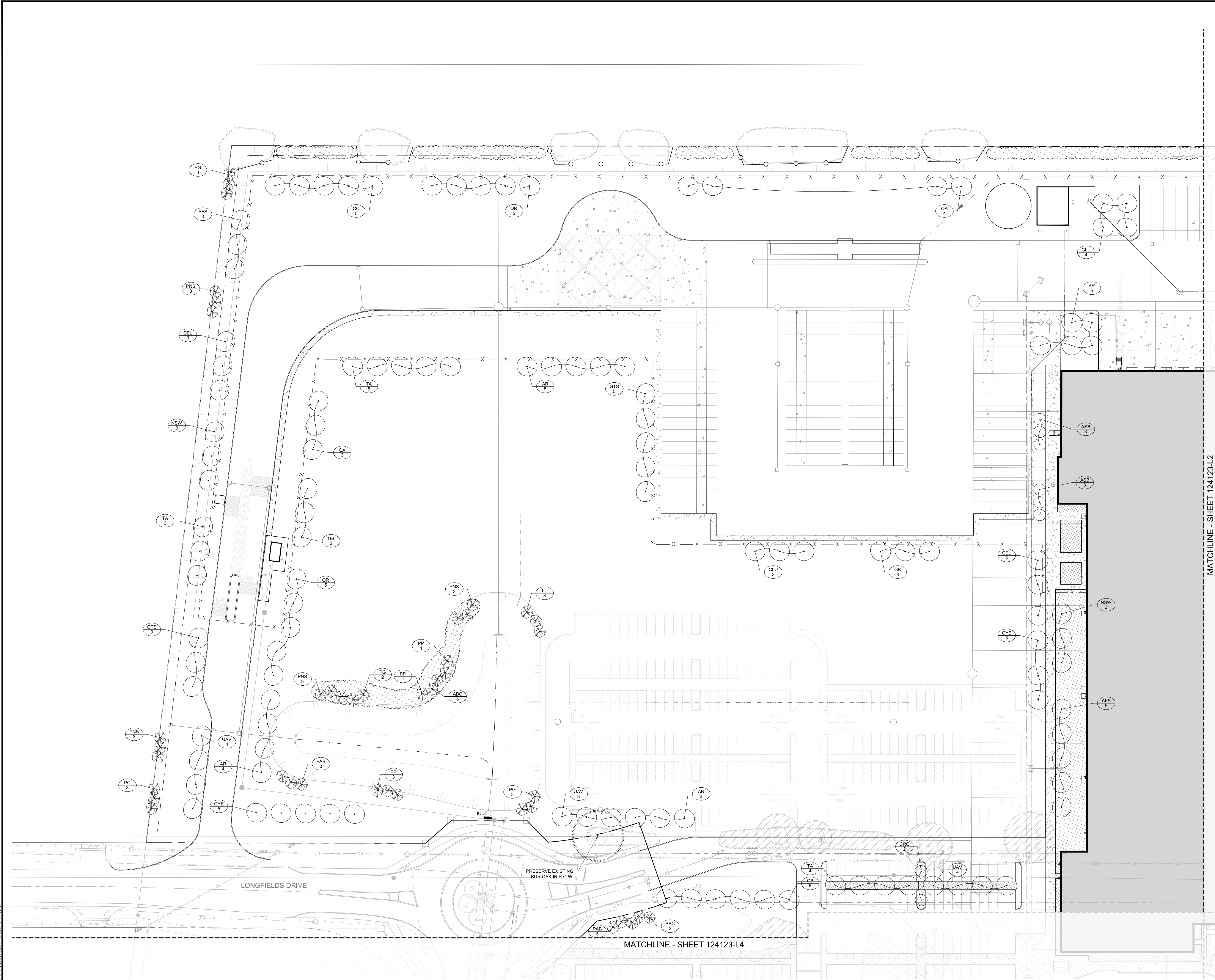

- LEGEND**
- 3-D1 DETAIL SHEET # NOVATECH OR CITY DETAIL NUMBER SEE LIST FOR CODE
  - PROPERTY LIMIT
  - PROPOSED CONCRETE
  - SHRUBS AND PERENNIALS - TREE COMPANION PLANTING
  - SHRUBS AND PERENNIALS
  - REFORESTATION AREA
  - PROPOSED DECIDUOUS TREE
  - PROPOSED CONIFEROUS TREE
  - EXISTING TREE TO REMAIN
  - EXISTING TREE TO REMOVE
  - PROPOSED SHRUBS
  - SPECIES (SEE PLANT LIST)
  - KEY ## QUANTITY
  - PROPOSED CHAINLINK FENCE 1.5m HT

- GENERAL**
1. Read and interpret this drawing set in conjunction with all the contract details and specifications, including related civil, utility, structural, architectural, mechanical, electrical, environmental, geotechnical, and survey information.
  2. The Contractor is to determine the exact location, size, material, and elevation of all existing utilities prior to commencing construction. Protect and assume responsibility for all existing utilities regardless of being shown on the drawings.
  3. It is essential to use the plans and details in conjunction with the specifications and notes.
  4. Do not scale drawings. Work to dimensions only.
  5. Protect all existing and retained vegetation for the duration of construction according to the contract details and specifications.
  6. Reinstatement all areas and items damaged or disturbed, beyond the Limit of Work, because of construction activities, including but not limited to construction staging areas, haul roads, stockpile areas, etc. to the satisfaction of the Consultant. Unless otherwise noted, Contractor is to reinstate all areas to pre-construction condition or better to the satisfaction of the Contract Administrator.

- PLANTING**
1. Plant material to be No. 1 Grade and is to comply with Canadian Standards for Nursery Stock (latest edition) published by the Canadian Nursery Landscape Association. Use structurally sound plant material with strong fibrous root system free of diseases, defects, and injuries. Use trees with straight trunks, well and characteristically branched for species. Obtain approval from consultant of plant material at source prior to digging. All trees and shrubs to be container grown, potted, W/B or B/B, as indicated on Plant List. Bare root plants are only acceptable for certain species and as approved by the Landscape Architect.
  2. Plant material substitutions are not permitted without the written approval from the Consultant, with 48 hours notice, prior to shipping plant material.
  3. Plant locations are schematic / approximate only. Contractor is to stake out locations on site for approval by the Landscape Architect prior to installation.
  4. The illustrated number of plants shown in the Planting Plan supersedes the estimated number in the Plant List. Contractor to report any discrepancies to the Landscape Architect prior to installation. Contractor will assume full responsibility if the Landscape Architect is not notified.
  5. Ensure trees are thoroughly watered following planting. Monitor material and ensure adequate moisture until acceptance.
  6. In heavy clay or poorly drained soils, set root ball with root collar 75-100mm higher than finished grade.
  7. Approved topsoil depths are as follows:
    - a. Plant Beds - 450mm continuous depth. Applies to shrubs, perennials, vines, and groundcovers.
    - b. Sod Seed Areas - 100mm depth.
    - c. Reforestation - 300mm depth.
  8. Sod to be No. 1 Kentucky Bluegrass Sod grown from minimum mixture of 3 Kentucky Bluegrass cultivars. Quality and source are to comply with Canadian Standards for Nursery Stock, Section 17, (latest edition) published by the Canadian Nursery Landscape Nursery Landscape Association.
  9. Apply the following mineral fertilizer unless soil tests show other requirements:
    - a. Plant Beds - (8-32-16), i.e. 8% Nitrogen, 32% Phosphorus, 16% Potash per manufacturer specifications.
    - b. Sod Areas - (8-32-16), i.e. 8% Nitrogen, 32% Phosphorus, 16% Potash at a rate of 350kg/ha.
  10. Where applicable, for any plant areas with a mix of species/cultivars notes, Contractor is to cluster like plants in groups of 3-5 and evenly distribute these in the noted area.

**PLANT LIST (PRELIMINARY)**

KEY	QTY	BOTANICAL NAME	COMMON NAME	SIZE	COND	SPACING
<b>Coniferous Trees</b>						
ABC	5	<i>Abies concolor</i>	White Fir	200cm Ht	WB	As Shown
LL	3	<i>Larix laricina</i>	Tamarack	200cm Ht	WB	As Shown
PAB	6	<i>Picea abies</i>	Norway Spruce	200cm Ht	WB	As Shown
PG	11	<i>Picea glauca</i>	White Spruce	200cm Ht	WB	As Shown
PP	5	<i>Picea pungens</i>	Colorado Spruce	200cm Ht	WB	As Shown
PNS	12	<i>Pinus strobus</i>	Eastern White Pine	200cm Ht	WB	As Shown
<b>Deciduous Trees</b>						
AR	13	<i>Acer rubrum</i>	Red Maple	50mm Cal	WB	As Shown
ASB	6	<i>Acer saccharum</i> 'Barnett Cole'	Asiatic Sugar Maple	50mm Cal	WB	As Shown
AFS	8	<i>Acer x freemanii</i> 'Spartan'	Spartan Glen Maple	50mm Cal	WB	As Shown
CO	5	<i>Carya ovata</i>	Shagbark Hickory	50mm Cal	WB	As Shown
CEL	6	<i>Celtis occidentalis</i>	Hickberry	50mm Cal	WB	As Shown
CLU	7	<i>Cladrastis kentuckea</i> (formerly 'lutea')	Yellowwood	50mm Cal	WB	As Shown
CRC	6	<i>Crataegus crus-galli</i> 'Inermis'	Thornless Cockspur Hawthorn	50mm Cal	WB	As Shown
GB	12	<i>Ginkgo biloba</i>	Ginkgo (Male)	50mm Cal	WB	As Shown
GTS	8	<i>Gleditsia triacanthos</i> var. <i>inermis</i> 'Shademaster'	Shademaster Honeylocust	50mm Cal	WB	As Shown
GYE	8	<i>Gymnocladus dioica</i> 'Espresso-JFS'	Espresso Kentucky Coffee Tree	50mm Cal	WB	As Shown
NSW	6	<i>Nyssa sylvatica</i> 'Widitree'	Wildtree Black Gum	50mm Cal	WB	As Shown
QA	7	<i>Quercus alba</i>	White Oak	50mm Cal	WB	As Shown
QR	10	<i>Quercus rubra</i>	Red Oak	50mm Cal	WB	As Shown
TA	8	<i>Tilia americana</i>	Basswood	50mm Cal	WB	As Shown
UAV	7	<i>Ulmus americana</i> 'Valley Forge'	Valley Forge Elm	50mm Cal	WB	As Shown

NOTE: THE POSITION OF ALL POLE LINES, CONDUITS, WATERMANS, SEWERS AND OTHER UNDERGROUND AND OVERGROUND UTILITIES AND STRUCTURES IS NOT NECESSARILY SHOWN ON THE CONTRACT DRAWINGS, AND WHERE SHOWN, THE ACCURACY OF THE POSITION OF SUCH UTILITIES AND STRUCTURES IS NOT GUARANTEED. BEFORE STARTING WORK, DETERMINE THE EXACT LOCATION OF ALL SUCH UTILITIES AND STRUCTURES AND ASSUME ALL LIABILITY FOR DAMAGE TO THEM.

**NOT FOR CONSTRUCTION**

SCALE		FOR REVIEW ONLY	
1:500		MUT	
1:500		RGJ	
0 5 10 15 20		MUT	
		RGJ	
		RGJ	
1 ISSUED FOR SITE PLAN APPLICATION		OCT 29/24	
REVISION		DATE	
		BY	



**NOVATECH**  
 Engineers, Planners & Landscape Architects  
 Suite 200, 240 Michael Copeland Drive  
 Ottawa, Ontario, Canada K2M 1P6  
 Telephone: (613) 254-9643  
 Facsimile: (613) 254-5867  
 Website: www.novatech-eng.com

LOCATION CITY OF OTTAWA 99 BILL LEATHAM, 2 & 20 LEIKEN DRIVE	PROJECT NO. 124123
DRAWING NAME LANDSCAPE PLAN	REV # 1
	DRAWING NO. 124123-L1



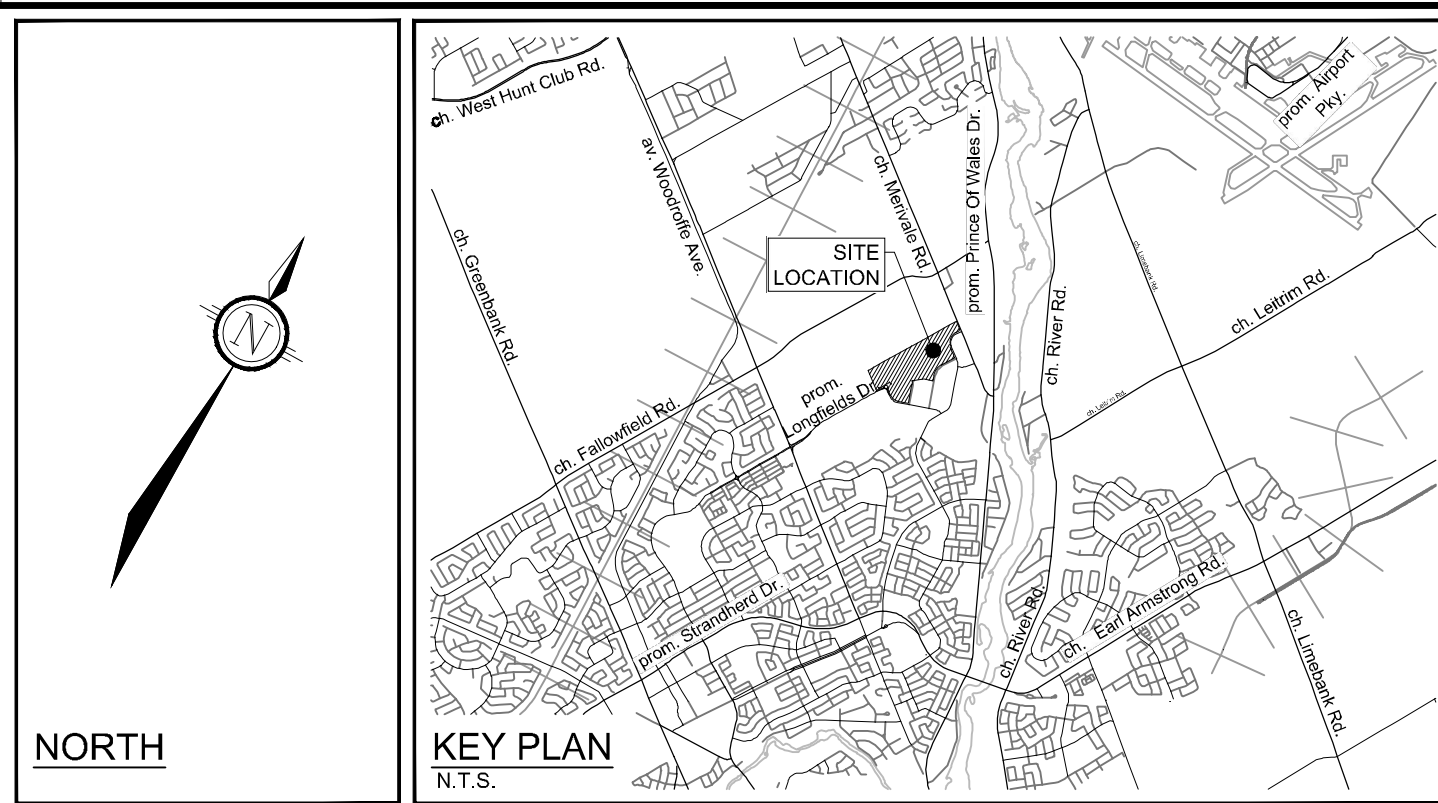
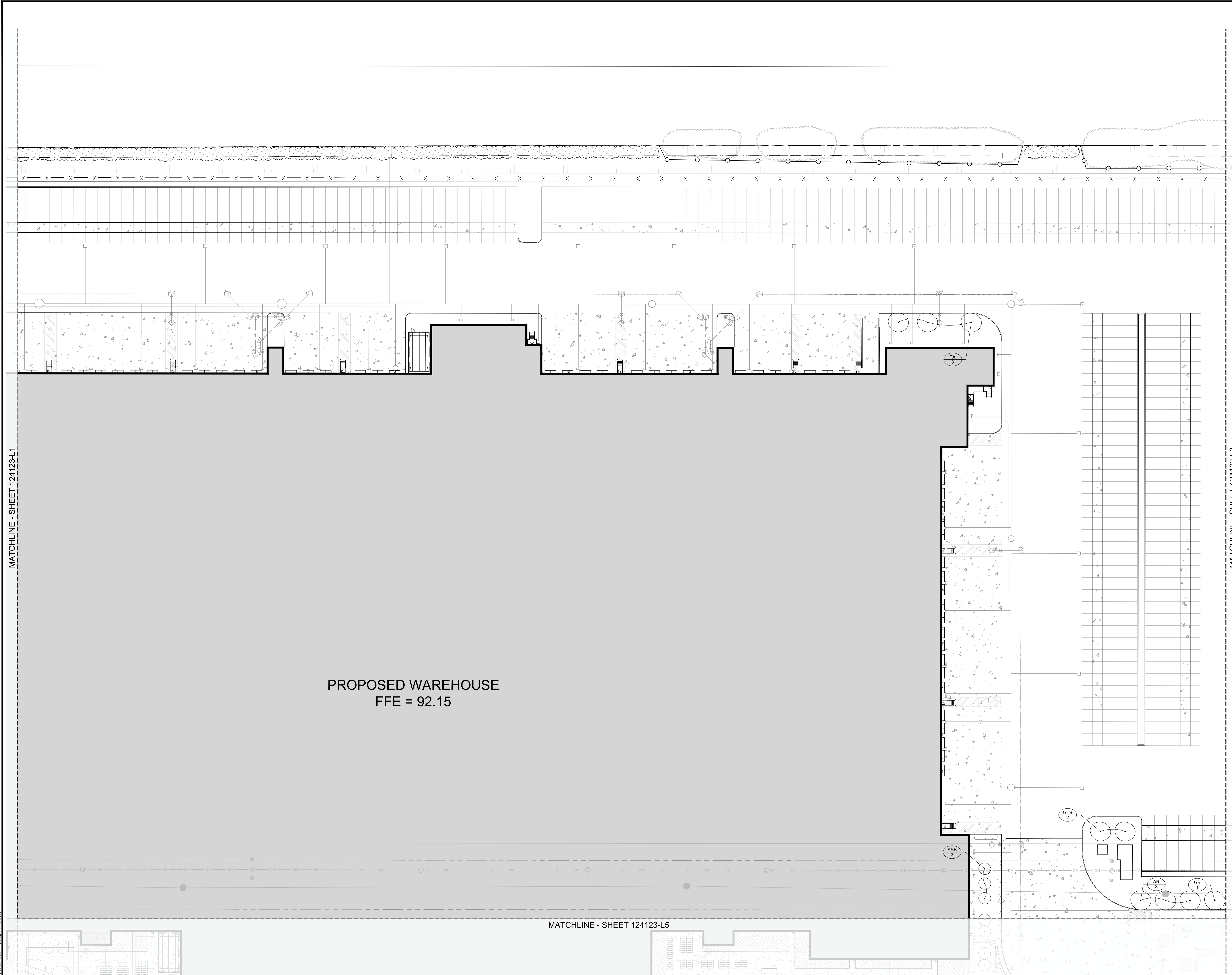

**LEGEND**

- 3-D1 DETAIL SHEET # NOVATECH OR CITY  
EG. L1, L2, ETC. - DETAIL NUMBER SEE LIST FOR CODE
- PROPERTY LIMIT
- PROPOSED CONCRETE
- SHRUBS AND PERENNIALS - TREE COMPANION PLANTING
- SHRUBS AND PERENNIALS
- REFORESTATION AREA
- PROPOSED DECIDUOUS TREE
- PROPOSED CONIFEROUS TREE
- EXISTING TREE TO REMAIN
- EXISTING TREE TO REMOVE
- PROPOSED SHRUBS
- SPECIES (SEE PLANT LIST)
- KEY ## QUANTITY
- PROPOSED CHAINLINK FENCE 1.5m HT

**GENERAL**

1. Read and interpret this drawing set in conjunction with all the contract details and specifications, including related civil, utility, structural, architectural, mechanical, electrical, environmental, geotechnical, and survey information.
2. The Contractor is to determine the exact location, size, material, and elevation of all existing utilities prior to commencing construction. Protect and assume responsibility for all existing utilities regardless of being shown on the drawings.
3. It is essential to use the plans and details in conjunction with the specifications and notes.
4. Do not scale drawings. Work to dimensions only.
5. Protect all existing and retained vegetation for the duration of construction according to the contract details and specifications.
6. Reinststate all areas and items damaged or disturbed, beyond the Limit of Work, because of construction activities, including but not limited to construction staging areas, haul roads, stockpile areas, etc. to the satisfaction of the Consultant. Unless otherwise noted, Contractor is to reinststate all areas to pre-construction condition or better to the satisfaction of the Contract Administrator.

**PLANTING**

1. Plant material to be No. 1 Grade and is to comply with Canadian Standards for Nursery Stock (latest edition) published by the Canadian Nursery Landscape Association. Use structurally sound plant material with strong fibrous root system free of diseases, defects, and injuries. Use trees with straight trunks, well and characteristically branched for species. Obtain approval from consultant of plant material at source prior to digging. All trees and shrubs to be container grown, potted, W/B or B/B, as indicated on Plant List. Bare root plants are only acceptable for certain species and as approved by the Landscape Architect.
2. Plant material substitutions are not permitted without the written approval from the Consultant, with 48 hours notice, prior to shipping plant material.
3. Plant locations are schematic / approximate only. Contractor is to stake out locations on site for approval by the Landscape Architect prior to installation.
4. The illustrated number of plants shown in the Planting Plan supersedes the estimated number in the Plant List. Contractor to report any discrepancies to the Landscape Architect prior to installation. Contractor will assume full responsibility if the Landscape Architect is not notified.
5. Ensure trees are thoroughly watered following planting. Monitor material and ensure adequate moisture until acceptance.
6. In heavy clay or poorly drained soils, set root ball with root collar 75-100mm higher than finished grade.
7. Approved topsoil depths are as follows:
  - a. Plant Beds - 450mm continuous depth. Applies to shrubs, perennials, vines, and groundcovers.
  - b. Sod Seed Areas - 100mm depth.
  - c. Reforestation - 300mm depth.
8. Sod to be No. 1 Kentucky Bluegrass Sod from minimum mixture of 3 Kentucky Bluegrass cultivars. Quality and source are to comply with Canadian Standards for Nursery Stock, Section 17, (latest edition) published by the Canadian Nursery Landscape Nursery Landscape Association.
  - a. Plant Beds - (8-32-16), i.e. 8% Nitrogen, 32% Phosphorus, 16% Potash per manufacturer specifications.
  - b. Sod Areas - (8-32-16), i.e. 8% Nitrogen, 32% Phosphorus, 16% Potash at a rate of 350kg/ha.
9. Where applicable, for any plant areas with a mix of species/cultivars notes, Contractor is to cluster like plants in groups of 3-5 and evenly distribute these in the noted area.

PROPOSED WAREHOUSE  
FFE = 92.15

**PLANT LIST (PRELIMINARY)**

KEY	QTY	BOTANICAL NAME	COMMON NAME	SIZE	COND	SPACING
<b>Deciduous Trees</b>						
AR	3	<i>Acer rubrum</i>	Red Maple	50mm Cal	WB	As Shown
ASB	3	<i>Acer saccharum</i> 'Barrett Cole'	Apollo Sugar Maple	50mm Cal	WB	As Shown
GB	1	<i>Ginkgo biloba</i>	Ginkgo (Male)	50mm Cal	WB	As Shown
GTS	2	<i>Gleditsia triacanthos</i> var. <i>inermis</i> 'Shademaster'	Shademaster Honeylocust	50mm Cal	WB	As Shown
TA	3	<i>Tilia americana</i>	Basswood	50mm Cal	WB	As Shown

NOTE:  
THE POSITION OF ALL POLE LINES, CONDUITS, WATERMANS, SEWERS AND OTHER UNDERGROUND AND OVERGROUND UTILITIES AND STRUCTURES IS NOT NECESSARILY SHOWN ON THE CONTRACT DRAWINGS, AND WHERE SHOWN, THE ACCURACY OF THE POSITION OF SUCH UTILITIES AND STRUCTURES IS NOT GUARANTEED. BEFORE STARTING WORK, DETERMINE THE EXACT LOCATION OF ALL SUCH UTILITIES AND STRUCTURES AND ASSUME ALL LIABILITY FOR DAMAGE TO THEM.

**NOT FOR CONSTRUCTION**

No.	REVISION	DATE	BY
1	ISSUED FOR SITE PLAN APPLICATION	OCT 29/24	RGJ

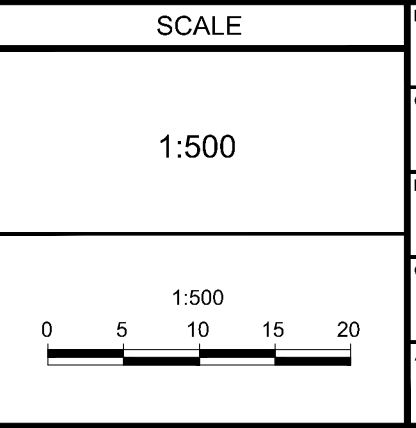

FOR REVIEW ONLY
DESIGN: MJT
CHECKED: RGJ
DRAWN: MJT
CHECKED: RGJ
APPROVED: RGJ



**NOVATECH**  
Engineers, Planners & Landscape Architects  
Suite 200, 240 Michael Copeland Drive  
Ottawa, Ontario, Canada K2M 1P6  
Telephone: (613) 254-9643  
Facsimile: (613) 254-5867  
Website: www.novatech-eng.com

LOCATION CITY OF OTTAWA 99 BILL LEATHAM, 2 & 20 LEIKEN DRIVE	PROJECT NO. 124123
DRAWING NAME LANDSCAPE PLAN	REV # 1
	DRAWING NO. 124123-L2

C:\Users\mrbrown\Documents\124123-L2.dwg 1:2 Oct 29 2024 3:28pm mrbrown



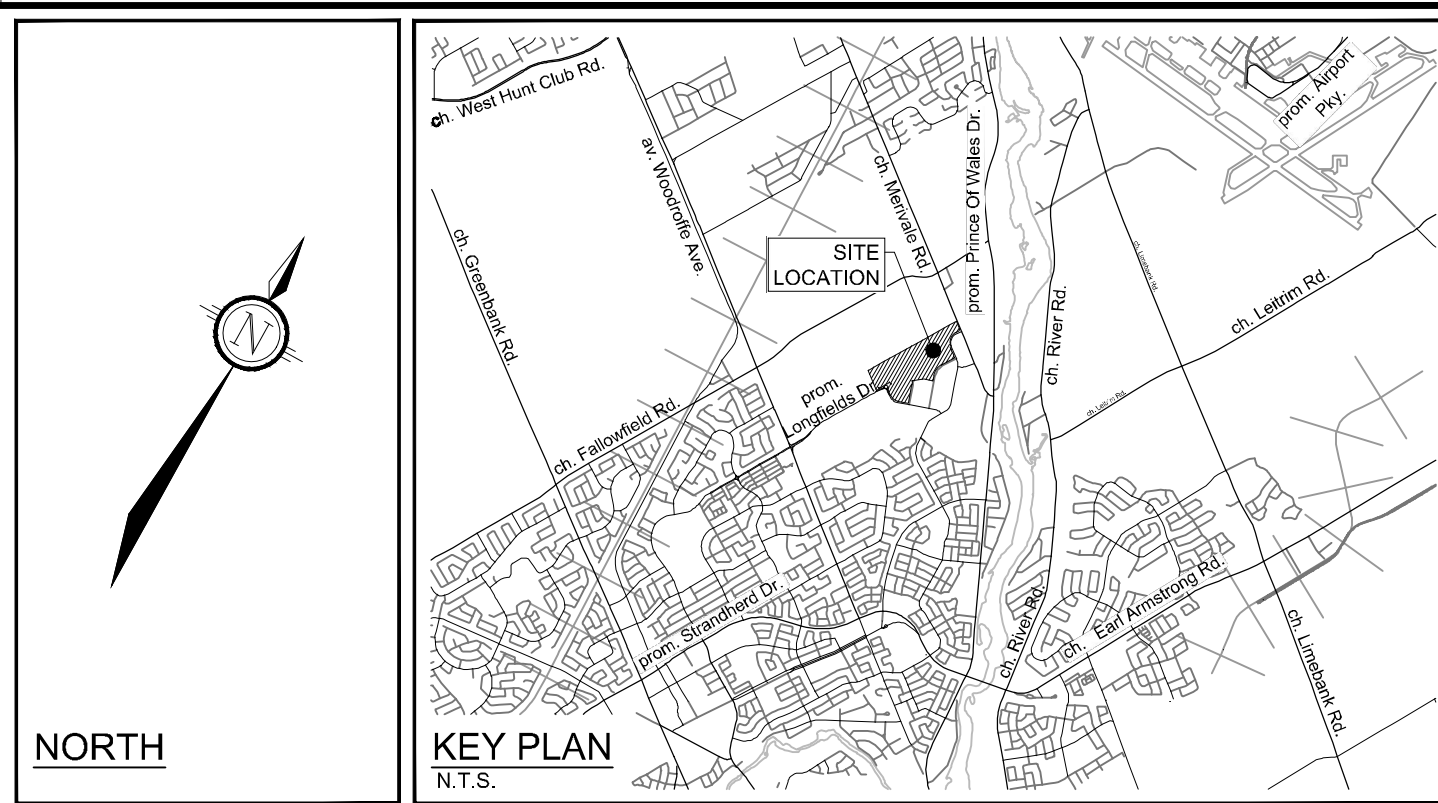
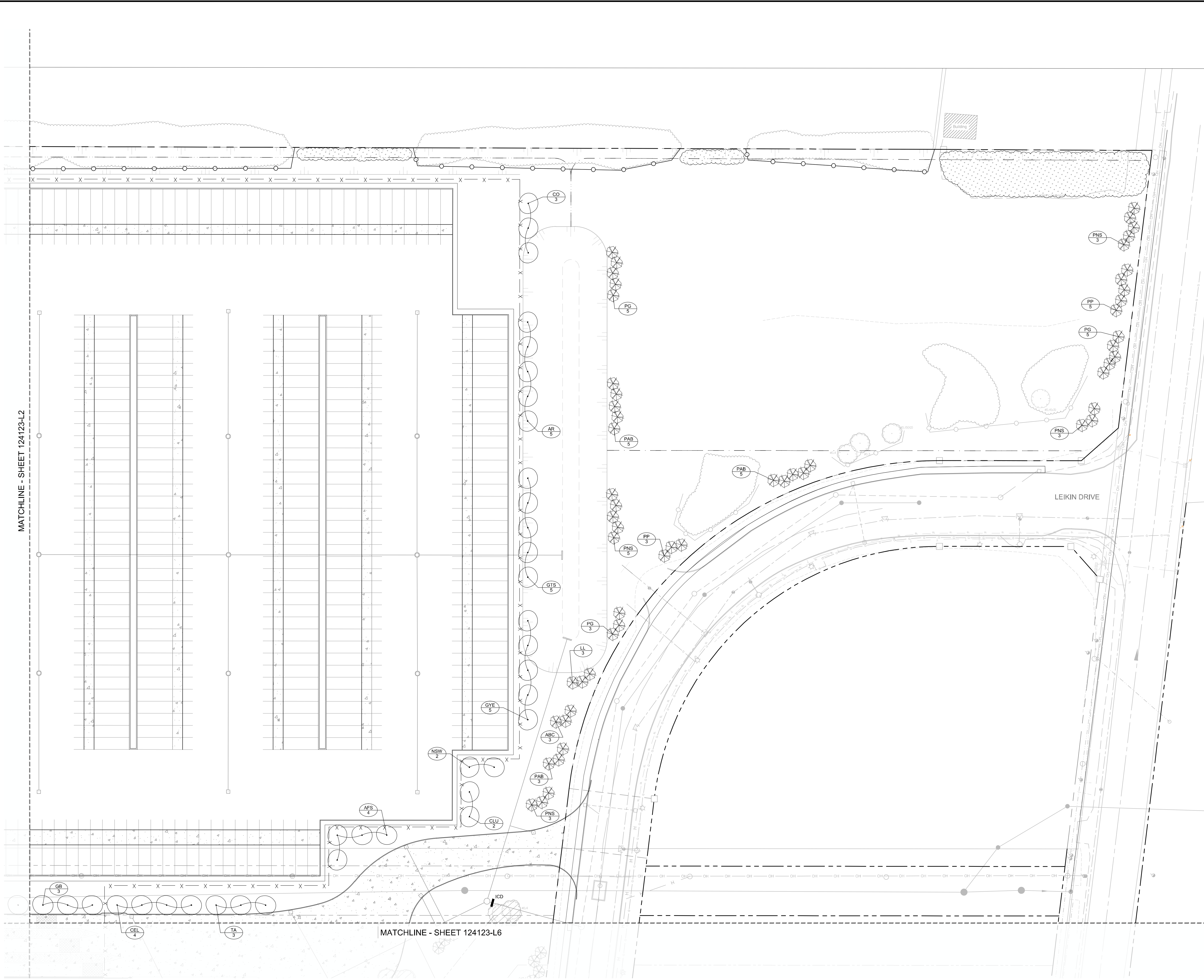

**LEGEND**

- 3-D1 DETAIL SHEET # NOVATECH OR CITY DETAIL NUMBER SEE LIST FOR CODE
- PROPERTY LIMIT
- PROPOSED CONCRETE
- SHRUBS AND PERENNIALS - TREE COMPANION PLANTING
- SHRUBS AND PERENNIALS
- REFORESTATION AREA
- PROPOSED DECIDUOUS TREE
- PROPOSED CONIFEROUS TREE
- EXISTING TREE TO REMAIN
- EXISTING TREE TO REMOVE
- PROPOSED SHRUBS
- SPECIES (SEE PLANT LIST)
- KEY ## QUANTITY
- PROPOSED CHAINLINK FENCE 1.5m HT

**GENERAL**

1. Read and interpret this drawing/ drawing set in conjunction with all the contract details and specifications, including related civil, structural, architectural, mechanical, electrical, environmental, geotechnical, and survey information.
2. The Contractor is to determine the exact location, size, material, and elevation of all existing utilities prior to commencing construction. Protect and assume responsibility for all existing utilities regardless of being shown on the drawings.
3. It is essential to use the plans and details in conjunction with the specifications and notes.
4. Do not scale drawings. Work to dimensions only.
5. Protect all existing and retained vegetation for the duration of construction according to the contract details and specifications.
6. Reinstatement all areas and items damaged or disturbed, beyond the Limit of Work, because of construction activities, including but not limited to construction staging areas, haul roads, stockpile areas, etc. to the satisfaction of the Consultant. Unless otherwise noted, Contractor is to reinstate all areas to pre-construction condition or better to the satisfaction of the Contract Administrator.

**PLANTING**

1. Plant material to be No. 1 Grade and is to comply with Canadian Standards for Nursery Stock (latest edition) published by the Canadian Nursery Landscape Association. Use structurally sound plant material with strong fibrous root system free of diseases, defects, and injuries. Use trees with straight trunks, well and characteristically branched for species. Obtain approval from consultant of plant material at source prior to digging. All trees and shrubs to be container grown, potted, W/B or B/B, as indicated on Plant List. Bare root plants are only acceptable for certain species and as approved by the Landscape Architect.
2. Plant material substitutions are not permitted without the written approval from the Consultant, with 48 hours notice, prior to shipping plant material.
3. Plant locations are schematic / approximate only. Contractor is to stake out locations on site for approval by the Landscape Architect prior to installation.
4. The illustrated number of plants shown in the Planting Plan supersedes the estimated number in the Plant List. Contractor to report any discrepancies to the Landscape Architect prior to installation. Contractor will assume full responsibility if the Landscape Architect is not notified.
5. Ensure trees are thoroughly watered following planting. Monitor material and ensure adequate moisture until acceptance.
6. In heavy clay or poorly drained soils, set root ball with root collar 75-100mm higher than finished grade.
7. Approved topsoil depths are as follows:
  - a. Plant Beds - 450mm continuous depth. Applies to shrubs, perennials, vines, and groundcovers.
  - b. Sod Seed Areas - 100mm depth.
  - c. Reforestation - 300mm depth.
8. Sod to be No. 1 Kentucky Bluegrass Sod grown from minimum mixture of 3 Kentucky Bluegrass cultivars. Quality and source are to comply with Canadian Standards for Nursery Stock, Section 17, (latest edition) published by the Canadian Nursery Landscape Nursery Landscape Association.
9. Apply the following mineral fertilizer unless soil tests show other requirements:
  - a. Plant Beds - (8-32-16), i.e. 8% Nitrogen, 32% Phosphorus, 16% Potash per manufacturer specifications.
  - b. Sod Areas - (8-32-16), i.e. 8% Nitrogen, 32% Phosphorus, 16% Potash at a rate of 350g/ha.
10. Where applicable, for any plant areas with a mix of species/ cultivars notes, Contractor is to cluster like plants in groups of 3-5 and evenly distribute these in the noted area.

**PLANT LIST (PRELIMINARY)**

KEY	QTY	BOTANICAL NAME	COMMON NAME	SIZE	COND	SPACING
<b>Coniferous Trees</b>						
ABC	6	<i>Abies concolor</i>	White Fir	200cm Ht	WB	As Shown
LL	6	<i>Larix laricina</i>	Tamarack	200cm Ht	WB	As Shown
PAB	18	<i>Picea abies</i>	Norway Spruce	200cm Ht	WB	As Shown
PG	18	<i>Picea glauca</i>	White Spruce	200cm Ht	WB	As Shown
PP	11	<i>Picea pungens</i>	Colorado Spruce	200cm Ht	WB	As Shown
PNS	15	<i>Pinus strobus</i>	Eastern White Pine	200cm Ht	WB	As Shown
<b>Deciduous Trees</b>						
AR	5	<i>Acer rubrum</i>	Red Maple	50mm Cal	WB	As Shown
AFS	4	<i>Acer x freemanii 'Senna'</i>	Senna Glen Maple	50mm Cal	WB	As Shown
CO	3	<i>Carpa ovata</i>	Shagbark Hickory	50mm Cal	WB	As Shown
CEL	4	<i>Celtis occidentalis</i>	Hickberry	50mm Cal	WB	As Shown
CLU	2	<i>Cladrasia kentuckea (formerly 'lutea')</i>	Yellowwood	50mm Cal	WB	As Shown
GB	3	<i>Ginkgo biloba</i>	Ginkgo (Mile)	50mm Cal	WB	As Shown
GTS	5	<i>Gleditsia triacanthos var. inermis 'Shademaster'</i>	Shademaster Honeylocust	50mm Cal	WB	As Shown
GYE	5	<i>Gymnocladus dioica 'Espresso-JFS'</i>	Espresso Kentucky Coffee Tree	50mm Cal	WB	As Shown
NSW	3	<i>Nyssa sylvatica 'Wildfire'</i>	Wildfire Black Gum	50mm Cal	WB	As Shown
TA	3	<i>Tilia americana</i>	Basswood	50mm Cal	WB	As Shown

NOTE:  
THE POSITION OF ALL POLE LINES, CONDUITS, WATERMANS, SEWERS AND OTHER UNDERGROUND AND OVERGROUND UTILITIES AND STRUCTURES IS NOT NECESSARILY SHOWN ON THE CONTRACT DRAWINGS, AND WHERE SHOWN, THE ACCURACY OF THE POSITION OF SUCH UTILITIES AND STRUCTURES IS NOT GUARANTEED. BEFORE STARTING WORK, DETERMINE THE EXACT LOCATION OF ALL SUCH UTILITIES AND STRUCTURES AND ASSUME ALL LIABILITY FOR DAMAGE TO THEM.

**NOT FOR CONSTRUCTION**

No.	REVISION	DATE	BY
1	ISSUED FOR SITE PLAN APPLICATION	OCT 29/24	RGJ

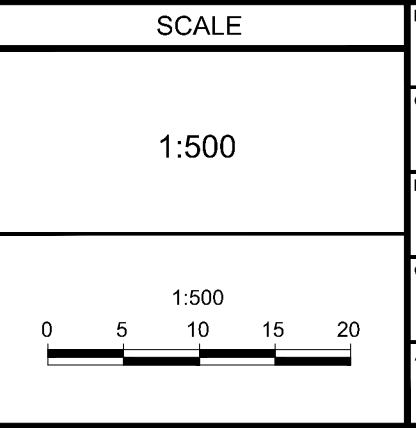

FOR REVIEW ONLY
DESIGN: MJT
CHECKED: RGJ
DRAWN: MJT
CHECKED: RGJ
APPROVED: RGJ



**NOVATECH**  
Engineers, Planners & Landscape Architects  
Suite 200, 240 Michael Cowpland Drive  
Ottawa, Ontario, Canada K2M 1P6  
Telephone: (613) 254-9643  
Facsimile: (613) 254-5867  
Website: www.novatech-eng.com

LOCATION CITY OF OTTAWA 99 BILL LEATHAM, 2 & 20 LEIKEN DRIVE	PROJECT NO. 124123
DRAWING NAME LANDSCAPE PLAN	REV # 1
	DRAWING NO. 124123-L3



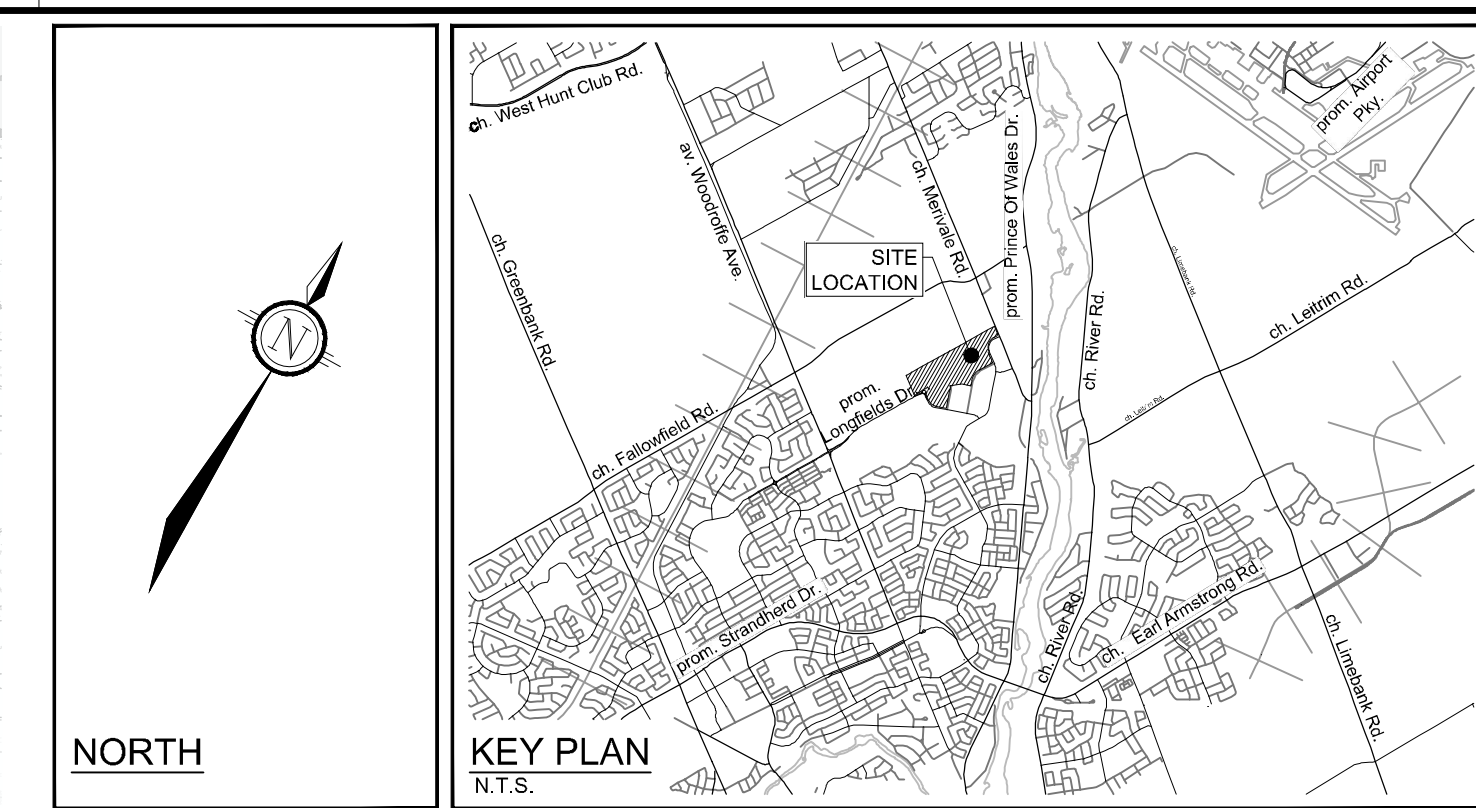
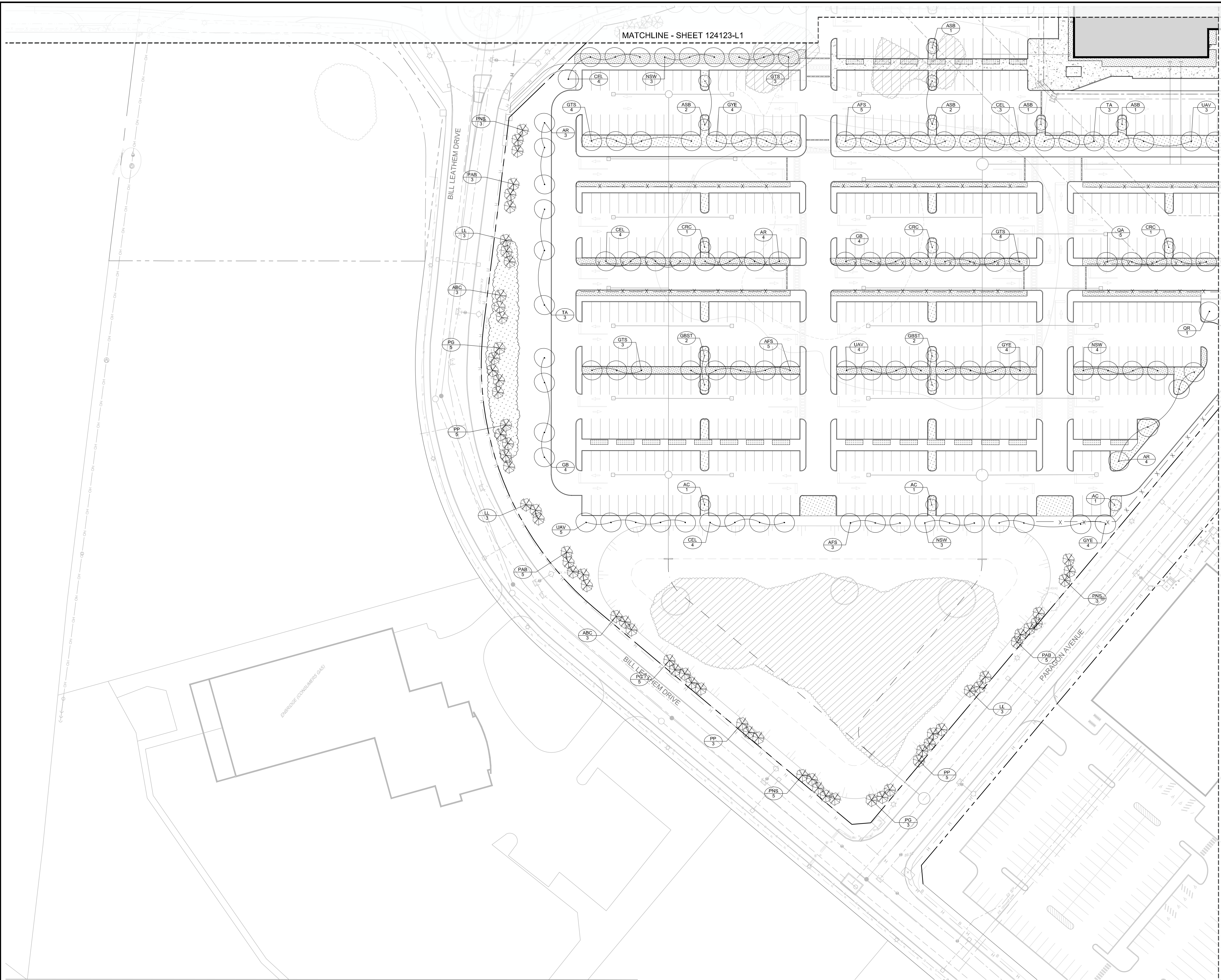

- LEGEND**
- 3-D1 DETAIL SHEET # NOVATECH OR CITY DETAIL NUMBER SEE LIST FOR CODE
  - PROPERTY LIMIT
  - PROPOSED CONCRETE
  - SHRUBS AND PERENNIALS - TREE COMPANION PLANTING
  - SHRUBS AND PERENNIALS
  - REFORESTATION AREA
  - PROPOSED DECIDUOUS TREE
  - PROPOSED CONIFEROUS TREE
  - EXISTING TREE TO REMAIN
  - EXISTING TREE TO REMOVE
  - PROPOSED SHRUBS
  - SPECIES (SEE PLANT LIST)
  - KEY ## QUANTITY
  - PROPOSED CHAINLINK FENCE 1.5m HT

- GENERAL**
1. Read and interpret this drawing/ drawing set in conjunction with all the contract details and specifications, including related civil, utility, structural, architectural, mechanical, electrical, environmental, geotechnical, and survey information.
  2. The Contractor is to determine the exact location, size, material, and elevation of all existing utilities prior to commencing construction. Protect and assume responsibility for all existing utilities regardless of being shown on the drawings.
  3. It is essential to use the plans and details in conjunction with the specifications and notes.
  4. Do not scale drawings. Work to dimensions only.
  5. Protect all existing and retained vegetation for the duration of construction according to the contract details and specifications.
  6. Reinstatement all areas and items damaged or disturbed, beyond the Limit of Work, because of construction activities, including but not limited to construction staging areas, haul roads, stockpile areas, etc. to the satisfaction of the Consultant. Unless otherwise noted, Contractor is to reinstate all areas to pre-construction condition or better to the satisfaction of the Contract Administrator.
- PLANTING**
1. Plant material to be No. 1 Grade and is to comply with Canadian Standards for Nursery Stock (latest edition) published by the Canadian Nursery Landscape Association. Use structurally sound plant material with strong fibrous root system free of diseases, defects, and injuries. Use trees with straight trunks, well and characteristically branched for species. Obtain approval from consultant of plant material at source prior to digging. All trees and shrubs to be container grown, potted, W/B or B/B, as indicated on Plant List. Bare root plants are only acceptable for certain species and as approved by the Landscape Architect.
  2. Plant material substitutions are not permitted without the written approval from the Consultant, with 48 hours notice, prior to shipping plant material.
  3. Plant locations are schematic / approximate only. Contractor is to stake out locations on site for approval by the Landscape Architect prior to installation.
  4. The illustrated number of plants shown in the Planting Plan supersedes the estimated number in the Plant List. Contractor to report any discrepancies to the Landscape Architect prior to installation. Contractor will assume full responsibility if the Landscape Architect is not notified.
  5. Ensure trees are thoroughly watered following planting. Monitor material and ensure adequate moisture until acceptance.
  6. In heavy clay or poorly drained soils, set root ball with root collar 75-100mm higher than finished grade.
  7. Approved topsoil depths are as follows:
    - a. Plant Beds - 450mm continuous depth. Applies to shrubs, perennials, vines, and groundcovers.
    - b. Sod Seed Areas - 100mm depth.
    - c. Reforestation - 300mm depth.
  8. Sod to be No. 1 Kentucky Bluegrass Sod grown from minimum mixture of 3 Kentucky Bluegrass cultivars. Quality and source are to comply with Canadian Standards for Nursery Stock, Section 17, (latest edition) published by the Canadian Nursery Landscape Nursery Landscape Association.
    - a. Plant Beds - (8-32-16), i.e. 8% Nitrogen, 32% Phosphorus, 16% Potash per manufacturer specifications.
    - b. Sod Areas - (8-32-16), i.e. 8% Nitrogen, 32% Phosphorus, 16% Potash at a rate of 350kg/ha.
  9. Where applicable, for any plant areas with a mix of species/ cultivars notes, Contractor is to cluster like plants in groups of 3-5 and evenly distribute these in the noted area.

**PLANT LIST (PRELIMINARY)**

KEY	QTY	BOTANICAL NAME	COMMON NAME	SIZE	COND	SPACING
<b>Coniferous Trees</b>						
ABC	6	<i>Abies concolor</i>	White Fir	200cm H	WB	As Shown
LL	9	<i>Larix laricina</i>	Tamarack	200cm H	WB	As Shown
PAB	13	<i>Picea abies</i>	Norway Spruce	200cm H	WB	As Shown
PG	13	<i>Picea glauca</i>	White Spruce	200cm H	WB	As Shown
PP	13	<i>Picea pungens</i>	Colorado Spruce	200cm H	WB	As Shown
PNS	11	<i>Pinus strobus</i>	Eastern White Pine	200cm H	WB	As Shown
<b>Deciduous Trees</b>						
AR	8	<i>Acer rubrum</i>	Red Maple	50mm Cal	WB	As Shown
ASB	6	<i>Acer saccharum</i> 'Barnett Cole'	Arcade Sugar Maple	50mm Cal	WB	As Shown
AFS	6	<i>Acer x freemanii</i> 'Spartan'	Sierra Glen Maple	50mm Cal	WB	As Shown
AC	3	<i>Amelanchier canadensis</i> (Single stem)	Shadblow Serviceberry	45mm Cal	WB	As Shown
CEL	10	<i>Celtis occidentalis</i>	Hackberry	50mm Cal	WB	As Shown
CRC	4	<i>Crataegus crus-galli</i> 'Thornless'	Thornless Cockspur Hawthorn	50mm Cal	WB	As Shown
GB	4	<i>Ginkgo biloba</i>	Ginkgo (Male)	50mm Cal	WB	As Shown
GBST	4	<i>Ginkgo biloba</i> 'Sky Tower'	Sky Tower Ginkgo (Male)	200cm 10g	PT	As Shown
GTS	6	<i>Gleditsia triacanthos</i> var. <i>inermis</i> 'Shademaster'	Shademaster Honeylocust	50mm Cal	WB	As Shown
GYE	9	<i>Gymnocladus dioica</i> 'Espresso-JFS'	Espresso Kentucky Coffee Tree	50mm Cal	WB	As Shown
NSW	6	<i>Nyssa sylvatica</i> 'Wildfire'	Wildfire Black Gum	50mm Cal	WB	As Shown
QR	1	<i>Quercus rubra</i>	Red Oak	50mm Cal	WB	As Shown
TA	6	<i>Tilia americana</i>	Basswood	50mm Cal	WB	As Shown
UAV	8	<i>Ulmus americana</i> 'Valley Forge'	Valley Forge Elm	50mm Cal	WB	As Shown

NOTE:  
THE POSITION OF ALL POLE LINES, CONDUITS,  
WATERMANS, SEWERS AND OTHER  
UNDERGROUND AND OVERGROUND UTILITIES AND  
STRUCTURES IS NOT NECESSARILY SHOWN ON  
THE CONTRACT DRAWINGS, AND WHERE SHOWN,  
THE ACCURACY OF THE POSITION OF SUCH  
UTILITIES AND STRUCTURES IS NOT GUARANTEED.  
BEFORE STARTING WORK, DETERMINE THE EXACT  
LOCATION OF ALL SUCH UTILITIES AND  
STRUCTURES AND ASSUME ALL LIABILITY FOR  
DAMAGE TO THEM.

**NOT FOR  
CONSTRUCTION**

SCALE		FOR REVIEW ONLY	
1:500		MJT	
1:500		RGJ	
0 5 10 15 20		MJT	
		RGJ	
		RGJ	
1 ISSUED FOR SITE PLAN APPLICATION		OCT 29/24	
No.		BY	
REVISION		DATE	
		RGJ	

LOCATION  
CITY OF OTTAWA  
99 BILL LEATHEN, 2 & 20 LEIKEN DRIVE

DRAWING NAME  
**LANDSCAPE PLAN**

PROJECT NO. 124123

REV # 1

DRAWING NO. 124123-L4

**NOVATECH**  
Engineers, Planners & Landscape Architects  
Suite 200, 240 Michael Copeland Drive  
Ottawa, Ontario, Canada K2M 1P6  
Telephone (613) 254-9643  
Facsimile (613) 254-5867  
Website www.novatech-eng.com

C:\Users\mroberts\Documents\124123-L4.dwg 1:4 Oct 29 2024 3:28pm mroberts



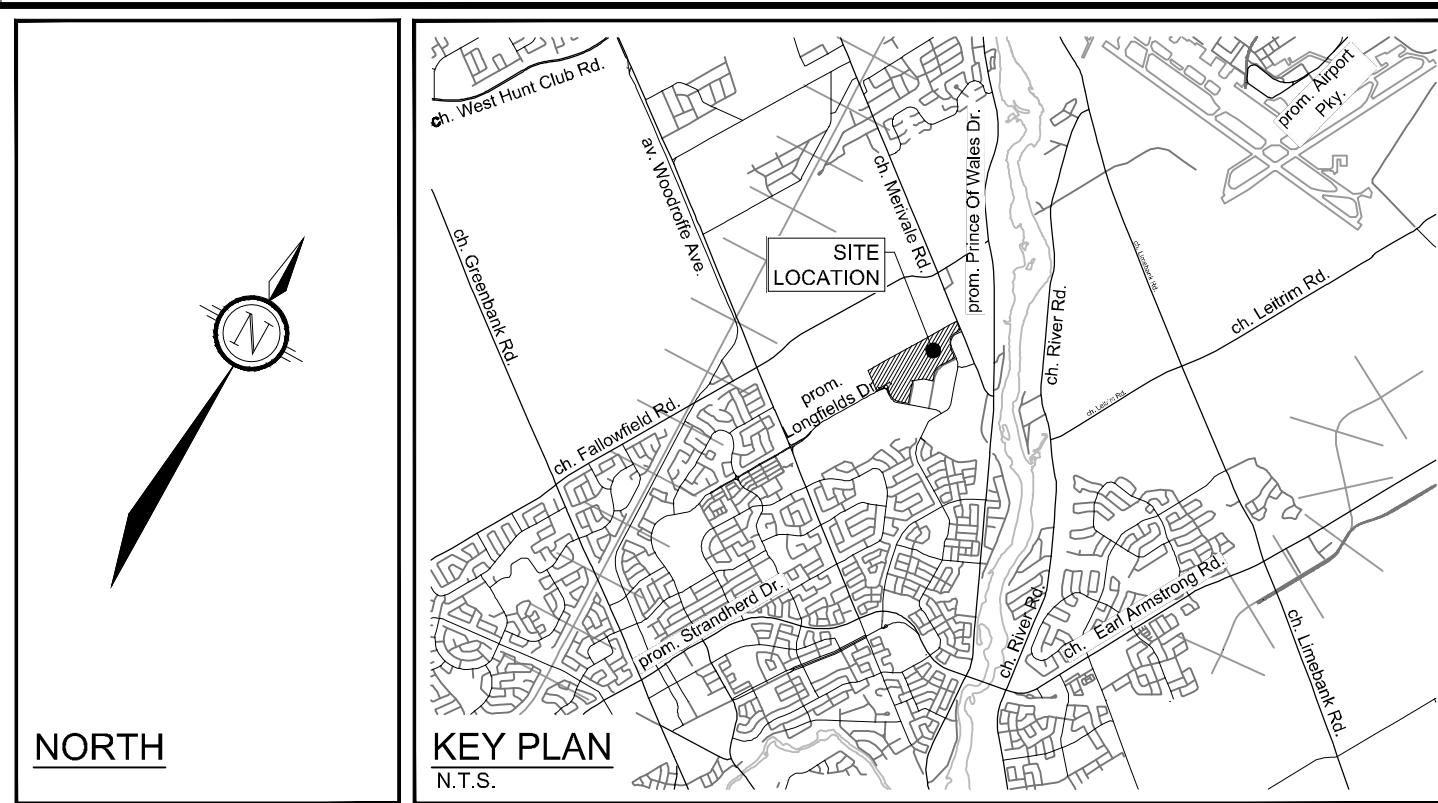
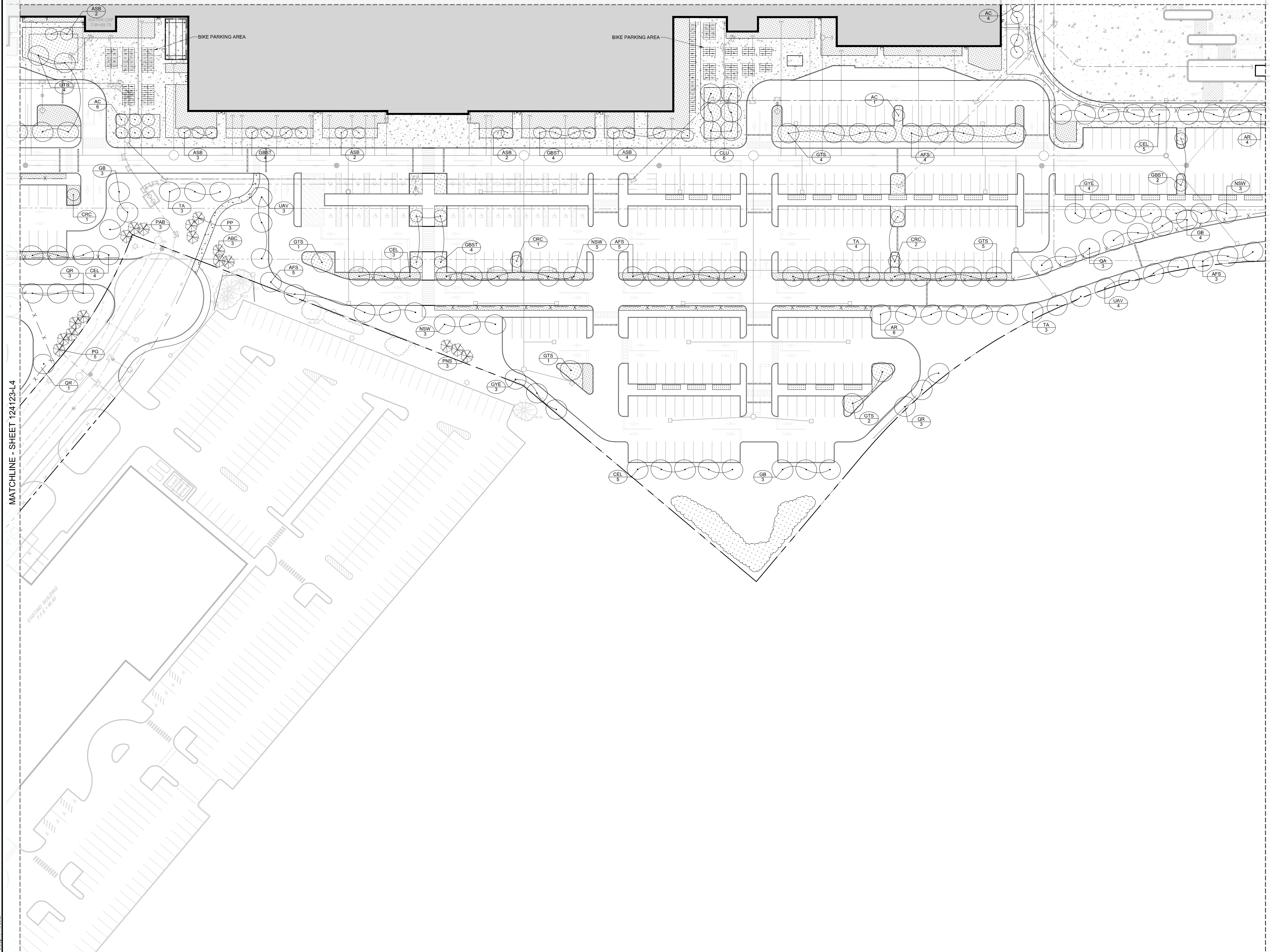

LEGEND

- 3-D1 DETAIL SHEET # NOVATECH OR CITY DETAIL NUMBER SEE LIST FOR CODE
PROPERTY LIMIT
PROPOSED CONCRETE
SHRUBS AND PERENNIALS - TREE COMPANION PLANTING
SHRUBS AND PERENNIALS
REFORESTATION AREA
PROPOSED DECIDUOUS TREE
PROPOSED CONIFEROUS TREE
EXISTING TREE TO REMAIN
EXISTING TREE TO REMOVE
PROPOSED SHRUBS (SEE PLANT LIST)
KEY ## QUANTITY
PROPOSED CHAINLINK FENCE 1.5m HT

GENERAL

- 1. Read and interpret this drawing set in conjunction with all the contract details and specifications, including related civil, utility, structural, architectural, mechanical, electrical, environmental, geotechnical, and survey information.
2. The Contractor is to determine the exact location, size, material, and elevation of all existing utilities prior to commencing construction.
3. It is essential to use the plans and details in conjunction with the specifications and notes.
4. Do not scale drawings. Work to dimensions only.
5. Protect all existing and retained vegetation for the duration of construction according to the contract details and specifications.
6. Reinstatement of all areas and items damaged or disturbed, beyond the Limit of Work, because of construction activities, including but not limited to construction staging areas, haul roads, stockpile areas, etc. to the satisfaction of the Consultant. Unless otherwise noted, Contractor is to reinstatement all areas to pre-construction condition or better to the satisfaction of the Contract Administrator.

PLANTING

- 1. Plant material to be No. 1 Grade and is to comply with Canadian Standards for Nursery Stock (latest edition) published by the Canadian Nursery Landscape Association.
2. Use structurally sound plant material with strong fibrous root system free of diseases, defects, and injuries.
3. Plant material substitutions are not permitted without the written approval from the Consultant, with 48 hours notice, prior to shipping plant material.
4. Plant locations are schematic / approximate only. Contractor is to stake out locations on site for approval by the Landscape Architect prior to installation.
5. The illustrated number of plants shown in the Planting Plan supersedes the estimated number in the Plant List. Contractor to report any discrepancies to the Landscape Architect prior to installation.
6. Ensure trees are thoroughly watered following planting. Monitor material and ensure adequate moisture until acceptance.
7. In heavy clay or poorly drained soils, set root ball with root collar 75-100mm higher than finished grade.
8. Approved topsoil depths are as follows:
a. Plant Beds - 450mm continuous depth. Applies to shrubs, perennials, vines, and groundcovers.
b. Sod Seed Areas - 100mm depth.
c. Reforestation - 300mm depth.
9. Sod to be No. 1 Kentucky Bluegrass Sod grown from minimum mixture of 3 Kentucky Bluegrass cultivars. Quality and source are to comply with Canadian Standards for Nursery Stock, Section 17, (latest edition) published by the Canadian Nursery Landscape Nursery Landscape Association.
10. Apply the following mineral fertilizer unless soil tests show other requirements:
a. Plant Beds - (8-32-16), i.e. 8% Nitrogen, 32% Phosphorus, 16% Potash per manufacturer specifications.
b. Sod Areas - (8-32-16), i.e. 8% Nitrogen, 32% Phosphorus, 16% Potash at a rate of 350kg/ha.
12. Where applicable, for any plant areas with a mix of species/cultivars notes, Contractor is to cluster like plants in groups of 3-5 and evenly distribute these in the noted area.

PLANT LIST (PRELIMINARY)

Table with columns: KEY, QTY, BOTANICAL NAME, COMMON NAME, SIZE, COND, SPACING. Lists various plant species like Acer, Picea, Pinus, etc.

NOTE: THE POSITION OF ALL POLE LINES, CONDUITS, WATERMANS, SEWERS AND OTHER UNDERGROUND AND OVERGROUND UTILITIES AND STRUCTURES IS NOT NECESSARILY SHOWN ON THE CONTRACT DRAWINGS, AND WHERE SHOWN, THE ACCURACY OF THE POSITION OF SUCH UTILITIES AND STRUCTURES IS NOT GUARANTEED. BEFORE STARTING WORK, DETERMINE THE EXACT LOCATION OF ALL SUCH UTILITIES AND STRUCTURES AND ASSUME ALL LIABILITY FOR DAMAGE TO THEM.

NOT FOR CONSTRUCTION

Table with columns: No., REVISION, DATE, BY. Row 1: ISSUED FOR SITE PLAN APPLICATION, OCT 29/24, RGJ.

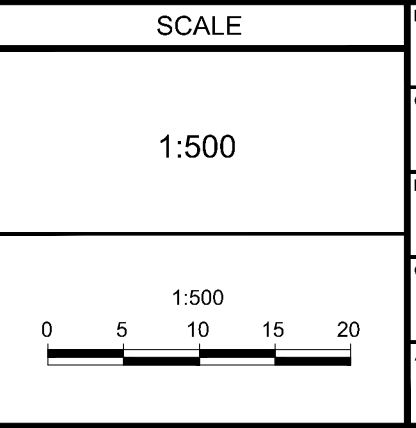

Table for review status: DESIGNED (MJT), CHECKED (RGJ), DRAWN (MJT), CHECKED (RGJ), APPROVED (RGJ).



NOVATECH logo and contact information: Suite 200, 240 Michael Copeland Drive, Ottawa, Ontario, Canada K2M 1P6.

LOCATION: CITY OF OTTAWA, 99 BILL LEATHAM, 2 & 20 LEIKEN DRIVE. DRAWING NAME: LANDSCAPE PLAN. PROJECT No.: 124123. REV # 1. DRAWING No.: 124123-L5.



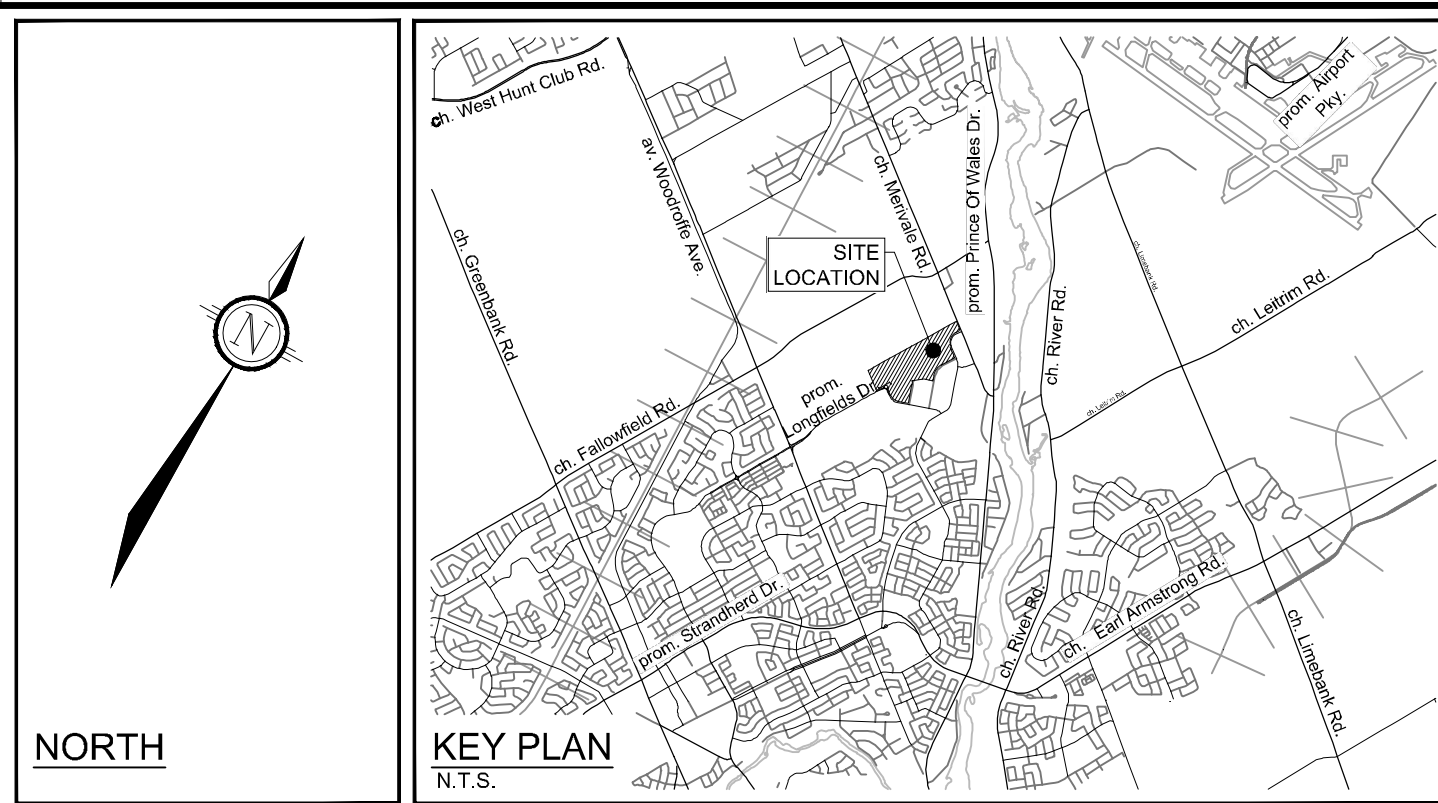
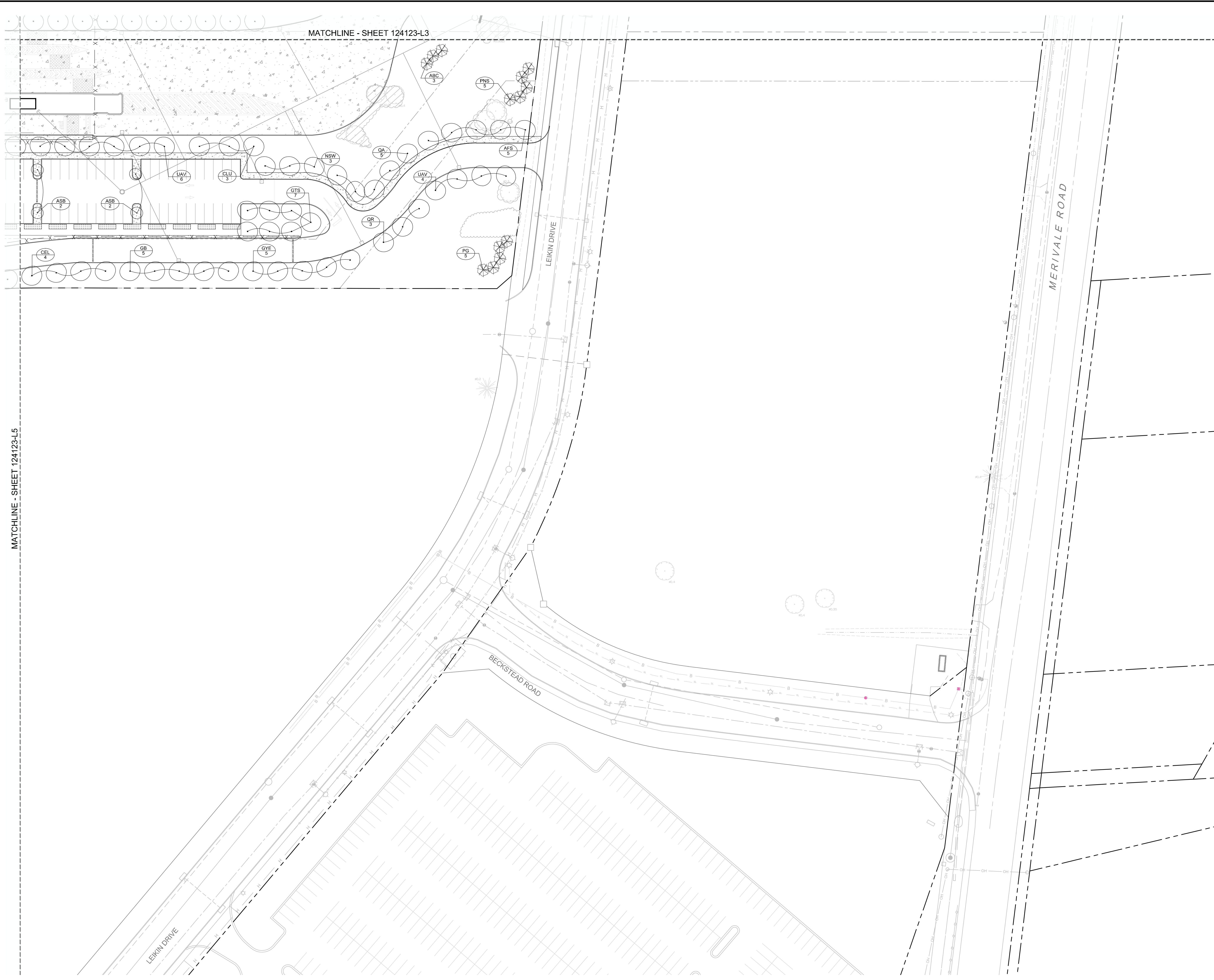

- LEGEND**
- 3-D1 DETAIL SHEET # NOVATECH OR CITY DETAIL NUMBER SEE LIST FOR CODE
  - PROPERTY LIMIT
  - PROPOSED CONCRETE
  - SHRUBS AND PERENNIALS - TREE COMPANION PLANTING
  - SHRUBS AND PERENNIALS
  - REFORESTATION AREA
  - PROPOSED DECIDUOUS TREE
  - PROPOSED CONIFEROUS TREE
  - EXISTING TREE TO REMAIN
  - EXISTING TREE TO REMOVE
  - PROPOSED SHRUBS
  - SPECIES (SEE PLANT LIST)
  - KEY ## QUANTITY
  - PROPOSED CHAINLINK FENCE 1.5m HT

- GENERAL**
- Read and interpret this drawing/drawing set in conjunction with all the contract details and specifications, including related civil, utility, structural, architectural, mechanical, electrical, environmental, geotechnical, and survey information.
  - The Contractor is to determine the exact location, size, material, and elevation of all existing utilities prior to commencing construction. Protect and assume responsibility for all existing utilities regardless of being shown on the drawings.
  - It is essential to use the plans and details in conjunction with the specifications and notes.
  - Do not scale drawings. Work to dimensions only.
  - Protect all existing and retained vegetation for the duration of construction according to the contract details and specifications.
  - Reinstate all areas and items damaged or disturbed, beyond the Limit of Work, because of construction activities, including but not limited to construction staging areas, haul roads, stockpile areas, etc. to the satisfaction of the Consultant. Unless otherwise noted, Contractor is to reinstate all areas to pre-construction condition or better to the satisfaction of the Contract Administrator.

- PLANTING**
- Plant material to be No. 1 Grade and is to comply with Canadian Standards for Nursery Stock (latest edition) published by the Canadian Nursery Landscape Association. Use structurally sound plant material with strong fibrous root system free of diseases, defects, and injuries. Use trees with straight trunks, well and characteristically branched for species. Obtain approval from consultant of plant material at source prior to digging. All trees and shrubs to be container grown, potted, W/B or B/B, as indicated on Plant List. Bare root plants are only acceptable for certain species and as approved by the Landscape Architect.
  - Plant material substitutions are not permitted without the written approval from the Consultant, with 48 hours notice, prior to shipping plant material.
  - Plant locations are schematic / approximate only. Contractor is to stake out locations on site for approval by the Landscape Architect prior to installation.
  - The illustrated number of plants shown in the Planting Plan supersedes the estimated number in the Plant List. Contractor to report any discrepancies to the Landscape Architect prior to installation. Contractor will assume full responsibility if the Landscape Architect is not notified.
  - Ensure trees are thoroughly watered following planting. Monitor material and ensure adequate moisture until acceptance.
  - In heavy clay or poorly drained soils, set root ball with root collar 75-100mm higher than finished grade.
  - Approved topsoil depths are as follows:
    - Plant Beds - 450mm continuous depth. Applies to shrubs, perennials, vines, and groundcovers.
    - Sod Seed Areas - 100mm depth.
    - Reforestation - 300mm depth.
  - Sod to be No. 1 Kentucky Bluegrass Sod grown from minimum mixture of 3 Kentucky Bluegrass cultivars. Quality and source are to comply with Canadian Standards for Nursery Stock, Section 17, (latest edition) published by the Canadian Nursery Landscape Nursery Landscape Association.
    - Plant Beds - (8-32-16), i.e. 8% Nitrogen, 32% Phosphorus, 16% Potash per manufacturer specifications.
    - Sod Areas - (8-32-16), i.e. 8% Nitrogen, 32% Phosphorus, 16% Potash at a rate of 350kg/ha.
  - Where applicable, for any plant areas with a mix of species/cultivars notes, Contractor is to cluster like plants in groups of 3-5 and evenly distribute these in the noted area.

**PLANT LIST (PRELIMINARY)**

KEY	QTY	BOTANICAL NAME	COMMON NAME	SIZE	COND	SPACING
<b>Coniferous Trees</b>						
ABC	3	<i>Abies concolor</i>	White Fir	200cm H	WB	As Shown
PG	5	<i>Picea glauca</i>	White Spruce	200cm H	WB	As Shown
PMS	5	<i>Pinus strobus</i>	Eastern White Pine	200cm H	WB	As Shown
<b>Deciduous Trees</b>						
ASB	2	<i>Acer saccharum 'Barrett Cole'</i>	Apollo Sugar Maple	50mm Cal	WB	As Shown
AFS	5	<i>Acer x freemanii 'Sienna'</i>	Sienna Glen Maple	50mm Cal	WB	As Shown
CEL	3	<i>Celtis occidentalis</i>	Hackberry	50mm Cal	WB	As Shown
CLU	3	<i>Clethra kentuckea (formerly 'lutea')</i>	Yellow wood	50mm Cal	WB	As Shown
GB	5	<i>Ginkgo biloba</i>	Ginkgo (MAE)	50mm Cal	WB	As Shown
GYS	3	<i>Gleditsia inaequalis var. inermis 'Shademaster'</i>	Shademaster Honeylocust	50mm Cal	WB	As Shown
GYS	5	<i>Gymnocladus dioica 'Espresso-JF'</i>	Espresso Kentucky Coffee Tree	50mm Cal	WB	As Shown
NSW	3	<i>Nyssa sylvatica 'Wildfire'</i>	Wildfire Black Gum	50mm Cal	WB	As Shown
QA	4	<i>Quercus alba</i>	White Oak	50mm Cal	WB	As Shown
QR	3	<i>Quercus rubra</i>	Red Oak	50mm Cal	WB	As Shown
UA	8	<i>Ulmus americana 'Valley Forge'</i>	Valley Forge Elm	50mm Cal	WB	As Shown

MATCHLINE - SHEET 124123-L5

MATCHLINE - SHEET 124123-L3

NOTE:  
THE POSITION OF ALL POLE LINES, CONDUITS, WATERMANS, SEWERS AND OTHER UNDERGROUND AND OVERGROUND UTILITIES AND STRUCTURES IS NOT NECESSARILY SHOWN ON THE CONTRACT DRAWINGS, AND WHERE SHOWN, THE ACCURACY OF THE POSITION OF SUCH UTILITIES AND STRUCTURES IS NOT GUARANTEED. BEFORE STARTING WORK, DETERMINE THE EXACT LOCATION OF ALL SUCH UTILITIES AND STRUCTURES AND ASSUME ALL LIABILITY FOR DAMAGE TO THEM.

**NOT FOR CONSTRUCTION**

No.	REVISION	DATE	BY
1	ISSUED FOR SITE PLAN APPLICATION	OCT 29/24	RGJ

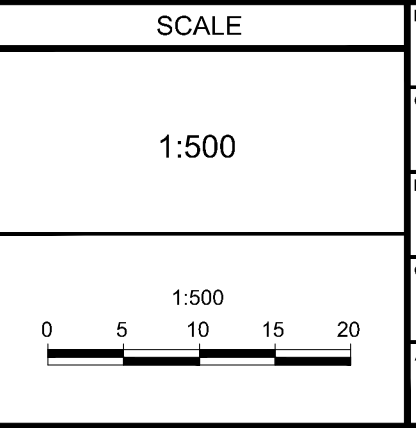

DESIGN	FOR REVIEW ONLY
CHECKED: MJT	
DRAWN: RGJ	
CHECKED: MJT	
APPROVED: RGJ	

**NOVATECH**  
Engineers, Planners & Landscape Architects  
Suite 200, 240 Michael Copeland Drive  
Ottawa, Ontario, Canada K2M 1P6  
Telephone: (613) 254-9643  
Facsimile: (613) 254-5867  
Website: www.novatech-eng.com

LOCATION  
CITY OF OTTAWA  
99 BILL LEATHAM, 2 & 20 LEIKIN DRIVE

DRAWING NAME  
LANDSCAPE PLAN

PROJECT NO.: 124123  
REV # 1  
DRAWING NO.: 124123-L6