

M:\2018\118224\CADD\Design\Medium Density\118224-PR-MD.dwg, PR2, Aug. 15, 2025 - 12:31am, bundle

NOTE:  
THE POSITION OF ALL POLE LINES, CONDUITS,  
WATERMAINS, SEWERS AND OTHER  
UNDERGROUND AND OVERGROUND UTILITIES AND  
STRUCTURES IS NOT NECESSARILY SHOWN ON  
THE CONTRACT DRAWINGS, AND WHERE SHOWN,  
THE ACCURACY OF THE POSITION OF SUCH  
UTILITIES AND STRUCTURES IS NOT GUARANTEED.  
BEFORE STARTING WORK, DETERMINE THE EXACT  
LOCATION OF ALL SUCH UTILITIES AND  
STRUCTURES AND ASSUME ALL LIABILITY FOR  
DAMAGE TO THEM.

No.	REVISION	DATE	BY
3.	REVISED PER CITY COMMENTS	AUG 15/25	MS
2.	REVISED PER CITY COMMENTS	MAR 5/25	MS
1.	ISSUED FOR CITY REVIEW	NOV 1/24	BHB

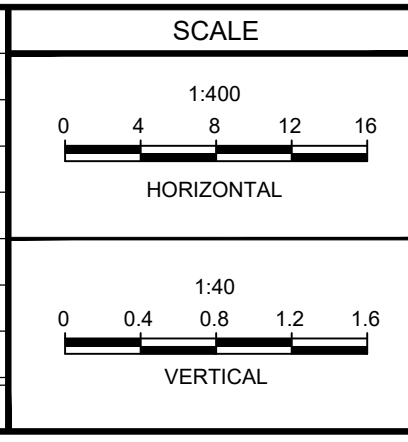

DESIGN	BR
CHECKED	MS
DRAWN	BR
CHECKED	MS
APPROVED	BHB

FOR REVIEW ONLY

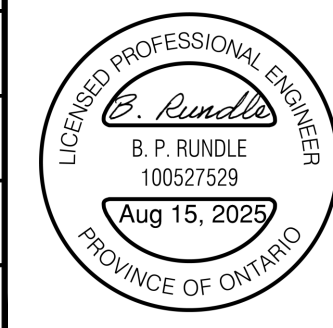

**NOVATECH**  
Engineers, Planners & Landscape Architects  
Suite 200, 240 Michael Cowpland Drive  
Ottawa, Ontario, Canada K2M 1P6  
Telephone (613) 254-9643  
Facsimile (613) 254-5867  
Website www.novatech-eng.com

LOCATION  
CITY OF OTTAWA  
THE COMMONS - MEDIUM DENSITY  
DRAWING NAME  
PLAN AND PROFILE  
STREET 2  
STATION 2+000 TO 2+175

PROJECT No.	118224-MD
REV	REV # 3
DRAWING No.	118224-MD-PR2

D07-12-24-0141

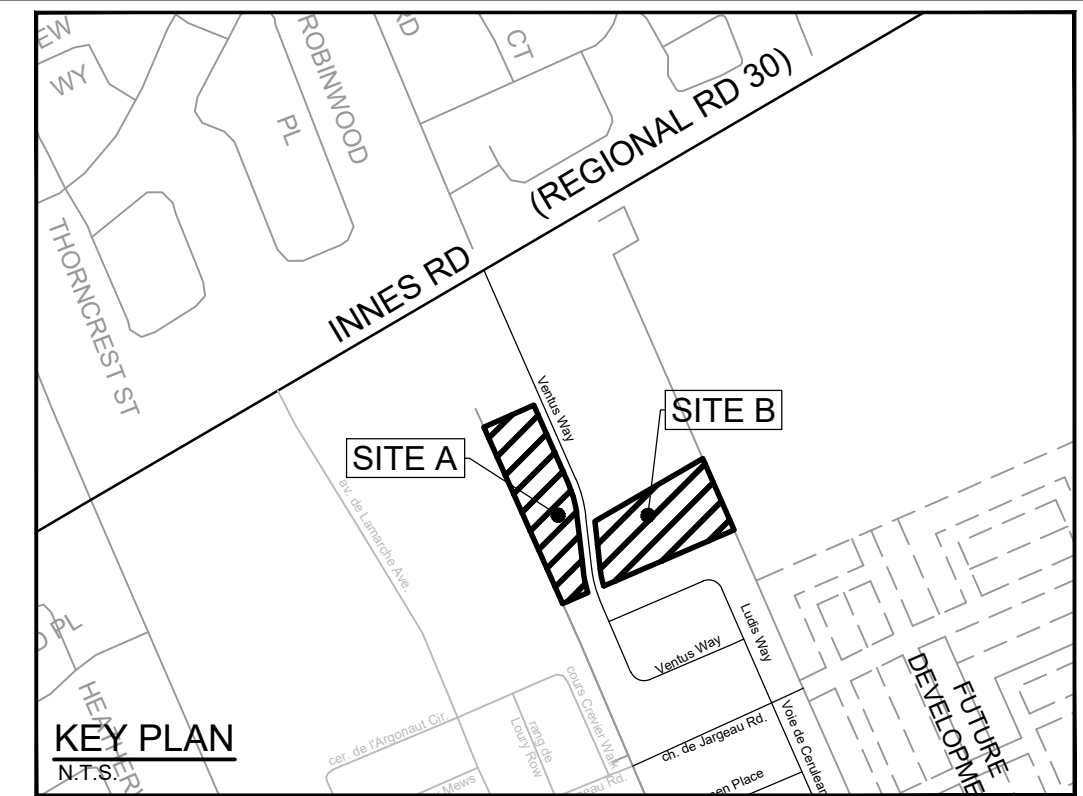
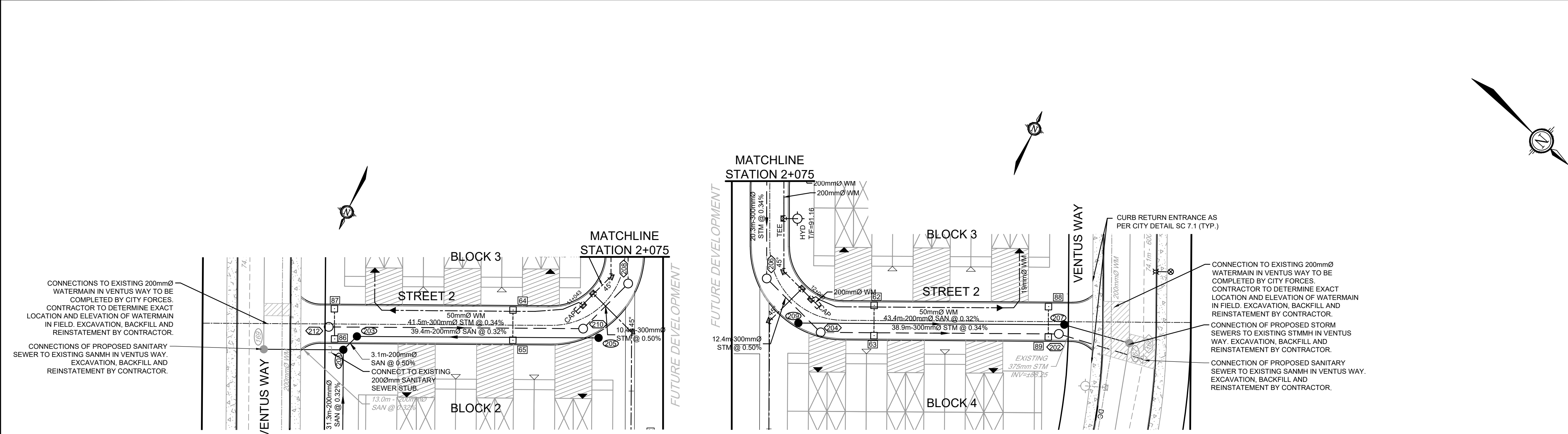

#### LEGEND

200mmØ WM	PROPOSED WATERMAIN
○	PROPOSED VALVE LOCATION
V&VB	VALVE & VALVE BOX
HYD	PROPOSED HYDRANT C/W VALVE & LEAD
TIF=98.45	PROPOSED TOP OF BOTTOM FLANGE
BEND	PROPOSED BEND AND THRUSTBLOCK 11.25', 22.5', 45' or TEE
▶	SERVICE CONNECTION STUB 100mm STORM @ 1.0% 19mm WATER 125mm SANITARY @ 1.0%
▷	SERVICE CONNECTION STUB- COMMON TRENCH 100mm STORM @ 1.0% 19mm WATER 125mm SANITARY @ 1.0%
101	PROPOSED SANITARY MH & SEWER
102	PROPOSED STORM MH & SEWER
CBMH	PROPOSED REAR YARD CATCHBASIN MANHOLE & LEAD
RYCB	PROPOSED REAR YARD CATCHBASIN & LEAD
CB	PROPOSED ROAD CATCHBASIN
▶	DIRECTION OF FLOW
EXISTING 1.8m CONCRETE SIDEWALK	
X X X	EXISTING FENCE - CHAINLINK
REINSTATEMENT FOR DEPRESSED CURBS	
ROADCUT PER CITY OF OTTAWA R10	

NOTE:  
DURING SERVICING, GRADING, AND REINSTATEMENT WORKS, TIE INTO EXISTING  
ELEVATIONS AND ELIMINATE ENCROACHMENT INTO ADJACENT PROPERTY LANDS, WHERE  
POSSIBLE. PERMISSION REQUIRED FOR WORKS ON ADJACENT PROPERTY LANDS. USE  
PROTECTION FENCINGS AND BEST EFFORTS TO REDUCE IMPACT TO ADJACENT LANDS.  
EXISTING FEATURES INCLUDING, BUT NOT LIMITED TO, RETAINING WALLS, FENCES, HARD  
AND SOFT LANDSCAPE. ANY DISTURBED AREA IS TO BE REINSTATED TO EXISTING  
CONDITIONS OR BETTER, TO THE SATISFACTION OF PROPERTY OWNER AND CITY.