

GENERAL NOTES:

- COORDINATE AND SCHEDULE ALL WORK WITH OTHER TRADES AND CONTRACTORS.
- DETERMINE THE EXACT LOCATION, SIZE, MATERIAL AND ELEVATION OF ALL EXISTING UTILITIES PRIOR TO COMMENCING CONSTRUCTION. PROTECT AND ASSUME RESPONSIBILITY FOR ALL EXISTING UTILITIES WHETHER OR NOT SHOWN ON THIS DRAWING.
- OBTAIN ALL NECESSARY PERMITS AND APPROVALS FROM THE CITY OF OTTAWA BEFORE COMMENCING CONSTRUCTION.
- BEFORE COMMENCING CONSTRUCTION OBTAIN AND PROVIDE PROOF OF COMPREHENSIVE, ALL RISK AND OPERATIONAL LIABILITY INSURANCE FOR \$5,000,000.00. INSURANCE POLICY TO NAME OWNERS, ENGINEERS AND ARCHITECTS AS CO-INSURED.
- RESTORE ALL DISTURBED AREAS ON-SITE AND OFF-SITE, INCLUDING TRENCHES AND SURFACES ON PUBLIC ROAD ALLOWANCES TO EXISTING CONDITIONS OR BETTER TO THE SATISFACTION OF THE CITY OF OTTAWA AND ENGINEER.
- REMOVE FROM SITE ALL EXCESS EXCAVATED MATERIAL, ORGANIC MATERIAL AND DEBRIS UNLESS OTHERWISE INSTRUCTED BY ENGINEER. EXCAVATE AND REMOVE FROM SITE ANY CONTAMINATED MATERIAL. ALL CONTAMINATED MATERIAL SHALL BE DISPOSED OF AT A LICENSED LANDFILL FACILITY.
- ALL ELEVATIONS ARE GEODETIC.
- REFER TO THE GEOTECHNICAL INVESTIGATION REPORT (NO. PG4562-1, REV. 6, DATED JANUARY 29, 2024) PREPARED BY PATERSON GROUP INC., FOR SUBSURFACE CONDITIONS, CONSTRUCTION RECOMMENDATIONS, AND GEOTECHNICAL INSPECTION REQUIREMENTS. THE GEOTECHNICAL CONSULTANT IS TO REVIEW ON-SITE CONDITIONS AFTER EXCAVATION PRIOR TO PLACEMENT OF THE GRANULAR MATERIAL.
- REFER TO ARCHITECT'S AND LANDSCAPE ARCHITECT'S DRAWINGS FOR ON-SITE BUILDING AND HARD SURFACE AREAS AND DIMENSIONS.
- SAW CUT AND KEY GRIND ASPHALT AT ALL ROAD CUTS AND ASPHALT TIE IN POINTS AS PER CITY OF OTTAWA STANDARDS (R10).

SEWER NOTES:

- SUPPLY AND CONSTRUCT ALL SEWERS AND APPURTENANCES IN ACCORDANCE WITH THE MOST CURRENT CITY OF OTTAWA STANDARDS AND SPECIFICATIONS.
- SPECIFICATIONS:

ITEM	SPEC. No.	REFERENCE
SANITARY MANHOLE (1200mmØ)	701.010	OPSD
SANITARY MH FRAME & COVER	S24 / S25	CITY OF OTTAWA
WATERTIGHT MH FRAME AND COVER	S24.2	CITY OF OTTAWA
SEWER TRENCH	S6	CITY OF OTTAWA
SANITARY SEWER PIPE	PVC DR 35	CITY OF OTTAWA
- INSULATE ALL PIPES (SAN/STM) THAT HAVE LESS THAN 2.0m COVER WITH HI-40 INSULATION PER INSULATION DETAIL S35. PROVIDE 150mm CLEARANCE BETWEEN PIPE AND INSULATION.
- PIPE BEDDING, COVER AND BACKFILL ARE TO BE COMPACTED TO AT LEAST 95% OF THE STANDARD PROCTOR MAXIMUM DRY DENSITY. THE USE OF CLEAR CRUSHED STONE AS A BEDDING LAYER SHALL NOT BE PERMITTED.
- FLEXIBLE CONNECTIONS ARE REQUIRED FOR CONNECTING PIPES TO MANHOLES (FOR EXAMPLE KOR-N-SEAL, PSX POSITIVE SEAL AND DURASEAL). THE CONCRETE CRADLE FOR THE PIPE CAN BE ELIMINATED.
- THE OWNER SHALL REQUIRE THAT THE SITE SERVICING CONTRACTOR PERFORM FIELD TESTS FOR QUALITY CONTROL OF ALL SANITARY SEWERS. LEAKAGE TESTING SHALL BE COMPLETED IN ACCORDANCE WITH OPSS 410.07.16, 410.07.16.04 AND 407.07.24. DYE TESTING IS TO BE COMPLETED ON ALL SANITARY SERVICES TO CONFIRM PROPER CONNECTION TO THE SANITARY SEWER MAIN. THE FIELD TESTS SHALL BE PERFORMED IN THE PRESENCE OF A CERTIFIED PROFESSIONAL ENGINEER WHO SHALL SUBMIT A CERTIFIED COPY OF THE TEST RESULTS.
- THE CONTRACTOR IS TO TELEVISION (CCTV) ALL PROPOSED SEWERS, 200mmØ OR GREATER PRIOR TO BASE COURSE ASPHALT. UPON COMPLETION OF CONTRACT, THE CONTRACTOR IS RESPONSIBLE TO FLUSH AND CLEAN ALL SEWERS & APPURTENANCES.
- CONTRACTOR TO PROVIDE THE CONSULTANT WITH A PLAN AND PROFILE DRAWING INDICATING ALL APPLICABLE SERVICING AS-BUILT INFORMATION SHOWN ON THIS PLAN. AS-BUILT INFORMATION MUST INCLUDE: PIPE MATERIAL, SIZES, LENGTHS, SLOPES, INVERT AND T/O ELEVATIONS, STRUCTURE LOCATIONS AND ANY ALIGNMENT CHANGES, ETC.

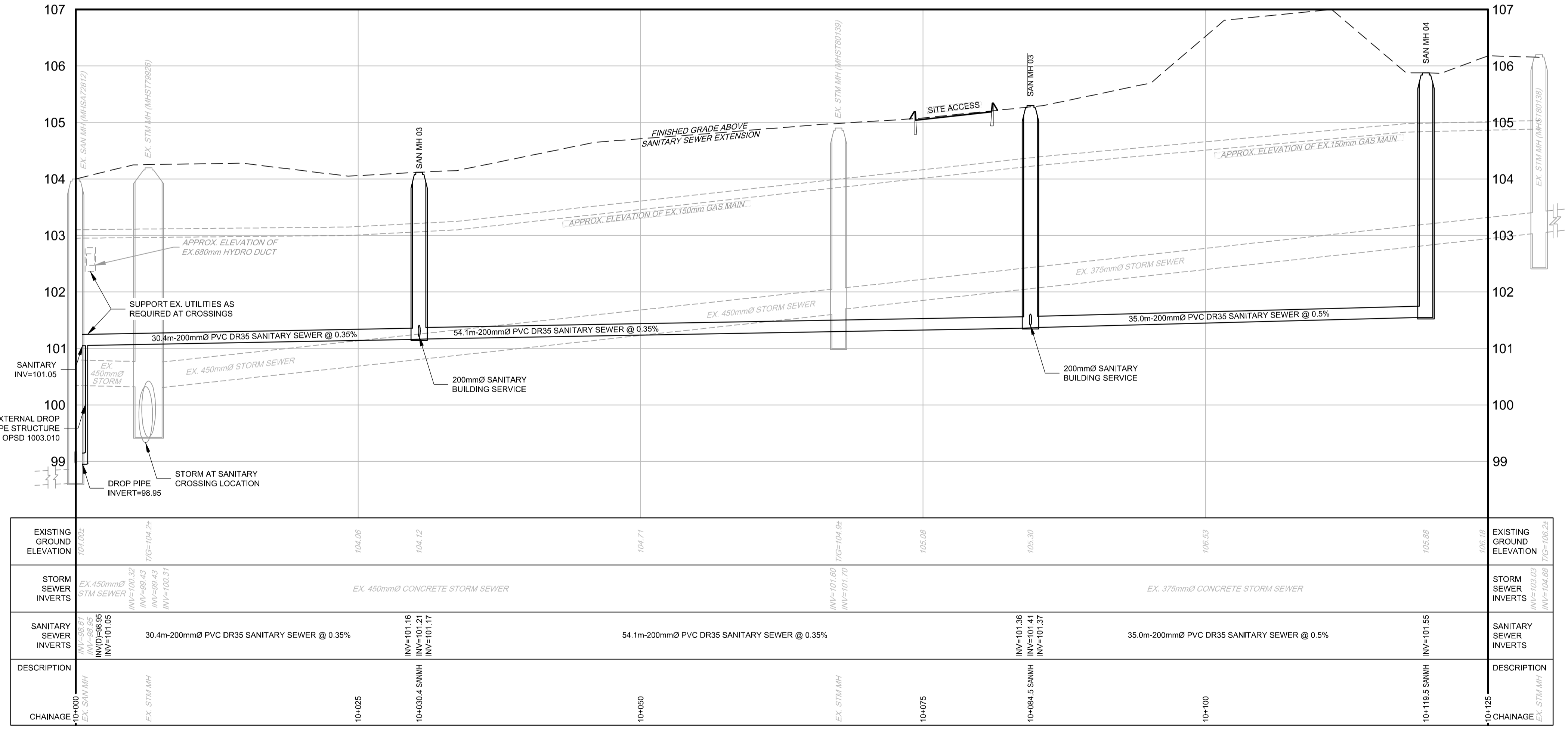

CHAINAGE	EXISTING GROUND ELEVATION	STORM SEWER INVERTS	SANITARY SEWER INVERTS	DESCRIPTION
10+000	104.06	EX. 450mmØ STM SEWER INV=100.32 INV=99.43 INV=100.31 INV=100.31	INV=101.05 INV=98.95	EX. SAN MH (AKS7988)
10+025	104.12	EX. 450mmØ CONCRETE STORM SEWER	INV=101.16 INV=101.21 INV=101.17	EX. STM MH
10+050	104.71	EX. 450mmØ CONCRETE STORM SEWER	INV=101.60 INV=101.70	EX. STM MH
10+075	105.09	EX. 375mmØ CONCRETE STORM SEWER	INV=101.36 INV=101.41 INV=101.37	EX. STM MH
10+100	106.51	EX. 375mmØ CONCRETE STORM SEWER	INV=101.55	EX. STM MH
10+125	106.51	EX. 375mmØ CONCRETE STORM SEWER	INV=103.03 INV=104.68	EX. STM MH

NOTE:
THE POSITION OF ALL POLE LINES, CONDUITS, WATERMANS, SEWERS AND OTHER UNDERGROUND AND OVERGROUND UTILITIES AND STRUCTURES IS NOT NECESSARILY SHOWN ON THE CONTRACT DRAWINGS, AND WHERE SHOWN, THE ACCURACY OF THE POSITION OF SUCH UTILITIES AND STRUCTURES IS NOT GUARANTEED. BEFORE STARTING WORK, DETERMINE THE EXACT LOCATION OF ALL SUCH UTILITIES AND STRUCTURES AND ASSUME ALL LIABILITY FOR DAMAGE TO THEM.

No.	REVISION	DATE	BY
1.0	REVISED PER CITY COMMENTS: PHASE 3-2	MAY 15/24	DDB
1.	ISSUED TO THE CITY	MAY 10/24	CJR

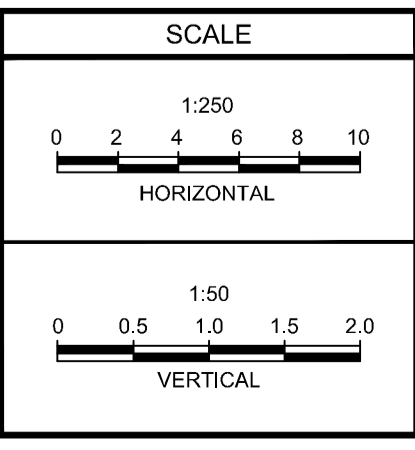

DESIGN	SM / BM / DDB
CHECKED	DDB / C.J.R.
DRAWN	SM
CHECKED	C.J.R. / DDB
APPROVED	DDB



NOVATECH
Engineers, Planners & Landscape Architects
Suite 200, 240 Michael Cowpland Drive
Ottawa, Ontario, Canada K2M 1P6
Telephone (613) 254-9643
Facsimile (613) 254-5867
Website www.novatech-eng.com

LOCATION	CITY OF OTTAWA 5000 ROBERT GRANT AVENUE
DRAWING NAME	SANITARY SEWER EXTENSION PLAN AND PROFILE (STATION 10+000 TO 10+125)
PROJECT No.	117151
REV	REV # 1.0
DRAWING No.	117151-PR

M:\2024\117151\117151-PR (RGA). May 14, 2024 - 1:40am, smallhines