

LEGEND

- SITE BOUNDARY
- SWALE AND DIRECTION OF FLOW
- MAXIMUM 3:1 SIDESLOPE
- SURFACE FLOW DIRECTION
- PROPOSED FINISHED FLOOR ELEVATION
- PROPOSED UNDER SIDE OF FOOTING ELEVATION
- PROPOSED BUILDING ENTRANCE
- PROPOSED LIMIT OF BUILDING OVERHANG
- PROPOSED STORM MANHOLE
- CB1 PROPOSED CATCHBASIN
- CB1-T PROPOSED CATCHBASIN WITH TEMPORARY SILTSACK
- CB1-T PROPOSED CATCHBASIN TEE
- CB1-E PROPOSED CATCHBASIN ELBOW
- PD 15 PROPOSED PODIUM DRAIN (PER MECHANICAL)
- CIPD 02 PROPOSED CURB INLET PODIUM DRAIN (PER MECHANICAL)
- ICD PROPOSED INLET CONTROL DEVICE
- APPROXIMATE PONDING LIMITS
- 1.5 YR
- 1:100 YR
- STORM DRAINAGE BOUNDARY
- A-1 SUB-CATCHMENT AREA ID
- 0.034 TRIBUTARY AREA (ha)
- 0.82 1.5 YR POST-DEV. RUNOFF COEFFICIENT

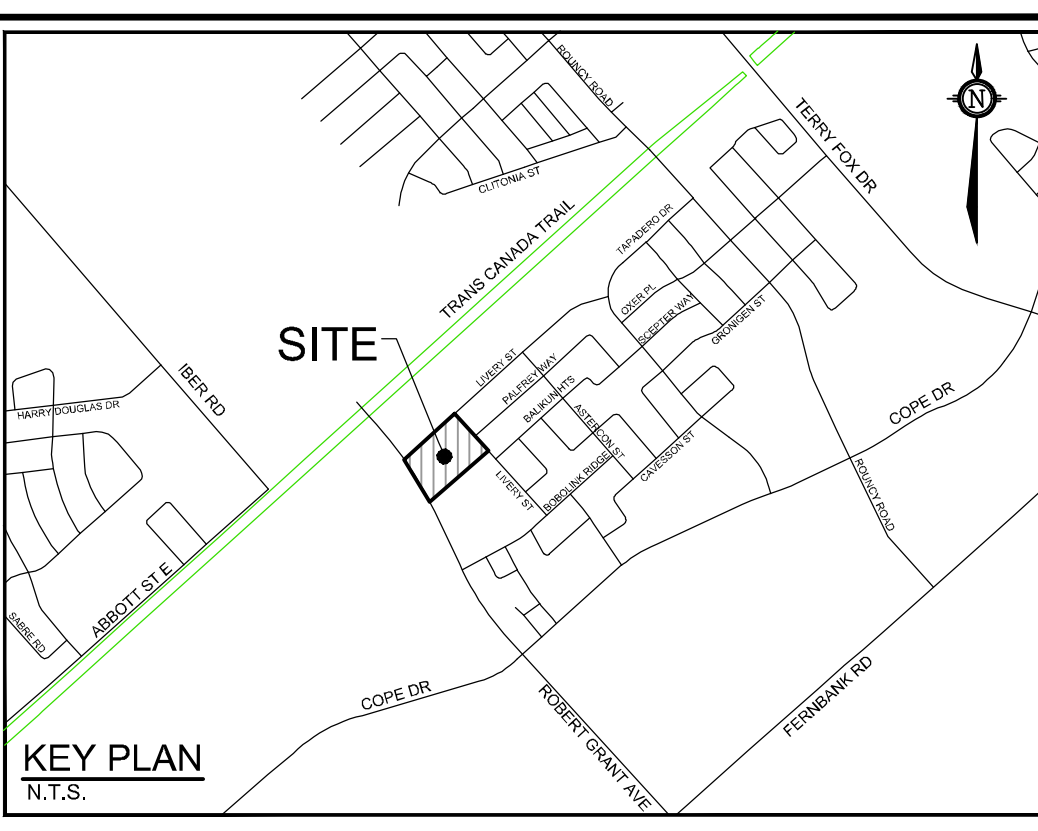

BENCHMARK INFO:

OLS JOB BENCHMARK ON THE TOP OF SPINDLE OF THE EXISTING MUNICIPAL FIRE HYDRANT LOCATED NEAR THE NORTH-EAST INSIDE CORNER WHERE JOURNEYMAN STREET TURNS 90 DEGREES IN FRONT OF THE SUBJECT SITE. GEODETIC ELEVATION = 103.82m (AS SHOWN ON THE SURVEYOR'S PLAN Ref. No. 18413-17 Lepine Corp. Bkls2028&203 4M-1503 T F; PREPARED BY ANNIS, O'SULLIVAN, VOLLEBEKK LTD.)

ALL ELEVATIONS ARE REFERRED TO THE CGVD28 GEODETIC DATUM. THE EXISTING GRADES SHOWN ON THE PLANS ARE TAKEN DIRECTLY FROM TOPOGRAPHICAL SURVEY PLAN (Ref. No. 18413-17 Lepine Corp. Bkls2028&203 4M-1503 T F), PREPARED BY ANNIS, O'SULLIVAN, VOLLEBEKK SIGNED AND DATED NOVEMBER 17, 2017.

SURROUNDING BACKGROUND TOPO INFORMATION BEYOND THE LIMITS OF THE SITE SURVEY ARE SHOWN FROM CITY OF OTTAWA 1:2000 MAPPING FOR CONTEXT ONLY.

- GENERAL NOTES:**
- COORDINATE AND SCHEDULE ALL WORK WITH OTHER TRADES AND CONTRACTORS.
 - DETERMINE THE EXACT LOCATION, SIZE, MATERIAL AND ELEVATION OF ALL EXISTING UTILITIES PRIOR TO COMMENCING CONSTRUCTION. PROTECT AND ASSUME RESPONSIBILITY FOR ALL EXISTING UTILITIES WHETHER OR NOT SHOWN ON THIS DRAWING.
 - OBTAIN ALL NECESSARY PERMITS AND APPROVALS FROM THE CITY OF OTTAWA BEFORE COMMENCING CONSTRUCTION.
 - BEFORE COMMENCING CONSTRUCTION OBTAIN AND PROVIDE PROOF OF COMPREHENSIVE, ALL RISK AND OPERATIONAL LIABILITY INSURANCE FOR \$5,000,000.00. INSURANCE POLICY TO NAME OWNERS, ENGINEERS AND ARCHITECTS AS CO-INSURED.
 - COMPLETE ALL WORKS IN ACCORDANCE WITH THE MOST CURRENT CITY OF OTTAWA STANDARDS AND SPECIFICATIONS USING THE CURRENT GUIDELINES, BYLAWS AND STANDARDS INCLUDING MATERIALS OF CONSTRUCTION, DISINFECTION AND ALL RELEVANT REFERENCES TO O.P.S.S., O.P.S.D. & AWWA GUIDELINES - ALL CURRENT VERSIONS AND AS AMENDED.
 - RESTORE ALL DISTURBED AREAS ON-SITE AND OFF-SITE, INCLUDING TRENCHES AND SURFACES ON PUBLIC ROAD ALLOWANCES TO EXISTING CONDITIONS OR BETTER TO THE SATISFACTION OF THE CITY OF OTTAWA AND ENGINEER.
 - REMOVE FROM SITE ALL EXCESS EXCAVATED MATERIAL, ORGANIC MATERIAL AND DEBRIS UNLESS OTHERWISE INSTRUCTED BY ENGINEER. EXCAVATE AND REMOVE FROM SITE ANY CONTAMINATED MATERIAL. ALL CONTAMINATED MATERIAL SHALL BE DISPOSED OF AT A LICENSED LANDFILL FACILITY.
 - ALL ELEVATIONS ARE GEODETIC.
 - REFER TO THE GEOTECHNICAL INVESTIGATION REPORT (NO. PG4562-1, REV. 3, DATED MAY 9, 2019) PREPARED BY PATERSON GROUP INC., FOR SUBSURFACE CONDITIONS, CONSTRUCTION RECOMMENDATIONS, AND GEOTECHNICAL INSPECTION REQUIREMENTS. THE GEOTECHNICAL CONSULTANT IS TO REVIEW ON-SITE CONDITIONS AFTER EXCAVATION PRIOR TO PLACEMENT OF THE GRANULAR MATERIAL.
 - REFER TO ARCHITECT'S AND LANDSCAPE ARCHITECT'S DRAWINGS FOR BUILDING AND HARD SURFACED AREAS AND DIMENSIONS.
 - REFER TO THE 'SITE SERVICING AND STORMWATER MANAGEMENT REPORT' (R-2023-122) PREPARED BY NOVATECH.
 - SAW CUT AND KEY GRIND ASPHALT AT ALL ROAD CUTS AND ASPHALT TIE IN POINTS AS PER CITY OF OTTAWA STANDARDS (R10).
 - PROVIDE LINE / PARKING LOT PAINTING AS REQUIRED BY ARCHITECT.

INLET CONTROL DEVICE DATA TABLE: AREA A-2 (OUTLET PIPE of CBM01)

DESIGN EVENT	ICD TYPE (PLUG TYPE)	DIAMETER OF OUTLET PIPE (mm)	PEAK DESIGN FLOW (L/s)	PEAK DESIGN FLOW (L/s)	DESIGN HEAD (m)	WATER ELEVATION (m)	VOLUME (m ³)	AVAILABLE STORAGE
1:2 YR	IPEX TEMPEST	250mmØ	3.4	1.7	0.74	101.23 (w/g)	6.3	> 23.5 m ³
1:5 YR	VORTEX LMF (CUSTOM FLOW)	250mmØ	4.1	2.1	1.06	101.55 (w/g)	9.0	
1:100 YR	VORTEX LMF (CUSTOM FLOW)	PVC DR35	6.5	3.3	2.61	103.10	20.0	

NOTE:
THE POSITION OF ALL POLE LINES, CONDUITS, WATERMANS, SEWERS AND OTHER UNDERGROUND AND OVERGROUND UTILITIES AND STRUCTURES IS NOT NECESSARILY SHOWN ON THE CONTRACT DRAWINGS, AND WHERE SHOWN, THE ACCURACY OF THE POSITION OF SUCH UTILITIES AND STRUCTURES IS NOT GUARANTEED. BEFORE STARTING WORK, DETERMINE THE EXACT LOCATION OF ALL SUCH UTILITIES AND STRUCTURES AND ASSUME ALL LIABILITY FOR DAMAGE TO THEM.

No.	REVISION	DATE	BY
1.B	ISSUED FOR PHASE 3 PRE-CONSULTATION	OCT 27/23	DDB

DESIGN	SM / BM / DDB
CHECKED	DDDB / CR
DRAWN	SM
CHECKED	CR / DDB
APPROVED	DDDB

SCALE

1:400

FOR REVIEW ONLY

NOVATECH
Engineers, Planners & Landscape Architects
Suite 200, 240 Michael Cowpland Drive
Ottawa, Ontario, Canada K2M 1P6
Telephone: (613) 254-9643
Facsimile: (613) 254-5867
Website: www.novatech-eng.com

LOCATION
CITY OF OTTAWA
5000 ROBERT GRANT - RESIDENTIAL DEVELOPMENT

DRAWING NAME
POST-DEVELOPMENT
STORMWATER MANAGEMENT PLAN

PROJECT No. 117151
REV # 1.B
DRAWING No. 117151-SWM