

GERALDINE WILDMAN
MANAGER, DEVELOPMENT REVIEW SOUTH
PLANNING, DEVELOPMENT AND BUILDING SERVICES
DEPARTMENT, CITY OF OTTAWA

APPROVED
By Geraldine Wildman at 4:16 pm, Jul 29, 2025

1967 RIVERSIDE DRIVE
PARKING LOT D
SITE AREA = 0.63 ha
126 TOTAL PARKING SPACES
(60 SMALL CAR PARKINGS)

RIVERSIDE DRIVE

TRANSITWAY OFF-RAMP

SMYTH ROAD ON-RAMP

NOTE: A TOTAL OF 26 ACCESSIBLE PARKING SPACES ARE PROVIDED ON SITE, SATISFYING THE AODA AND CITY OF OTTAWA TRAFFIC AND PARKING BY-LAW NO. 2017-301 REQUIREMENT OF 14 ACCESSIBLE SPACES

LEGEND:

- EXISTING PROPERTY LINE
- EXISTING GRADE
- PROPOSED LIGHT DUTY PAVEMENT
- PROPOSED CONCRETE
- PROPOSED CONCRETE CURB PER CITY STD. SC1.1
- PROPOSED DEPRESSED CONCRETE CURB WITH TWSI PER CITY STD. SC7.3

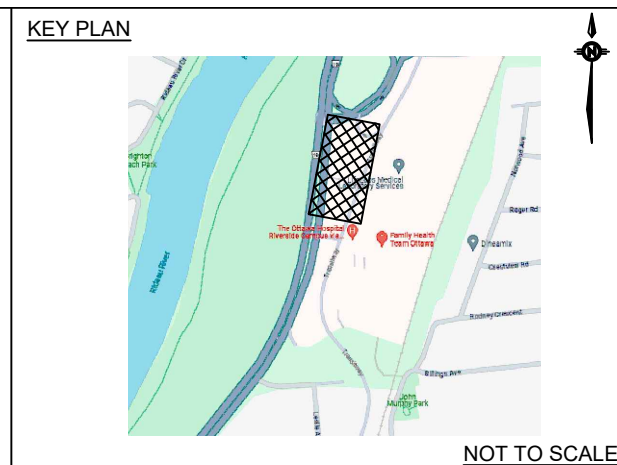

Surveyor
ANNIS, O'SULLIVAN, VOLLEBEKK LTD.
14 CONOURSE GATE, SUITE 500
NEPEAN, ONTARIO, K2E 7S8

TOPOGRAPHIC INFORMATION & BENCHMARK
SURVEY COMPLETED BY ANNIS, O'SULLIVAN, VOLLEBEKK LTD. ON MAY 28, 2024. ELEVATIONS SHOWN ARE GEODETIC AND ARE REFERRED TO THE CGVD28 GEODETIC DATUM, DERIVED FROM CONTROL MONUMENT NO. 019680274 HAVING AN ELEVATION OF 66.322m.

BOUNDARY INFORMATION WAS COMPILED FROM PLANS 4R-19213, 4R-35573 AND 4R-36051

JOB BENCHMARK

FIRE HYDRANT TOP OF SPINDLE ALONG TRANSITWAY
ELEVATION = 63.52m

PROPERTY LEGAL DESCRIPTION

THE NORTHERLY PART OF PIN 04201-0191 BEING PART OF LOT 16 CONGRESSION JUNCTION GORE GEOGRAPHIC TOWNSHIP OF GLOUCESTER CITY OF OTTAWA

Client
The Ottawa Hospital | L'Hôpital d'Ottawa

THE OTTAWA HOSPITAL
1053 CARLING AVENUE,
OTTAWA, ONTARIO, K1Y 4E9
(613) 722-7000

PARSONS
1223 MICHAEL STREET, SUITE 100
GLOUCESTER, ONTARIO, K1J 7T2

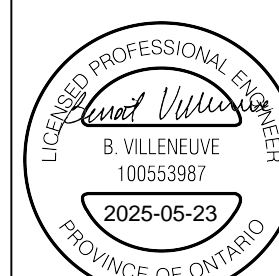

4	RE-ISSUED FOR SPA	BV	2025/05/15
3	RE-ISSUED FOR SPA	BV	2025/03/13
2	RE-ISSUED FOR SPA	BV	2025/01/17
1	ISSUED FOR SPA	BV	2024/11/08
No.	Revision	By	Date (yy/mm/dd)

Scale
0 5 10m
SCALE: 1:250

Project Title
**1967 RIVERSIDE DRIVE
RIVERSIDE CAMPUS
PARKING LOTS**

Drawing Title
**PARKING LOT D
SITE PLAN**

Designed by:	BV	Datum	CGVD28
Drawn by:	BV		
Approved by:	MT		
Project No.	479008	Drawing No.	SP-D

#19228 D07-12-25-0006

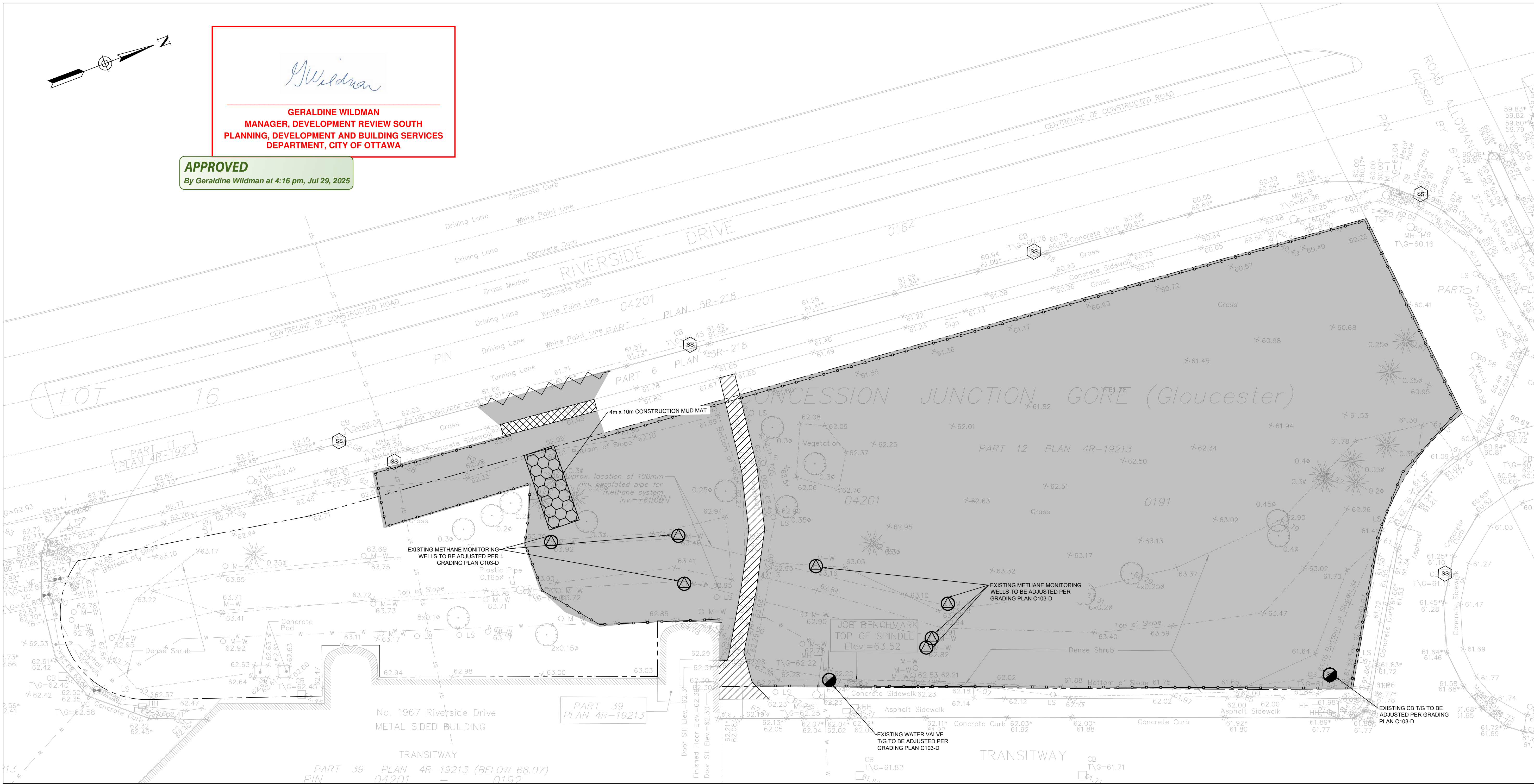

NOTES: REMOVALS AND DEMOLITION

- PRE-REMOVAL, THE CONTRACTOR MUST VISIT THE PREMISES IN ORDER TO BE FULLY AWARE OF EXISTING CONDITIONS ON SITE, INCLUDING ALL ELEMENTS TO BE REMOVED AND DEMOLISHED. NO CLAIM WILL BE ACCEPTED DUE TO A POOR EVALUATION OF THE WORK TO BE COMPLETED.
- THE CONTRACTOR IS RESPONSIBLE FOR LOCATING AND THE REQUEST FOR INTERRUPTION OF PUBLIC UTILITY SERVICES, SUCH AS GAS, TELEPHONE, POWER, CABLE, SEWERS, WATERMAIN, ETC. BEFORE PROCEEDING WITH WORK, COORDINATE WITH ALL APPLICABLE UTILITY COMPANIES.
- FIRE HYDRANTS TO BE TAGGED AND BAGGED AND/OR PROTECTED AS INDICATED ON DRAWING.
- CURB, ASPHALT, SIDEWALK, AND GRANULAR BASE TO BE EXCAVATED WITHIN LIMITS OF DEMOLITION REMOVAL. THE CONTRACTOR MUST CARRY OUT NECESSARY SAW CUTS.
- SEWER/WATERMAIN PIPES TO BE ABANDONED MUST BE CUT, FILL WITH UNSHRINKABLE CONCRETE CONFORMING TO OPSS 1359, AND CAPPED.
- REMOVE AND DISPOSE SEWERS AS INDICATED. PLUG ANY SERVICE LATERALS TO BE ABANDONED.
- THE CONTRACTOR MUST ENTIRELY REMOVE THE DEMOLITION WRECKAGE FROM THE CONSTRUCTION SITE OFFSITE IN ACCORDANCE WITH THE REQUIREMENTS OF THE MINISTRY OF ENVIRONMENT AND CLIMATE CHANGE (MOECC).
 - THE CONTRACTOR MUST DISCARD RECYCLABLE DEMOLITION MATERIALS IN COLLABORATION WITH A REGIONAL RECYCLING COMPANY.
 - ALL OTHER DEMOLITION MATERIALS MUST BE DISPOSED OFF-SITE AT AUTHORIZED LICENSED LANDFILLS AND IN CONFORMITY WITH THE APPLICABLE LAWS AND REGULATIONS. THE CONTRACTOR MUST BE ABLE TO PROVIDE, UPON REQUEST, COPIES OF THE DISPOSAL TICKETS TO THE OWNER'S REPRESENTATIVE.
- SURFACES AND WORKS LOCATED OUTSIDE OF THE CONSTRUCTION WORK LIMIT MUST BE REINSTATED AS THEY WERE BEFORE BEGINNING OF WORK. CONTRACTOR IS RESPONSIBLE TO MAKE GOOD ON ANY DAMAGES TO EXISTING CURB AND ASPHALT NOT SCHEDULED FOR REMOVAL.
- ALL MATERIALS, PRODUCTS AND OTHERS COMING FROM THE DEMOLITION BELONG TO THE CONTRACTOR, UNLESS SPECIFIED OTHERWISE.
- THE CONTRACTOR MUST COMPLETE ALL REMOVALS AS SHOWN ON THE DRAWINGS AND AS REQUIRED TO MAKE THE WORK COMPLETE.
- THE CONTRACTOR MUST PROTECT AND MAINTAIN IN SERVICE THE EXISTING WORKS WHICH MUST REMAIN IN PLACE. IF THEY ARE DAMAGED, THE CONTRACTOR MUST IMMEDIATELY MAKE THE REPLACEMENTS AND NECESSARY REPAIRS TO THE SATISFACTION OF THE OWNER'S REPRESENTATIVE AND WITHOUT ADDITIONAL EXPENSE TO THE OWNER.
- THE CONTRACTOR MUST NOT PERFORM ANY TREE CUTTING DURING THE CORE MIGRATORY BIRDS NESTING PERIOD, WHICH IS APRIL 15 TO AUGUST 15.

EROSION AND SEDIMENT CONTROL MEASURES:

- CONTRACTOR IS RESPONSIBLE FOR ALL INSTALLATION, MONITORING, REPAIR AND REMOVAL OF ALL EROSION AND SEDIMENT CONTROL FEATURES. THE CONTRACTOR SHALL IMPLEMENT BEST MANAGEMENT PRACTICES TO PROVIDE FOR PROTECTION OF THE AREA DRAINAGE SYSTEM AND THE RECEIVING WATERCOURSE, DURING CONSTRUCTION ACTIVITIES. THE CONTRACTOR ACKNOWLEDGES THAT FAILURE TO IMPLEMENT APPROPRIATE EROSION AND SEDIMENT CONTROL MEASURE MAY BE SUBJECT TO PENALTIES IMPOSED BY ANY APPLICABLE REGULATORY AGENCY.
- SEDIMENT AND EROSION CONTROL PLAN OBJECTIVES:
 - PREVENT SOIL EROSION. THIS CAN RESULT FROM STREAMING RAIN WATER OR WIND.
 - PREVENT SEDIMENT DEPOSITS IN THE SEWER PIPES AND NEARBY COLLECTING STREAMS (AS APPLICABLE).
 - PREVENT AIR POLLUTION FROM PARTICULATE MATTER AND DUST.

1. PRIOR TO START OF CONSTRUCTION:

- PRIOR TO THE REMOVAL OF ANY VEGETATIVE COVER, MOVING OF SOIL AND CONSTRUCTION:
- INSTALL SILT FENCE (AS PER OPSD 219.110) ALONG DITCHES IMMEDIATELY DOWNSTREAM FROM AREAS TO BE DISTURBED (SEE PLAN FOR LOCATION).
 - INSTALL FILTER CLOTH ON DOWNSTREAM MANHOLE COVERS.
 - INSTALL SILTSACK FILTERS IN ALL CONCRETE CATCH BASINS STRUCTURES.
 - INSPECT MEASURES IMMEDIATELY AFTER INSTALLATION.
 - THE CONTRACTOR MUST SET UP THE MEASURES INDICATED ON THE PLAN, INSPECT THEM FREQUENTLY AND CLEAN AND REPAIR OR REPLACE THE DETERIORATED STRUCTURES. AT THE END OF THE CONSTRUCTION PERIOD, THE CONTRACTOR IS RESPONSIBLE FOR REMOVAL OF THE TEMPORARY STRUCTURES AND RECONDITIONING THE AFFECTED AREAS.

2. DURING CONSTRUCTION:

- SEDIMENT AND EROSION CONTROL MEASURES TO BE CONSTRUCTED AS PER OPSD 805.
- WHEN SEDIMENT AND EROSION CONTROL MEASURES MUST BE REMOVED TO COMPLETE A PORTION OF THE WORK, THE SAME MEASURES MUST BE REINSTATED

- UPON THE WORK'S COMPLETION.
- WORK TO BE DONE IN THE VICINITY OF MAJOR WATERWAYS TO BE CARRIED OUT FROM JULY AND SEPTEMBER ONLY.
 - MINIMIZE THE EXTENT OF DISTURBED AREAS AND THE DURATION OF EXPOSURE.
 - PROTECT DISTURBED AREAS FROM RUNOFF.
 - PROVIDE TEMPORARY COVER SUCH AS SEEDING OR MULCHING IF DISTURBED AREA WILL NOT BE REHABILITATED SHORTLY.
 - INSPECT STRAW BALE FLOW CHECK DAMS, SILT FENCES, SILT SACKS, AND CATCH BASIN SUMPS REGULARLY AND AFTER EVERY MAJOR STORM EVENT. CLEAN AND REPAIR WHEN NECESSARY.
 - PLAN TO BE REVIEWED AND REVISED AS REQUIRED DURING CONSTRUCTION.
 - EROSION CONTROL FENCING TO BE ALSO INSTALLED AROUND THE BASE OF ALL STOCKPILES.
 - DO NOT LOCATE TOPSOIL PILES AND EXCAVATION MATERIAL CLOSER THAN 2.5m FROM ANY PAVED SURFACE, OR ONE WHICH IS TO BE PAVED BEFORE THE PILE IS REMOVED. ALL TOPSOIL PILES ARE TO BE SEEDED IF THEY ARE TO REMAIN ON SITE LONG ENOUGH FOR SEEDS TO GROW (LONGER THAN 30 DAYS). WHEN STORING SOIL ON SITE IN PILES THE CONTRACTOR MUST COVER EACH PILE WITH TARP, STRAW OR A GEOTEXTILE FABRIC TO AVOID FINE PARTICLE TRANSPORT BY WIND AND/OR STREAMING RAIN WATER.
 - CONTROL WIND-BLOWN DUST OFF SITE TO ACCEPTABLE LEVELS BY SEEDING TOPSOIL PILES AND OTHER AREAS TEMPORARILY (PROVIDE WATERING AS REQUIRED). FOR DUST CONTROL, CONTRACTOR TO APPLY CALCIUM CHLORIDE (TYPE I - OPSS 2501 AND CAN/CSSB-15-1) AND WATER WITH EQUIPMENT APPROVED BY THE OWNER'S REPRESENTATIVE AT RATE IN ACCORDANCE TO OPSS 506 WHEN DIRECTED BY OWNER'S REPRESENTATIVE.
 - ALL EROSION CONTROL STRUCTURE TO REMAIN IN PLACE UNTIL ALL DISTURBED GROUND SURFACES HAVE BEEN STABILIZED EITHER BY PAVING OR RESTORATION OF VEGETATIVE GROUND COVER. SEDIMENT CAPTURE SILT SACKS MUST BE MAINTAINED AND CANNOT BE REMOVED UNTIL ALL LANDSCAPING AREAS ARE COMPLETED.
 - NO ALTERNATE METHODS OF EROSION PROTECTION SHALL BE PERMITTED UNLESS APPROVES BY THIS CONSULTING ENGINEER AND THE TOWN DEPARTMENT OF PUBLIC WORKS.
 - CONTRACTOR RESPONSIBLE FOR MUNICIPAL ROADWAY AND SIDEWALK TO BE CLEANED OF ALL SEDIMENT FROM VEHICULAR TRAVEL ETC. AT THE END OF EACH WORK DAY.
 - DURING WET CONDITIONS, TIRES OF ALL VEHICLES/EQUIPMENT LEAVING THE SITE ARE TO BE SCRAPED.
 - ANY MUD/MATERIAL TRACKED ONTO THE ROAD SHALL BE REMOVED IMMEDIATELY BY HAND OR RUBBER TIRE LOADER.
 - TAKE ALL NECESSARY STEPS TO PREVENT BUILDING MATERIAL, CONSTRUCTION DEBRIS OR WASTE BEING SPILLED OR TRACKED ONTO ADJUTING PROPERTIES OR PUBLIC STREETS DURING CONSTRUCTION AND PROCEED IMMEDIATELY TO CLEAN UP ANY AREAS SO AFFECTED.
 - PROVIDE GRAVEL ENTRANCE WHEREVER EQUIPMENT LEAVES THE SITE TO PROVIDE MUD TRACKING ONTO PAVED SURFACES. GRAVEL BED SHALL BE A MINIMUM OF 10m LONG, 4m WIDE, AND 0.15m DEEP AND SHALL CONSIST OF COARSE MATERIAL. MAINTAIN GRAVEL ENTRANCE IN CLEAN CONDITION.

3. AFTER CONSTRUCTION:

- PROVIDE PERMANENT COVER CONSISTING OF TOPSOIL AND SEED TO DISTURBED AREAS.
- ALL SEDIMENT AND EROSION CONTROL MEASURES TO BE REMOVED BY THE CONTRACTOR FOLLOWING THE COMPLETION OF WORK AND AFTER DISTURBED AREAS HAVE BEEN REHABILITATED AND STABILIZED. THIS INCLUDES REMOVE STRAW BALE FLOW CHECK DAMS, SILT FENCES AND FILTER CLOTHS ON CATCH BASINS AND MANHOLE COVERS.
- INSPECT AND CLEAN CATCH BASIN SUMPS AND STORM SEWERS.

LEGEND:

- EXISTING PROPERTY LINE
- STRUCTURE TO BE ADJUSTED
- STRUCTURE TO BE REMOVED
- METHANE MONITORING WELL TO BE ADJUSTED
- SILT SACK PER DETAIL D1
- EXISTING ASPHALT REMOVAL
- EXISTING CONCRETE SIDEWALK REMOVAL
- CLEARING & GRUBBING AREA/ LANDSCAPE REMOVAL
- EXISTING CURB REMOVAL
- PROPOSED SILT FENCE PER OPSD 219.110



ANNIS, O'SULLIVAN, VOLLEBEKK LTD.
14 CONCOURSE GATE, SUITE 500
NEPEAN, ONTARIO, K2E 7S8

TOPOGRAPHIC INFORMATION & BENCHMARK
SURVEY COMPLETED BY ANNIS, O'SULLIVAN, VOLLEBEKK LTD. ON MAY 28, 2024. ELEVATIONS SHOWN ARE GEODETIC AND ARE REFERRED TO THE CGVD28 GEODETIC DATUM, DERIVED FROM CONTROL MONUMENT NO. 019680274 HAVING AN ELEVATION OF 66.322m.

BOUNDARY INFORMATION WAS COMPILED FROM PLANS 4R-19213, 4R-35573 AND 4R-36051

JOB BENCHMARK

FIRE HYDRANT TOP OF SPINDLE ALONG TRANSITWAY
ELEVATION = 63.52m



THE OTTAWA HOSPITAL
1053 CARLING AVENUE
OTTAWA, ONTARIO, K1Y 4E9
(613) 722-7000



4	RE-ISSUED FOR SPA	BV	2025/05/15
3	RE-ISSUED FOR SPA	BV	2025/03/13
2	RE-ISSUED FOR SPA	BV	2025/01/17
1	ISSUED FOR SPA	BV	2024/11/08

No.	Revision	By	Date (yy/mm/dd)

Scale
0 5 10m
SCALE: 1:250

Project Title

THE OTTAWA HOSPITAL
RIVERSIDE CAMPUS
PARKING LOT

Drawing Title
PARKING LOT D
REMOVALS PLAN

Designed by:	BV	Datum	CGVD28
Drawn by:	BV		
Approved by:	MT		
Project No.	479008	Drawing No.	C101-D

#10228 D07-12-25-0006

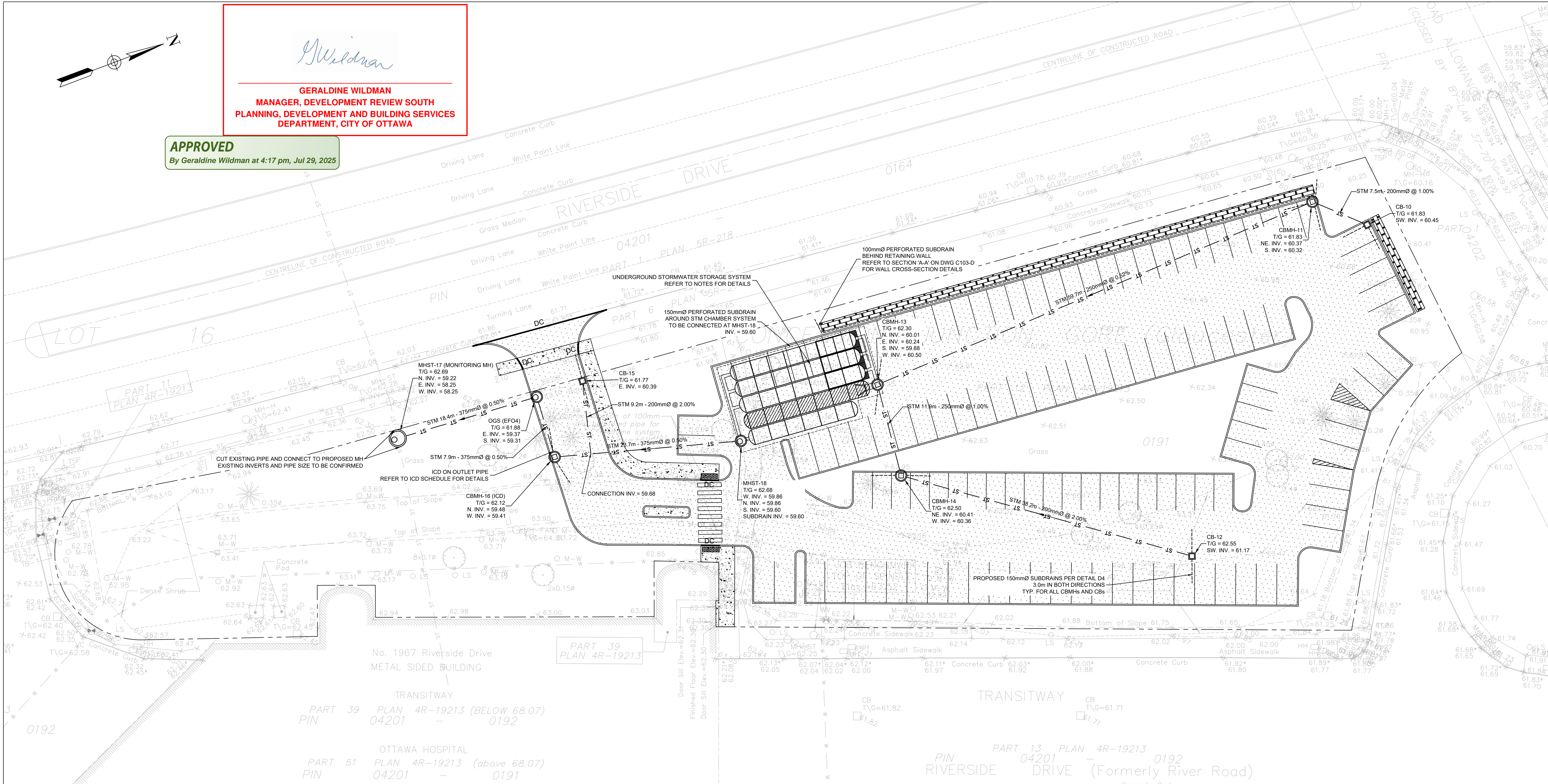

NOTES: SEWER

- CONTRACTOR TO CONFIRM ELEVATION OF EXISTING STORM AND SANITARY SEWERS AT PROPOSED CONNECTION POINTS AND REPORT ANY DISCREPANCIES TO THE ENGINEER BEFORE COMMENCING ANY WORK.
- ALL WORK SHALL BE PERFORMED, AS APPLICABLE IN ACCORDANCE WITH OPSS 407, 408 AND 410.
- ALL STORM AND SANITARY SEWERS INSTALLED BELOW THE GROUNDWATER TABLE ELEVATION SHALL BE WATERTIGHT AND INFILTRATION TESTS SHALL BE CARRIED OUT ACCORDING TO OPSS MUNI 410.
- PIPE MATERIAL TO BE PVC SDR-35 AND CONFORMING TO OPSS 1841, UNLESS INDICATED OTHERWISE. PVC SEWERS TO BE INSTALLED PER OPSD 802.010 (MODIFIED), BEDDING AND COVER MATERIALS TO BE OPSS 1010 GRANULAR 'A' CRUSHER-RUN LIMESTONE BEDDING COMPACTED TO 95% SPMD.
- ALL SEWERS WITH LESS THAN 1.5 METERS OF COVER ARE SUBJECT TO INSULATION PER CITY OF OTTAWA STD DETAIL, S35.
- PIPE BACKFILL MATERIAL TO BE APPROVED NATIVE MATERIAL OR SELECT SUBGRADE MATERIAL IN CONFORMANCE WITH OPSS 212.
- ALL MAINTENANCE HOLES AND CATCH BASIN MAINTENANCE HOLES TO BE 1200mmØ AS PER OPSD 701.010, UNLESS INDICATED OTHERWISE. MAINTENANCE HOLES AND CATCH BASIN MAINTENANCE HOLES TO BE INSTALLED PER OPSS 407.
- ALL CATCH BASINS TO BE 600x600mm AS PER OPSD 705.010, UNLESS INDICATED OTHERWISE. CATCH BASINS TO BE INSTALLED PER OPSS 407.
- EXCAVATING, BACKFILLING, AND COMPACTING REQUIRED FOR MAINTENANCE HOLES, CATCH BASIN MAINTENANCE HOLES, AND CATCH BASINS TO BE COMPLETED AS PER OPSS 402. THEY ARE TO BE BACKFILLED WITH OPSS GRANULAR 'B' COMPACTED TO 98% SPMD. JOINTS BETWEEN SECTIONS TO BE WRAPPED WITH NON-WOVEN GEOTEXTILE.
- FOR SANITARY STRUCTURES: CAST IRON MAINTENANCE HOLE COVER AS PER OPSD 401.010 TYPE 'A'.
- FOR STORM STRUCTURES: CAST IRON CATCH BASIN MAINTENANCE HOLE COVER AS PER OPSD 401.010 TYPE 'B' AND CAST IRON CATCH BASIN COVER AS PER OPSD 400.020.
- MAINTENANCE HOLES REQUIRE BENCHING AS PER OPSD 701.021.
- THE CONTRACTOR IS RESPONSIBLE FOR MAKING OR ARRANGING ALL CONNECTIONS TO THE EXISTING SEWERS AS PER MUNICIPAL REQUIREMENTS. PRIOR TO CONNECTION, THE CONTRACTOR MUST PROVIDE, TO THE CONSULTANT / ENGINEER AND THE CITY FOR APPROVAL, ALL TEST RESULTS PERFORMED ON THE INTERNAL SERVICES.
- ADVISE THE CITY PUBLIC WORKS AT LEAST 72 HOURS IN ADVANCE BEFORE ANY CONNECTION TO THE CITY SERVICES. CO-ORDINATE WITH CITY AS REQUIRED.
- TERMINATE AND PLUG ALL SERVICE CONNECTIONS AT 1.0 m FROM EDGE OF THE BUILDING.
- ALL SEWERS TO BE C.C.T.V. INSPECTED BY THE CONTRACTOR AS PER OPSS 409. TWO COPIES OF THE INSPECTION REPORT MUST BE PROVIDED TO THE CONSULTANT AND THE C.C.T.V. INSPECTION IN DVD FORMAT ONLY.
- SUBRAIN KNOCKOUT (KO) WILL BE PRE-MANUFACTURED WITH CATCH BASINS AND MAINTENANCE HOLES.
- THE OGS UNIT SHALL BE STORMCEPTOR EFO4 OR APPROVED EQUIVALENT. OGS WILL REQUIRE PERIODIC MAINTENANCE AND CLEANING AS PER MANUFACTURERS SPECIFICATIONS - TYPICAL CLEANING INTERVAL IS ONCE A YEAR.

NOTES: UNDERGROUND STORMWATER STORAGE

- UNDERGROUND STORMWATER STORAGE SYSTEM CHAMBER TYPE OR EQUIVALENT
- CHAMBER TYPE: STORMTECH MC-3500 OR APPROVED EQUIVALENT
- STORAGE PROVIDED: 205.9m³ (INCLUDING PERIMETER STONE)
- BOTTOM OF FOUNDATION PAD ELEVATION & PERFORATED SUBDRAIN INVERT: 59.60m.
- BOTTOM OF CHAMBER ELEVATION: 59.83m.
- TOP OF CHAMBER ELEVATION: 60.97m.
- TOP OF SYSTEM (PERIMETER STONE) = 61.28m.
- TOP OF CHAMBER TO BE A MINIMUM OF 450mm BELOW PARKING LOT PAVEMENT AND MAXIMUM 2.4m.
- SYSTEM TO BE COMPLETELY WRAPPED WITH GEOTEXTILE.
- SHOP DRAWINGS FOR UNDERGROUND STORAGE SYSTEM SHALL BE PROVIDED.
- INLET STRUCTURE (CBMH-13) & OUTLET STRUCTURE (MHST-18) TO BE OPSD 701.010 CONCRETE MAINTENANCE HOLE

ICD SCHEDULE						
ICD ID	LOCATION	ORIFICE INVERT (m)	FLOW 5y/100y (L/s)	HEAD 5y/100y (m)	EQUIVALENT DIAMETER (mm)	MODEL*
1	CBMH-16	59.41	4.8/7.4	0.80/1.85	50	JOHN MEUNIER HYDROVEX 75VHV-1

* ICD SHOP DRAWINGS SHALL BE SUBMITTED TO PARSONS BEFORE COMMENCING ANY WORK

LEGEND:

- EXISTING PROPERTY LINE
- EXISTING WATERMAIN
- EXISTING WATER VALVE
- EXISTING SANITARY SEWER AND MAINTENANCE HOLE
- EXISTING STORM SEWER AND MAINTENANCE HOLE
- EXISTING CATCH BASIN
- EXISTING METHANE MONITORING WELL
- PROPOSED STORM SEWER AND MAINTENANCE HOLE
- PROPOSED CATCH BASIN MAINTENANCE HOLE WITH 3.0m SUBDRAINS IN BOTH DIRECTIONS
- PROPOSED CATCH BASIN WITH 3.0m SUBDRAINS IN BOTH DIRECTIONS

KEY PLAN

NOT TO SCALE

Surveyor

ANNIS, O'SULLIVAN, VOLLEBECK LTD.
14 CONCOURSE GATE, SUITE 500
NEPEAN, ONTARIO, K2E 7S6

TOPOGRAPHIC INFORMATION & BENCHMARK

SURVEY COMPLETED BY ANNIS, O'SULLIVAN, VOLLEBECK LTD. ON MAY 28, 2024. ELEVATIONS SHOWN ARE GEODETIC AND ARE REFERRED TO THE CGVD28 GEODETIC DATUM, DERIVED FROM CONTROL MONUMENT NO. 019680274 HAVING AN ELEVATION OF 66.322m.

BOUNDARY INFORMATION WAS COMPILED FROM PLANS 4R-19213, 4R-35573 AND 4R-36051

JOB BENCHMARK

FIRE HYDRANT TOP OF SPINDLE ALONG TRANSITWAY
ELEVATION = 63.52m

Client

The Ottawa Hospital | L'Hôpital d'Ottawa

THE OTTAWA HOSPITAL
1053 CARLING AVENUE,
OTTAWA, ONTARIO, K1Y 4E9
(613) 722-7000

PARSONS

1223 MICHAEL STREET, SUITE 100
GLOUCESTER, ONTARIO, K1J 7T2

PROFESSIONAL ENGINEER
B. VILLENEUVE
100653987
2025-05-23
PROVINCE OF ONTARIO

No.	Revision	By	Date (yy/mm/dd)
4	RE-ISSUED FOR SPA	BV	2025/05/15
3	RE-ISSUED FOR SPA	BV	2025/03/13
2	RE-ISSUED FOR SPA	BV	2025/01/17
1	ISSUED FOR SPA	BV	2024/11/08

Scale

1m 0 5 10m

SCALE: 1:250

Project Title

**THE OTTAWA HOSPITAL
RIVERSIDE CAMPUS
PARKING LOT**

Drawing Title

**PARKING LOT D
SITE SERVICING PLAN**

Designed by:	BV	Datum	
Drawn by:	BV		
Approved by:	MT		
Project No.	479008	Drawing No.	

#19228 D07-12-25-0006

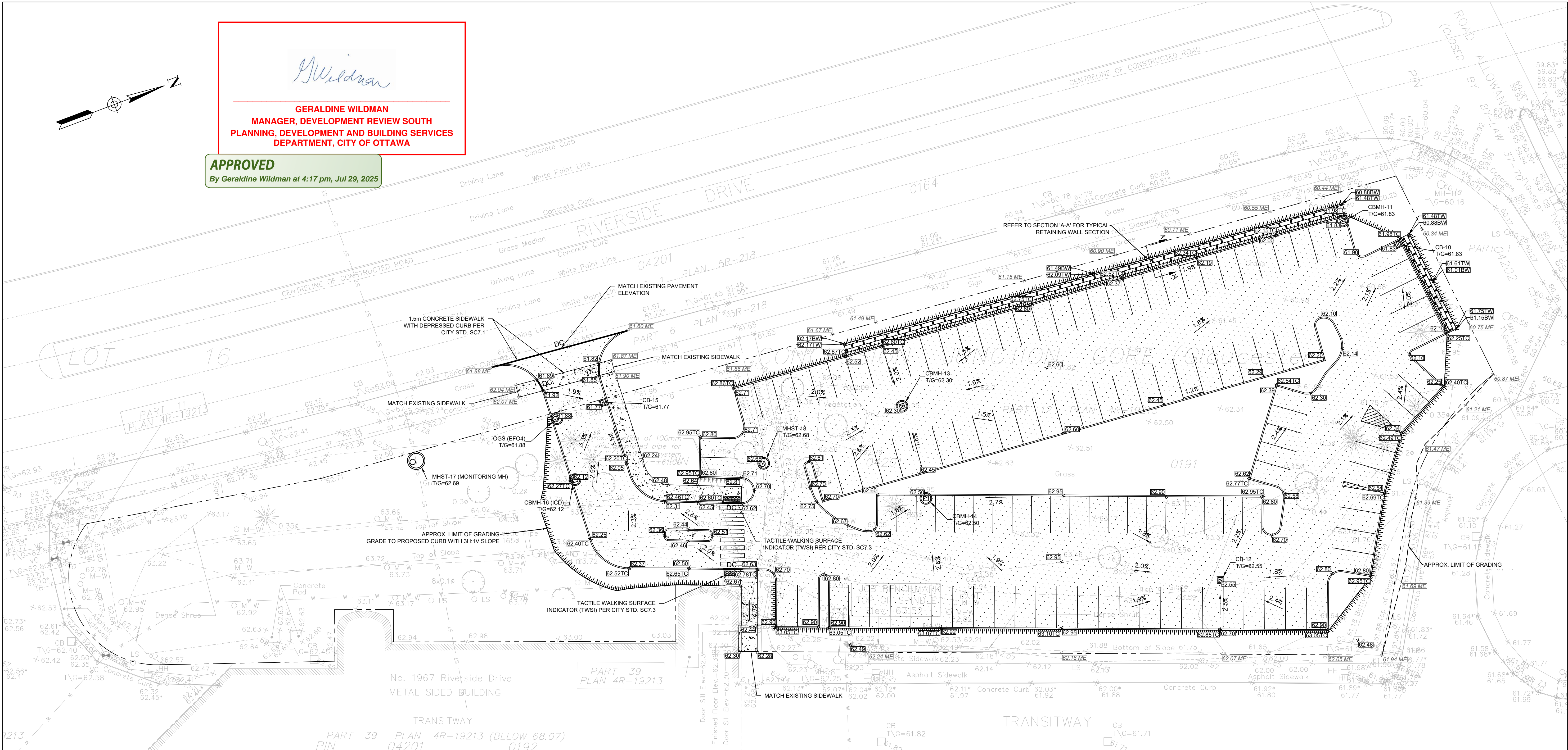

NOTES: GENERAL

1. THE CONTRACTOR MUST CONFORM TO ALL LAWS, CODES, ORDINANCES, AND REGULATIONS ADOPTED BY FEDERAL, PROVINCIAL, OR MUNICIPAL GOVERNMENT COUNCILS AND GOVERNMENT AGENCIES, APPLYING TO WORK TO BE CARRIED OUT. WHEREVER STANDARDS, LAWS AND/OR REGULATIONS ARE MENTIONED THEY REFER TO THEIR CURRENT VERSIONS. MODIFICATIONS INCLUDED.
2. ALL MATERIALS AND CONSTRUCTION METHODS SHALL BE IN ACCORDANCE WITH THE LATEST EDITION OF THE ONTARIO PROVINCIAL STANDARD SPECIFICATIONS AND DRAWINGS (OPSS AND OPSD), THE ONTARIO MINISTRY OF ENVIRONMENT AND CLIMATE CHANGE, THE ONTARIO MINISTRY OF NATURAL RESOURCES, APPLICABLE CONSERVATION AUTHORITIES, THE MUNICIPAL STANDARD SPECIFICATIONS AND DRAWINGS, AND ALL OTHER GOVERNING AUTHORITIES AS THEY APPLY, UNLESS OTHERWISE INDICATED.
3. ALL MATERIAL, SUPPLIED AND PLACED FOR PARKING LOT AND ACCESS ROAD CONSTRUCTION SHALL BE TO OPSS STANDARDS AND SPECIFICATIONS UNLESS OTHERWISE NOTED. CONSTRUCTION TO OPSS 206, 310 & 314. MATERIALS TO OPSS 1001, 1003 & 1010.
4. THE LOCATION OF EXISTING UNDERGROUND MUNICIPAL SERVICES AND PUBLIC UTILITIES AS SHOWN ON THE PLANS ARE APPROXIMATE. THE CONTRACTOR MUST DETERMINE THE EXACT LOCATION, SIZE, MATERIAL, AND ELEVATION OF ALL EXISTING UTILITIES (ON-SITE AND OFF-SITE) PRIOR TO ANY EXCAVATION WORK. DAMAGE TO ANY EXISTING SERVICES AND/OR EXISTING UTILITIES DURING CONSTRUCTION, WHETHER OR NOT SHOWN ON THE DRAWINGS MUST BE REPAIRED BY THE CONTRACTOR AT HIS OWN EXPENSE.
5. THE CONTRACTOR SHALL DETERMINE THE EXACT INVERT (GEODEIC ELEVATION), DIAMETER AND CONSTRUCTION MATERIAL OF THE EXISTING CONDUITS AT THE PROPOSED CONNECTIONS. THEY SHALL ALSO CARRY OUT, IF NECESSARY, EXPLORATORY DIGS IN ORDER TO DETERMINE THE EXACT LOCATION AND INVERTS OF EXISTING DUCK BANKS. THIS INFORMATION SHALL IMMEDIATELY BE PROVIDED TO THE CONSULTANT PRIOR TO START UNDERTAKING ANY MUNICIPAL SERVICES WORK AND A 48 HOUR PERIOD MUST BE ALLOCATED TO THE CONSULTANT FOR DESIGN REVIEW.
6. AT PROPOSED UTILITY CONNECTION POINTS AND CROSSINGS (I.E. STORM SEWER, SANITARY SEWER, WATER, ETC.) THE CONTRACTOR SHALL DETERMINE THE PRECISE LOCATION AND DEPTH OF EXISTING UTILITIES AND REPORT ANY DISCREPANCIES OR CONFLICTS TO THE ENGINEER BEFORE COMMENCING WORK. THE CONTRACTOR IS RESPONSIBLE FOR PROVIDING ADEQUATE PROTECTION OF THE WORKERS, OTHER PERSONNEL AND THE GENERAL PUBLIC, PROTECTION OF MATERIALS, AS WELL AS MAINTAINING IN GOOD CONDITION THE COMPLETED WORKS AND WORKS TO BE COMPLETED. THE CONTRACTOR MUST PROVIDE AT ANY TIME:
 - a. A SUFFICIENT NUMBER OF FENCES, BARRIERS, POSTERS, GUARDS AND OTHERS TO ENSURE SAFETY.
 - b. NECESSARY CONVENIENCES FOR THE COMPLETION OF WORK SUCH AS HEATING, LIGHTING, VENTILATION ETC.
7. CONTRACTOR IS RESPONSIBLE TO OBTAIN THE VARIOUS PERMITS/APPROVALS REQUIRED TO COMPLETE ALL THE WORKS AND ACTIVITIES AND BEAR COST OF THE SAME, SUCH AS BUT NOT LIMITED TO, ROAD CUT PERMITS, SEWER PERMITS, WATER PERMIT, ETC. AND THEIR ASSOCIATED COSTS.
8. ALL ELEVATIONS ARE GEODEIC AND UTILIZE METRIC UNITS.

12. JOB BENCH MARK - CONFIRM WITH PARSONS PRIOR TO UTILIZATION. THE CONTRACTOR MUST MAINTAIN BENCHMARKS AND LANDMARK REFERENCES AS IS OTHERWISE THESE REFERENCES WILL BE REPOSITIONED BY A CERTIFIED LAND SURVEYOR AT THE CONTRACTOR'S EXPENSE.
13. ALL GROUND SURFACES SHALL BE EVENLY GRADED WITHOUT PONDING AREAS AND LOW POINTS EXCEPT WHERE APPROVED SWALE OR CATCH BASIN OUTLETS ARE PROVIDED.
14. IF GROUNDWATER IS ENCOUNTERED DURING CONSTRUCTION, DEWATERING OF EXCAVATIONS COULD BE REQUIRED. IT IS ASSUMED THAT GROUNDWATER MAY BE CONTROLLED BY SUMP AND PUMPING METHODS. THE CONTRACTOR SHALL OBTAIN A PERMIT TO TAKE WATER IF SITE CONDITIONS REQUIRE TAKING MORE THAN A TOTAL OF 400 000 L/DAY.
15. STRIP AND REMOVE ALL TOPSOIL FROM IMPROVED AREAS. SITE PREPARATION INCLUDES CLEARING, GRUBBING, STRIPPING OF TOPSOIL, DEMOLITION, REMOVAL OF UNSUITABLE MATERIALS, CUT, FILL AND ROUGH GRADINGS OF ALL AREAS TO RECEIVE FINISHED SURFACES.
16. ABUTTING PROPERTY GRADE TO BE MATCHED.
17. ALL EDGES OF DISTURBED PAVEMENT SHALL BE SAW CUT TO FORM A NEAT AND STRAIGHT LINE PRIOR TO PLACING NEW PAVEMENT. PAVEMENT REINSTATEMENT SHALL BE WITH STEP JOINTS OF 300mm WITH MINIMUM.
18. CURBS TO BE BARRIER, CONSTRUCTED AS PER OPSD 600.110, EXCEPT WHERE INDICATED OTHERWISE. ELEVATION AT TOP OF CONCRETE CURBS TO BE 150 mm ABOVE THE ASPHALT, UNLESS OTHERWISE INDICATED ON THE DRAWINGS.
19. DEPRESSED CURBS TO BE MOUNTABLE, CONSTRUCTED AS PER OPSD 600.100.
20. LIGHT DUTY AND HEAVY DUTY ASPHALT PAVEMENTS TO BE CONSTRUCTED AS PER TABLE ON DRAWING C103-D.
21. TRANSITION BETWEEN EXISTING AND PROPOSED PAVEMENT SHALL BE CONSTRUCTED AS PER DETAIL D3 ON DRAWING C104-D.
22. RESTORE PAVEMENT STRUCTURE AND SURFACES ON EXISTING ROADS TO A CONDITION AT LEAST EQUAL TO ORIGINAL AND TO THE SATISFACTION OF THE MUNICIPAL AUTHORITIES.
23. CLEANLINESS ON THE SITE, INCLUDES THE CONTRACTOR SHALL CLEAN ROADWAYS AT HIS OWN COST AS DIRECTED BY THE OWNER'S REPRESENTATIVE. MATERIALS AND EQUIPMENT MUST BE LAID OUT IN AN ORGANIZED AND SAFE MANNER, AND ALL MATERIAL, EQUIPMENT AND TEMPORARY STRUCTURES WHICH ARE NO LONGER NECESSARY FOR THE EXECUTION OF THE CONTRACT MUST BE REMOVED FROM THE SITE.
24. CONTRACTOR TO ENSURE MITIGATION MEASURES ARE IMPLEMENTED TO REDUCE THE RISK OF GROUND CONTAMINATION FROM PETROLEUM PRODUCTS.
25. THE CONTRACTOR MUST ENSURE THE FOLLOWING MEASURES ARE IMPLEMENTED REGARDING THE HANDLING OF CONCRETE:
 - a. CONCRETE SHOULD EITHER BE MIXED AWAY FROM THE SITE OR SHOULD BE PREPARED ON PAVED SURFACES IF ONLY SMALL QUANTITIES ARE REQUIRED (I.E. MINOR REPAIRS).
 - b. EXCESS CONCRETE MUST BE DISPOSED OFF-SITE AT A LOCATION THAT MEETS ALL REGULATORY REQUIREMENTS.
 - c. THE WASHING OF CONCRETE TRUCKS AND OTHER EQUIPMENT USED FOR MIXING CONCRETE SHOULD NOT BE CARRIED OUT WITHIN 30 METERS OF A WATERCOURSE OR WETLAND AND SHOULD TAKE PLACE OUTSIDE OF THE WORK SITE.
 - d. ALL CONCRETE TRUCKS SHOULD COLLECT THEIR WASH WATER AND RECYCLE IT BACK INTO THEIR TRUCKS FOR DISPOSAL OFF-SITE AT A LOCATION MEETING ALL REGULATORY REQUIREMENTS.
26. THE CONTRACTOR SHALL ENSURE THAT ALL EXCAVATED SURPLUS MATERIALS THAT WILL BE REQUIRED TO BE DISPOSED OFF-SITE BE STOCKPILED TEMPORARILY FOR SAMPLING PRIOR TO BEING LOADED OFF-SITE.

27. MINIMIZE DISTURBANCE TO EXISTING VEGETATION DURING THE EXECUTION OF ALL WORKS.
28. TRENCHING, BACKFILLING AND COMPACTING MUST CONFORM TO OPSS 401.
29. DEWATERING OF PIPELINE, UTILITY AND ASSOCIATED STRUCTURE EXCAVATIONS TO BE COMPLETED AS PER OPSS 517.
30. THE CONTRACTOR MUST CONTROL SURFACE RUNOFF FROM PRECIPITATION DURING CONSTRUCTION.
31. FOR ALL GEOTECHNICAL WORK, CONTRACTOR TO REFER TO "GEOTECHNICAL INVESTIGATION, PROPOSED ALTERNATE PARKING LOT D, THE OTTAWA HOSPITAL - RIVERSIDE CAMPUS, 1967 RIVERSIDE DRIVE, OTTAWA, ONTARIO, BY GEMTEC, DATED MARCH 13, 2025."
32. REMOVE FROM SITE ALL EXCESS EXCAVATED MATERIAL UNLESS OTHERWISE DIRECTED FROM THE ENGINEER. EXCAVATE AND REMOVE ALL ORGANIC MATERIAL AND DEBRIS LOCATED WITHIN THE PROPOSED BUILDING, PARKING AND ROADWAY LOCATIONS.
33. THE CONTRACTOR IS RESPONSIBLE FOR ALL EXCAVATION, BACKFILL AND REINSTATEMENT OFF ALL AREAS DISTURBED DURING CONSTRUCTION TO EXISTING CONDITIONS OR BETTER AND ALL ASSOCIATED WORKS TO THE SATISFACTION OF THE CONSULTANT AND MUNICIPAL AUTHORITIES. ASPHALT REINSTATEMENT MUST BE IN ACCORDANCE WITH OPSS 310. LANDSCAPE AREAS TO BE REINSTATED WITH 150 mm OF TOPSOIL AND SSD IN ACCORDANCE WITH OPSS 802 AND OPSS 803.
34. DURING THE CONSTRUCTION PERIOD THE CONTRACTOR IS RESPONSIBLE FOR INSTALLING AND MAINTAINING TEMPORARY TRAFFIC SIGNAGE, INCLUDING TRAFFIC SIGNS, TRAFFIC MARKINGS AND TEMPORARY TRAFFIC LIGHTS, AND FLAGMEN, AS REQUIRED BY THE OWNER, THE CONSULTANT, THE MUNICIPALITY, THE MTO, AND OTHER GOVERNING AUTHORITIES.
35. RECONSTRUCT SIDEWALK EXPANSION JOINTS & CONTROL JOINTS AS PER OPSD 310.020.
36. CONSTRUCT CONCRETE SIDEWALK AS PER OPSD 310.020 AND OPSS 351. TACTILE WALKING SURFACE INDICATORS PER OPSS 351.
37. DISPOSE OF CONTAMINATED MATERIALS AT APPROPRIATE OFF-SITE FACILITY THAT MEETS ALL REGULATORY REQUIREMENTS.
38. BE PREPARED TO INTERCEPT, CLEAN UP, AND DISPOSE OF SPILLS OR RELEASES THAT MAY OCCUR WHETHER ON LAND OR WATER. MAINTAIN MATERIALS AND EQUIPMENT REQUIRED FOR CLEANUP OF SPILLS OR RELEASES READILY ACCESSIBLE ON SITE.
39. PROMPTLY REPORT SPILLS AND RELEASES POTENTIALLY CAUSING DAMAGE TO ENVIRONMENT TO: AUTHORITY HAVING JURISDICTION OR INTEREST IN SPILL OR RELEASES INCLUDING CONSERVATION AUTHORITY, WATER SUPPLY AUTHORITIES, DRAINAGE AUTHORITY, ROAD AUTHORITY, AND FIRE DEPARTMENT.
40. DECONTAMINATE EQUIPMENT AFTER WORKING IN POTENTIALLY CONTAMINATED WORK AREAS AND PRIOR TO SUBSEQUENT WORK OR TRAVEL ON CLEAN AREAS.
41. DO NOT DISCHARGE DECONTAMINATED WATER, OR SURFACE WATER RUNOFF, OR GROUNDWATER WHICH MAY HAVE COME IN CONTACT WITH POTENTIALLY CONTAMINATED MATERIAL, OFF SITE OR TO MUNICIPAL SEWERS.
42. CONTRACTOR IS TO SUBMIT A TRAFFIC MANAGEMENT PLAN FOR APPROVAL ONE (1) WEEK PRIOR TO ANY WORK WITHIN THE ROW LIMITS TO MEET THE REQUIREMENTS OF MTO BOOK 7. THE CONTRACTOR WILL BE REQUIRED TO IMPLEMENT ALL REQUIREMENTS OF THE MTO BOOK 7.
43. CITY PUBLIC WORKS DEPARTMENT TO BE CONTACTED MINIMUM 7 DAYS PRIOR TO PLANNED DATE FOR CONNECTION TO EXISTING STORM SEWERS, SANITARY SEWERS, AND WATERMAIN. CONNECTION TO EXISTING TO TAKE PLACE IN THE PRESENCE OF APPROPRIATE CITY OF OTTAWA STAFF.

PAVEMENT STRUCTURES			
MATERIAL	LIGHT DUTY	HEAVY DUTY	COMPACTION
SURFACE LAYER : SP 12.5 (PG 58-34 LEVEL B)	60 mm	N/A	≥ 92%*
BASE LAYER : SP 19 (PG 58-34 LEVEL B)	-	N/A	≥ 92%*
GRANULAR BASE : OPSS GRANULAR A	150 mm	N/A	98%**
GRANULAR SUB-BASE : OPSS GRANULAR B TYPE II	300 mm	N/A	98%**

*MINIMUM PAVEMENT COMPACTION BASED ON MAXIMUM RELATIVE DENSITY, PER OPSS MUNI 310
**OF THE STANDARD PROCTOR MAXIMUM DRY DENSITY

SOURCE: GEOTECHNICAL INVESTIGATION, PROPOSED ALTERNATE PARKING LOT D, THE OTTAWA HOSPITAL - RIVERSIDE CAMPUS, 1967 RIVERSIDE DRIVE, OTTAWA, ONTARIO, BY GEMTEC, DATED MARCH 13, 2025

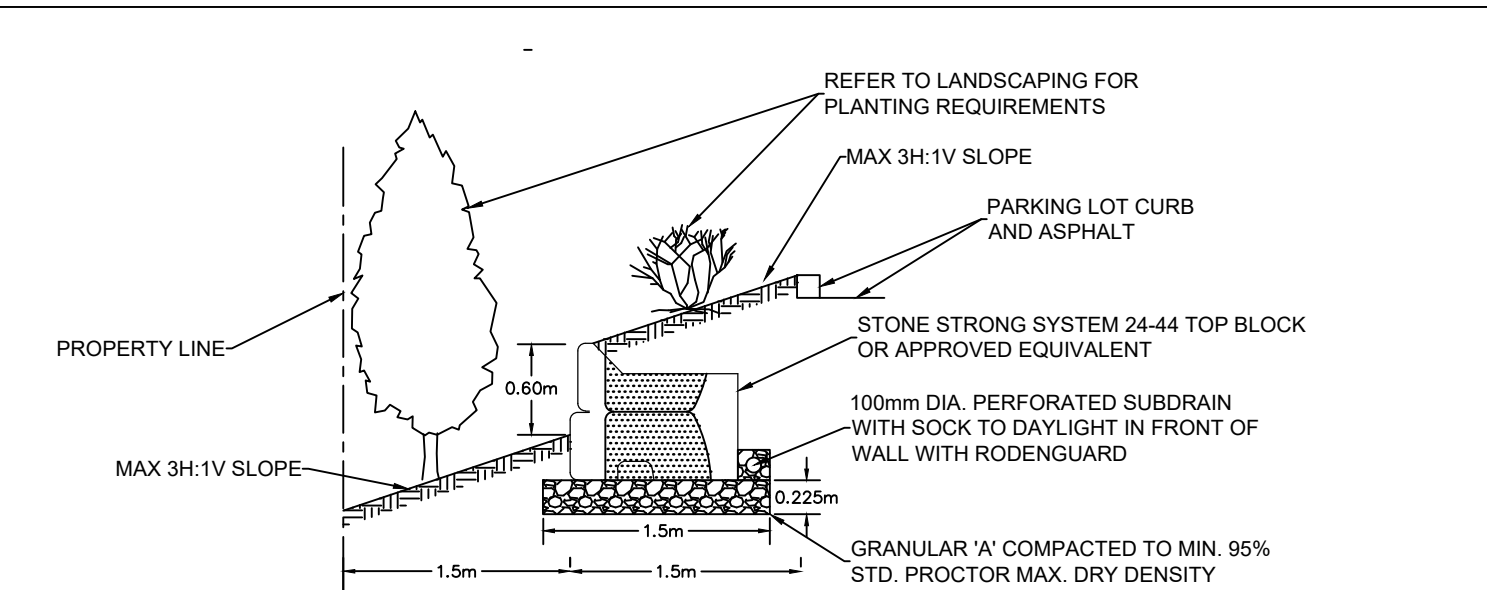

NOTE: BEARING CONDITIONS SHALL BE OBSERVED BY THE SITE GEOTECHNICAL ENGINEER. BASE DIMENSIONS MAY BE INCREASED TO ADDRESS DEFICIENT SOIL BEARING CONDITIONS.

REFER TO STONE STRONG SYSTEM FIELD CONSTRUCTION MANUAL FOR INSTALLATION DETAILS

1
FIG.1
SECTION A-A
SCALE: 1:50

LEGEND:

- EXISTING PROPERTY LINE
- TERRACE (3:1 MAX)
- EXISTING GRADE
- PROPOSED GRADE
- PROPOSED TOP OF CURB ELEVATION
- MATCH EXISTING SURFACE ELEVATION
- PROPOSED BOTTOM OF WALL ELEVATION
- PROPOSED TOP OF WALL ELEVATION
- PROPOSED SLOPE DIRECTION AND PERCENTAGE
- PROPOSED STORM MAINTENANCE HOLE
- PROPOSED CATCH BASIN MAINTENANCE HOLE
- PROPOSED CATCH BASIN
- PROPOSED LIGHT DUTY PAVEMENT
- PROPOSED CONCRETE
- PROPOSED CONCRETE CURB PER CITY STD. SC1.1
- PROPOSED DEPRESSED CONCRETE CURB WITH TWS PER CITY STD. SC7.3

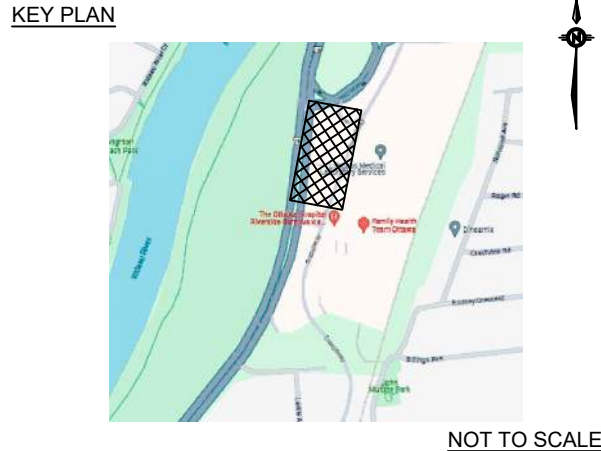

Surveyor

ANNIS, O'SULLIVAN, VOLLEBECK LTD.
14 CONCOURSE GATE, SUITE 500
NEPEAN, ONTARIO, K2E 7S6

TOPOGRAPHIC INFORMATION & BENCHMARK
SURVEY COMPLETED BY ANNIS, O'SULLIVAN, VOLLEBECK LTD. ON MAY 28, 2024. ELEVATIONS SHOWN ARE GEODEIC AND ARE REFERRED TO THE CGVD28 GEODEIC DATUM, DERIVED FROM CONTROL MONUMENT NO. 019680274 HAVING AN ELEVATION OF 66.322m.
BOUNDARY INFORMATION WAS COMPILED FROM PLANS 4R-19213, 4R-35573 AND 4R-36051
JOB BENCHMARK
FIRE HYDRANT TOP OF SPINDLE ALONG TRANSITWAY ELEVATION = 63.52m

Client

The Ottawa Hospital | L'Hôpital d'Ottawa

THE OTTAWA HOSPITAL
1053 CARLING AVENUE,
OTTAWA, ONTARIO, K1Y 4E9
(613) 722-7000

PARSONS

1223 MICHAEL STREET, SUITE 100
GLOUCESTER, ONTARIO, K1J 7T2

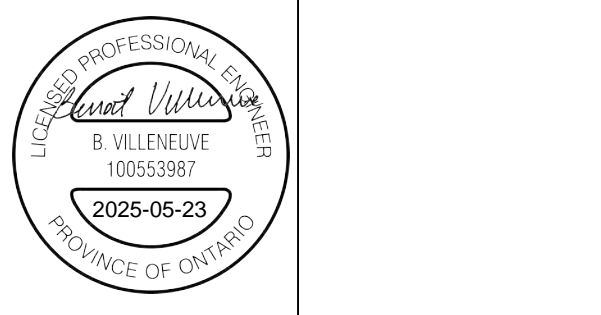

No.	Revision	By	Date (yy/mm/dd)
4	RE-ISSUED FOR SPA	BV	2025/05/15
3	RE-ISSUED FOR SPA	BV	2025/03/13
2	RE-ISSUED FOR SPA	BV	2025/01/17
1	ISSUED FOR SPA	BV	2024/11/08

Scale

0 5 10m
SCALE: 1:250

Project Title

THE OTTAWA HOSPITAL
RIVERSIDE CAMPUS
PARKING LOT

Drawing Title

PARKING LOT D
GRADING PLAN

Designed by:	BV	Datum	CGVD28
Drawn by:	BV		
Approved by:	MT		
Project No.	479008	Drawing No.	C103-D

#19228 D07-12-25-0006

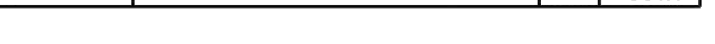
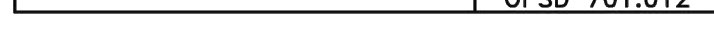
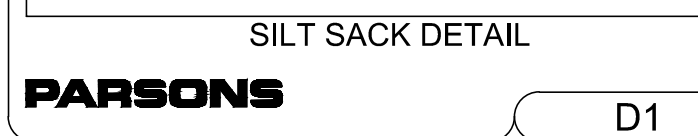

APPROVED
By Geraldine Wildman at 4:17 pm, Jul 29, 2025



SURVEYING

JOB BENCHMARK

FIRE HYDRANT TOP OF SPINDLE ALONG TRANSITWAY
ELEVATION = 63.52m

The Ottawa Hospital | L'Hôpital d'Ottawa

OTTAWA, ONTARIO, K1T 4E9
(613) 722-7000

GLOUCESTER, ONTARIO, K1J 7T2

B. VILLENEUVE
100562807

[illegible]

2	RE-ISSUED FOR SPA	BV	2025/01/17
1	ISSUED FOR SPA	BV	2024/11/08

PARKING LOT

PARKING LOT D

Designed by:	BV	Station
Engineer:		

479008	C105-D
--------	--------

#19228 D07-12-25-0006

APPROVED
By Geraldine Wildman at 4:18 pm, Jul 29, 2025

Diagram illustrating the components of a watershed model:

- WATERSHED NAME:** WS-XX
- AREA IN HECTARES:** 0.61
- RUNOFF COEFFICIENT:** 0.90

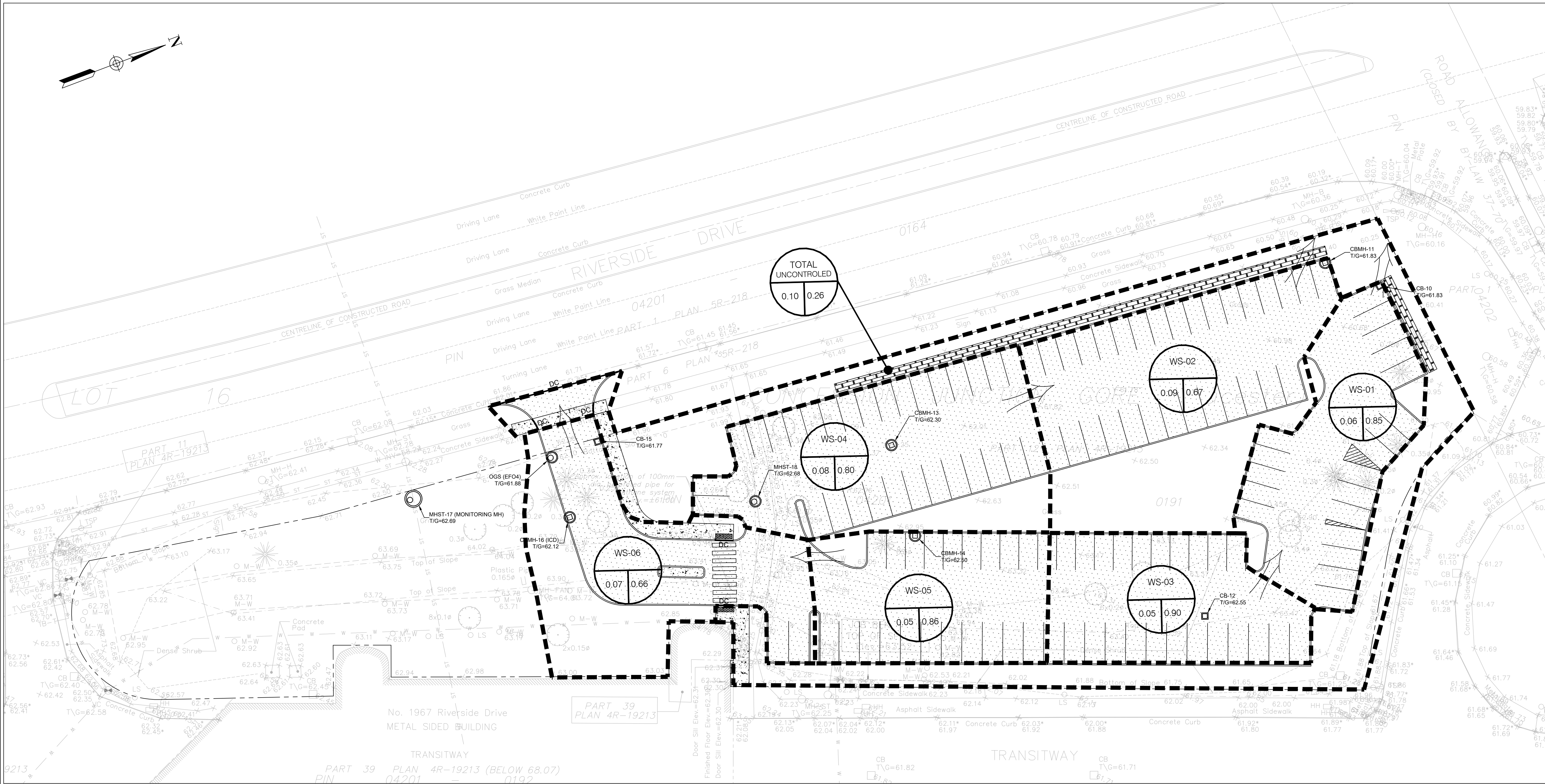

G. Wildman

GERALDINE WILDMAN
MANAGER, DEVELOPMENT REVIEW SOUTH
PLANNING, DEVELOPMENT AND BUILDING SERVICES
DEPARTMENT, CITY OF OTTAWA

APPROVED
By Geraldine Wildman at 4:18 pm, Jul 29, 2025

LEGEND:

- EXISTING PROPERTY LINE
- WATERSHED BOUNDARY
- WATERSHED NAME
- WS-XX
- 0.61 0.90
- RUNOFF COEFFICIENT
- AREA IN HECTARES
- ← EMERGENCY OVERLAND FLOW ROUTE



Surveyor

ANNIS, O'SULLIVAN, VOLLEBECK LTD.
14 CONCOURSE GATE, SUITE 500
NEPEAN, ONTARIO, K2E 7S6

TOPOGRAPHIC INFORMATION & BENCHMARK
SURVEY COMPLETED BY ANNIS, O'SULLIVAN, VOLLEBECK LTD. ON MAY 28, 2024. ELEVATIONS SHOWN ARE GEODETIC AND ARE REFERRED TO THE CGVD28 GEODETIC DATUM, DERIVED FROM CONTROL MONUMENT NO. 019680274 HAVING AN ELEVATION OF 66.322m.

BOUNDARY INFORMATION WAS COMPILED FROM PLANS 4R-19213, 4R-35573 AND 4R-36051

JOB BENCHMARK
FIRE HYDRANT TOP OF SPINDLE ALONG TRANSITWAY
ELEVATION = 63.52m

Client

The Ottawa Hospital | L'Hôpital d'Ottawa

THE OTTAWA HOSPITAL
1053 CARLING AVENUE,
OTTAWA, ONTARIO, K1Y 4E9
(613) 722-7000

PARSONS
1223 MICHAEL STREET, SUITE 100
GLOUCESTER, ONTARIO, K1J 7T2



4	RE-ISSUED FOR SPA	BV	2025/05/15	
3	RE-ISSUED FOR SPA	BV	2025/03/13	
2	RE-ISSUED FOR SPA	BV	2025/01/17	
1	ISSUED FOR SPA	BV	2024/11/08	
No.	Revision	By	Date (yy/mm/dd)	

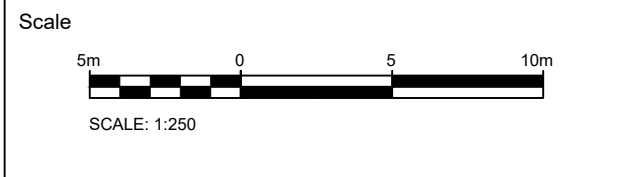

Project Title

**THE OTTAWA HOSPITAL
RIVERSIDE CAMPUS
PARKING LOT**

Drawing Title

**PARKING LOT D
POST DEVELOPMENT
DRAINAGE AREAS**

Designed by:	BV	Datum	CGVD28
Drawn by:	BV		
Approved by:	MT		
Project No.	479008	Drawing No.	C106-D