

PRELIMINARY CONSTRUCTION MANAGEMENT PLAN

Section 1

Please see below the proposed construction area.

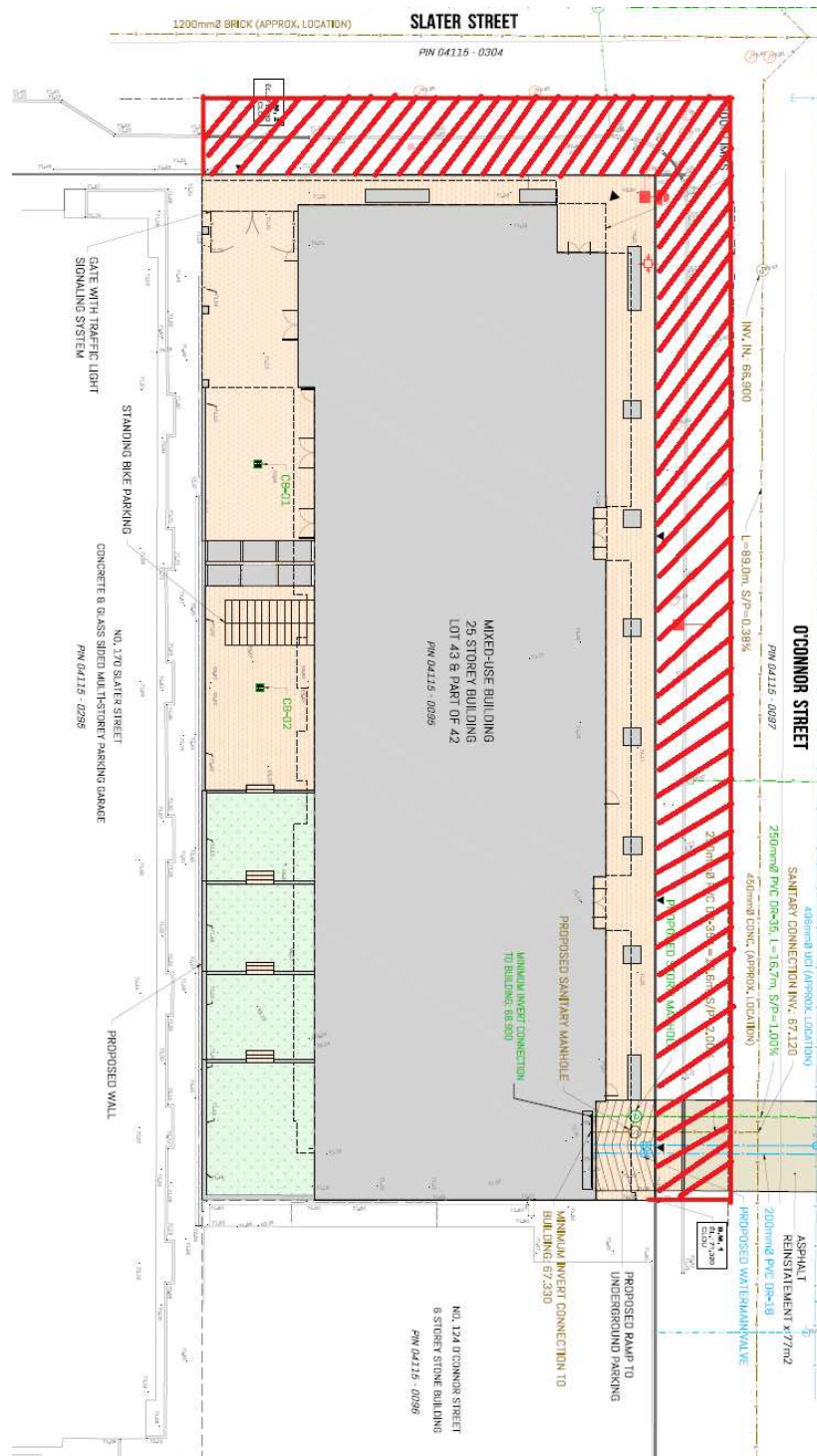

PRELIMINARY CONSTRUCTION MANAGEMENT PLAN

Section 2

1. Will construction require the temporary detour of a bus route?

The bus route located on Slater Street shouldn't be affected and that as shown by the diagram.

2. Will this work block a bike lane?

There isn't a bike lane situated next to the building, whether it's on Slater Street or O'Connor Street.

3. Will this work block a sidewalk?

Yes, a portion of sidewalks located on Slater and O'Connor Street would have to be blocked as shown by the diagram.

4. Will this work require a lane of traffic to be closed?

Yes, one line of traffic located on Slater and O'Connor Street would have to be blocked as shown by the diagram.