

WILLOW ASTER CIR.

1
L.1

TREE CONSERVATION REPORT & LANDSCAPE PLAN
SCALE: 1:500

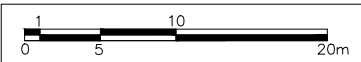

GENERAL NOTES:

- It is the responsibility of the appropriate contractor or official to report any errors, omissions or discrepancies on this plan with actual site conditions to the Landscape Architect before proceeding with construction.
- The contractor is to notify all utility companies and authorities prior to any excavation and ascertain locations of underground services.
- The contractor is to reinstate all areas and items damaged as a result of construction activity.
- The contractor is to comply with all pertinent codes and by-laws.
- The contractor is to maintain a positive surface run-off throughout the entire construction period.
- The Landscape Architect is not responsible for subsurface conditions.
- The contractor is to identify all existing trees to remain on site with the Landscape Architect prior to construction.
- The contractor is to stake the proposed location of all plant material in conjunction with the Landscape Architect prior to excavation.
- Minimum distances for selected deciduous trees are as follows:
 - Building Foundations 4.5m medium trees,
 - 7.5m large trees
 - Sidewalks 1.5m
 - Public Streets 2.5m
 - Underground Infrastructure 2.0m
- All trees within 1m of underground utility trenches are to be excavated by hand.
- Remove all protective wrapping from tree trunks after installation.
- Staking of trees shall only be performed if necessary.
- Ensure that mulch is pulled back a min. distance of 75mm from base of tree trunk.

EXISTING TREE LIST

| KEY | QTY. | BOTANICAL NAME | COMMON NAME | SIZE | CONDITION | REMARKS | OWNERSHIP | COMMENTS |
|-----|------|---------------------------|---------------------|-----------------|-----------|---------------|---------------------|--|
| 1 | 1 | <i>Picea glauca</i> | White Spruce | 720mm DBH | Fair | To be removed | 2405 Mer Bleue Road | Approx. 60% of needles on tree- in fair condition |
| 2 | 1 | <i>Picea glauca</i> | White Spruce | 450mm DBH | Fair | To be removed | 2405 Mer Bleue Road | Approx. 50% of needles on tree. In fair condition |
| 3 | 1 | <i>Acer saccharum</i> | Sugar Maple | 370mm DBH | GOOD | To be removed | 2405 Mer Bleue Road | 100% canopy- growing under OHW |
| 4 | 1 | <i>Abies balsamea</i> | Balsam Fir | 560mm DBH | FAIR | To be removed | 2405 Mer Bleue Road | Tree is in good condition |
| 5 | 1 | <i>Picea glauca</i> | White Spruce | 390mm DBH | GOOD | To be removed | 2405 Mer Bleue Road | Tree is in good condition |
| 6 | 1 | <i>Picea glauca</i> | White Spruce | 340mm DBH | GOOD | To be removed | 2405 Mer Bleue Road | Tree is in good condition |
| 7 | 1 | <i>Thuja occidentalis</i> | Eastern White Cedar | 400mm DBH | GOOD | To be removed | 2405 Mer Bleue Road | Tree is in good condition |
| 8 | 1 | <i>Picea glauca</i> | White Spruce | 540mm DBH | GOOD | To be removed | 2405 Mer Bleue Road | Tree is in good condition |
| 9 | 1 | <i>Picea glauca</i> | White Spruce | 200mm DBH | GOOD | To be removed | 2405 Mer Bleue Road | Tree is in good condition |
| 10 | 1 | <i>Picea glauca</i> | White Spruce | 250mm DBH | GOOD | To be removed | 2405 Mer Bleue Road | Tree is in good condition |
| 11 | 1 | <i>Ulmus americana</i> | American Elm | 320mm DBH | GOOD | To be removed | 2405 Mer Bleue Road | Tree is in good condition |
| 12 | 1 | <i>Picea glauca</i> | White Spruce | 480mm DBH | GOOD | To be removed | 2405 Mer Bleue Road | Tree is in good condition |
| 13 | 1 | <i>Picea glauca</i> | White Spruce | 410mm DBH | GOOD | To be removed | 2405 Mer Bleue Road | Unmaintained deciduous hedgerow- invasive species |
| 14 | 1 | <i>Picea glauca</i> | White Spruce | 490mm DBH | GOOD | To be removed | 2405 Mer Bleue Road | Approx 70% canopy- tree is in fair condition |
| 15 | 1 | <i>Pinus sylvestris</i> | Scots Pine | 140mm DBH | FAIR | To be removed | 2405 Mer Bleue Road | Tree is in fair condition- split leader |
| 16 | 1 | <i>Populus deltoides</i> | Eastern Cottonwood | 790mm DBH | FAIR | To be removed | 2405 Mer Bleue Road | Tree is in good condition |
| 17 | 1 | <i>Acer saccharum</i> | Sugar Maple | 560mm DBH | FAIR | To be removed | 2405 Mer Bleue Road | Approx. 20% canopy- tree is in poor condition |
| 18 | 1 | <i>Picea glauca</i> | White Spruce | 270mm DBH | GOOD | To be removed | 2405 Mer Bleue Road | Tree is in good condition |
| 19 | 1 | <i>Thuja occidentalis</i> | Eastern White Cedar | 6x200-250mm DBH | GOOD | To be removed | 2405 Mer Bleue Road | Tree is in good condition |
| 20 | 1 | <i>Malus domestica</i> | Apple | 170mm DBH | GOOD | To be removed | 2405 Mer Bleue Road | Tree is in good condition |
| 21 | 1 | <i>Malus domestica</i> | Apple | 210mm DBH | GOOD | To be removed | 2405 Mer Bleue Road | Tree is in good condition |
| 22 | 1 | <i>Acer saccharum</i> | Sugar Maple | 120mm DBH | GOOD | To be removed | 2405 Mer Bleue Road | Hedgerow is in good condition |
| 23 | 8 | <i>Populus deltoides</i> | Eastern Cottonwood | 100-150mm DBH | GOOD | To be removed | 2405 Mer Bleue Road | Tree is in good condition |
| 24 | 1 | <i>Picea glauca</i> | White Spruce | 390mm DBH | GOOD | To be removed | 2405 Mer Bleue Road | Tree is in good condition- invasive species |
| 25 | 1 | <i>Rhamnus cathartica</i> | Common Buckthorn | 2x120mm DBH | GOOD | To be removed | 2405 Mer Bleue Road | Tree is in good condition- can be hazardous at this size |
| 26 | 1 | <i>Populus deltoides</i> | Eastern Cottonwood | 800mm DBH | GOOD | To be removed | 2405 Mer Bleue Road | |

*DENOTES NUMEROUS

PROPOSED PLANT LIST

| KEY | QTY. | BOTANICAL NAME | COMMON NAME | SIZE | CONDITION | REMARKS |
|--------------------|------|--|---------------------------|------------|-----------|------------------|
| TREES | | | | | | |
| CS | 3 | <i>Picea pungens</i> | Colorado Spruce | 2000mm ht. | B&B | |
| * FM | 7 | <i>Acer x freemanii</i> | Freeman's Maple | 50mm cal. | B&B | Male tree |
| GB | 4 | <i>Ginkgo biloba</i> | Maidenhair Tree | 50mm cal. | B&B | |
| * HB | 3 | <i>Celtis occidentalis</i> | Hackberry | 50mm cal. | B&B | |
| * HL | 5 | <i>Gleditsia triacanthos 'Draves'</i> | Streetkeeper Honey Locust | 50mm cal. | B&B | |
| JL | 1 | <i>Syringa reticulata</i> | Japanese Tree Lilac | 50mm cal. | B&B | |
| * JV | 1 | <i>Juniperus virginiana</i> | Eastern Redcedar | 2000mm ht. | B&B | Single leader |
| * SB | 4 | <i>Amelanchier canadensis</i> | Serviceberry | 50mm cal. | B&B | |
| * SH | 3 | <i>Gleditsia triacanthos 'Shademaster'</i> | Shademaster Honey Locust | 50mm cal. | B&B | Native to S. Ont |
| * SM | 4 | <i>Acer saccharum</i> | Sugar Maple | 50mm cal. | B&B | |
| SHRUBS | | | | | | |
| AC | 26 | <i>Ribes alpinum</i> | Alpine Currant | 800 mm ht. | Potted | 1200 mm o.c. |
| JH | 18 | <i>Juniperus sabina 'Calgary Carpet'</i> | Calgary Carpet Juniper | 600mm spr. | Potted | 1000mm o.c. |
| RR | 35 | <i>Rosa rugosa</i> | Rugosa Rose | 800 mm ht. | Potted | 1200 mm o.c. |
| SF | 30 | <i>Sorbaria sorbifolia 'Sem'</i> | Sem False Spirea | 600mm ht. | Potted | 1000 mm o.c. |
| * WC | 265 | <i>Thuja occidentalis 'Clumps'</i> | Native White Cedar Clumps | 2000mm ht. | Potted | 600 mm o.c. |
| ORNAMENTAL GRASSES | | | | | | |
| BL | 52 | <i>Leymus arenarius 'Blue Dune'</i> | Blue Lyme Grass | 250mm pot | Potted | 800 mm o.c. |
| KF | 163 | <i>Calamagrostis 'Karl Foerster'</i> | Karl Foerster Grass | 250mm pot | Potted | 800 mm o.c. |
| OD | 96 | <i>Calamagrostis 'Overdam'</i> | Overdam Grass | 250mm pot | Potted | 800 mm o.c. |

ALL PLANT MATERIAL IS PROPOSED ON PRIVATE PROPERTY
*INDICATES NATIVE SPECIES

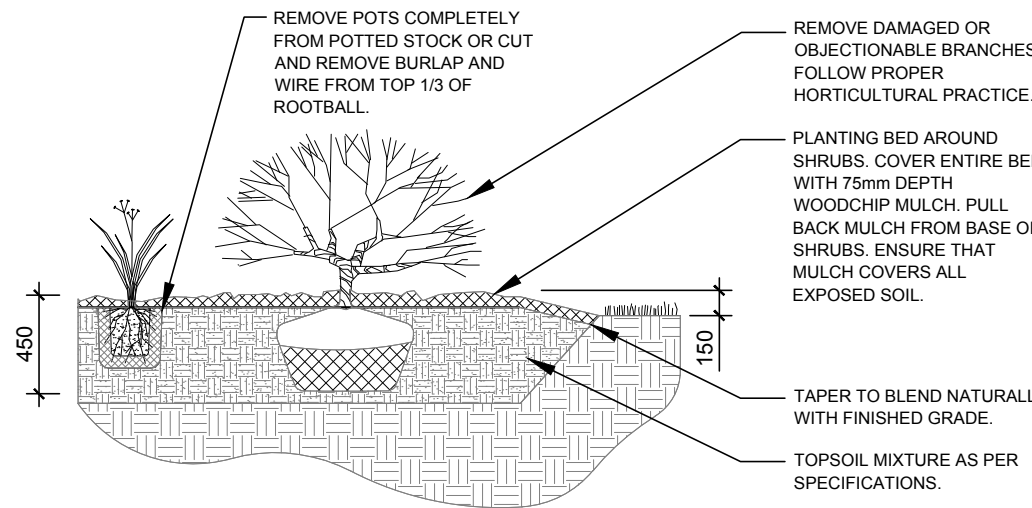

2
L.1

SHRUB / PERENNIAL PLANTING
SCALE: NTS

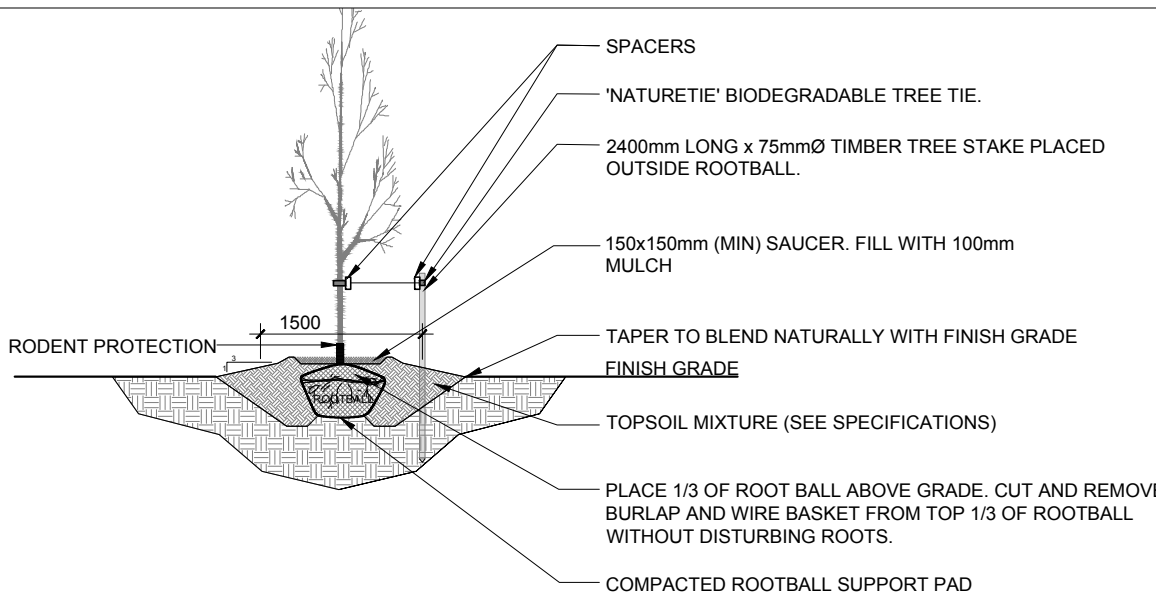

3
L.1

DECIDUOUS TREE PLANTING
SCALE: NTS

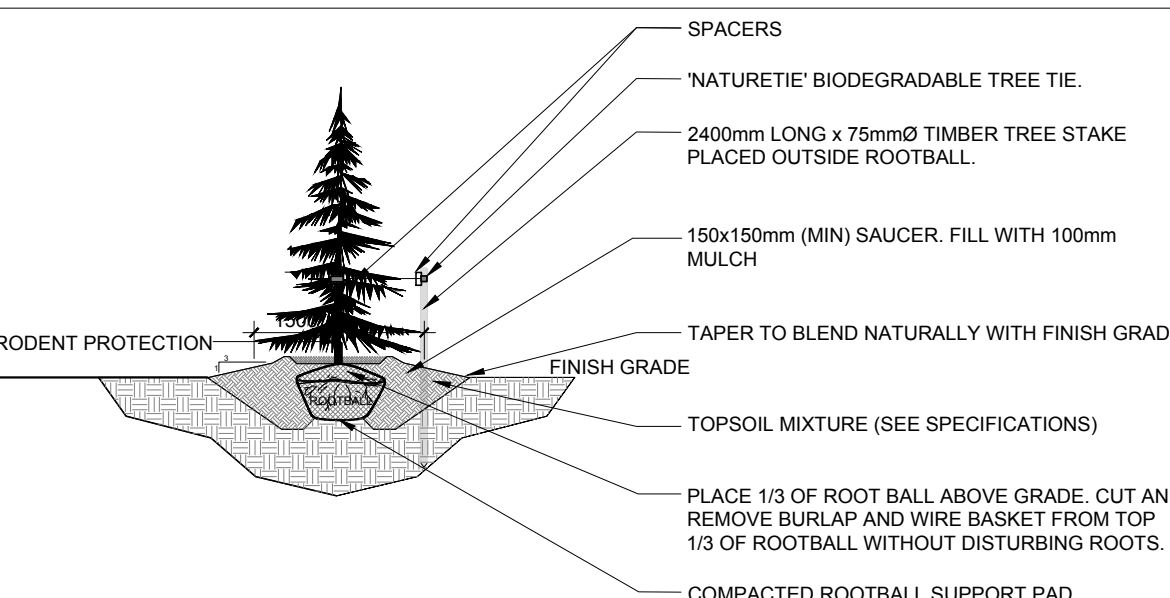

4
L.1

CONIFEROUS TREE PLANTING
N.T.S.

CLIENT

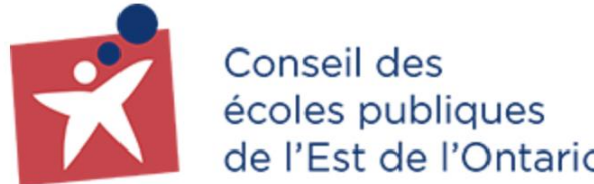

CONSULTANTS
ARCHITECTS

grc architects

47 Carleton Place, Suite 401,
Ottawa, Ontario K1P 1H1
Tel: (613) 241-2000, 1883-341-1180
info@grcarchitects.com www.grcarchitects.com

CIVIL
ENGINEERS



ENGINEERING | INGÉNIÉRIE

5430 Canotek Road | Ottawa, ON, K1J 9G2
www.lrl.ca | (613) 842-3434

SURVEYORS

Callon Dietz INCORPORATED

ONTARIO LAND SURVEYORS
CARLETON PLACE LONDON NORTH BAY
Requests: callondietz.com callondietz.com

LEGEND

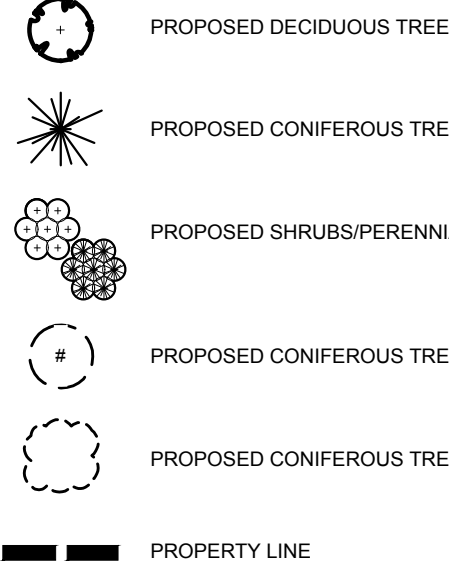
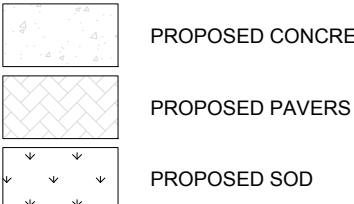

| | | | | |
|--|------------------------------------|------------|----------|-------|
| 4 | ISSUED FOR 66% REVIEW | 01/31/2025 | ML | JL |
| 3 | ISSUED FOR DISCUSSION AND REVIEW | 01/29/2025 | ML | JL |
| 2 | ISSUED AS PER ARCHITECTS COMMENTS | 01/24/2025 | CAT | JL |
| 1 | REVIEWED FOR DISCUSSION AND REVIEW | 12/13/2024 | ML | JL |
| No. | Issue | Date | MM/DD/YY | DR CK |
| JAMES B. LENNOX & ASSOCIATES INC. LANDSCAPE ARCHITECTS 3332 CARLING AVE. OTTAWA, ONTARIO K2H 5A8 Tel. (613) 722-5168 Fax. (1866) 343-3942 | | | | |

PROJECT

PROPOSED HIGH SCHOOL- ESP ORLEANS SUD
2405 MER BLEUE ROAD, OTTAWA ON

DRAWING

TREE CONSERVATION REPORT &
LANDSCAPE PLAN

STAMP

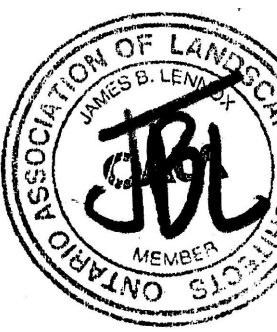

SCALE

AS SHOWN

START DATE

OCTOBER 2024

PROJECT NO.

DRAWING NO.

L.1

PLOT SIZE ARCH-D