

1 LANDSCAPE PLAN
SCALE 1:500

CLIENT: CLARIDGE HOMES (BANK ST.) INC.
2051-210 ELKSTONE AVE., OTTAWA, ON
Tel: (613) 223-6030

LOCATION PLAN

CONSULTANTS

ARCHITECTS: XXXX
XXXX
Tel: (613)

CIVIL ENGINEERS: IBI GROUP
400-333 Preston Street, Ottawa, ON K1S 9M4
Tel: (613) 225-1311

LEGEND

PROPOSED TREES - QUANTITY	QUANTITY
Deciduous Gleditsia tricanthos var. inermis 'Shademaster' / Shademaster Honeylocust 60mm ø B&B	4
Celtis occidentalis / Hackberry 60mm ø B&B	7
Syringa reticulata 'Ivory Silk' / Japanese Tree Lilac 60mm ø B&B	6
Tilia cordata 'Corzam' / Cormthian Littleleaf Linden 60mm ø B&B	5
Amelanchier canadensis / Shadblow Serviceberry 60mm ø B&B	7
Amelanchier laevis 'Spring Flurry' / Spring Flurry Serviceberry 60mm ø B&B	5
Acer saccharum / Sugar Maple 60mm ø B&B	4
PROPOSED 1.5m HI. WOOD SCREEN FENCE	

2	REVISED AS PER CITY COMMENTS	07/04/2019	LC	JL
1	ISSUED FOR SITE PLAN APPROVAL	05/23/2019	LC	JL
No.	Issue	Date	DR	CK

JAMES B. LENNOX & ASSOCIATES INC.
LANDSCAPE ARCHITECTS
3333 CARLING AVE. OTTAWA, ONTARIO K2H 5A8
Tel: (613) 722-5168 Fax: (866) 343-3942

PROJECT
LILYTHORNE
PHASE I

DRAWING
LANDSCAPE PLAN

STAMP

SCALE
AS SHOWN

START DATE
NOVEMBER, 2018

PROJECT NO.
19-CLG-1919

PROJECT NORTH

DRAWING NO.
L.1

PLOT SIZE ARCH-D

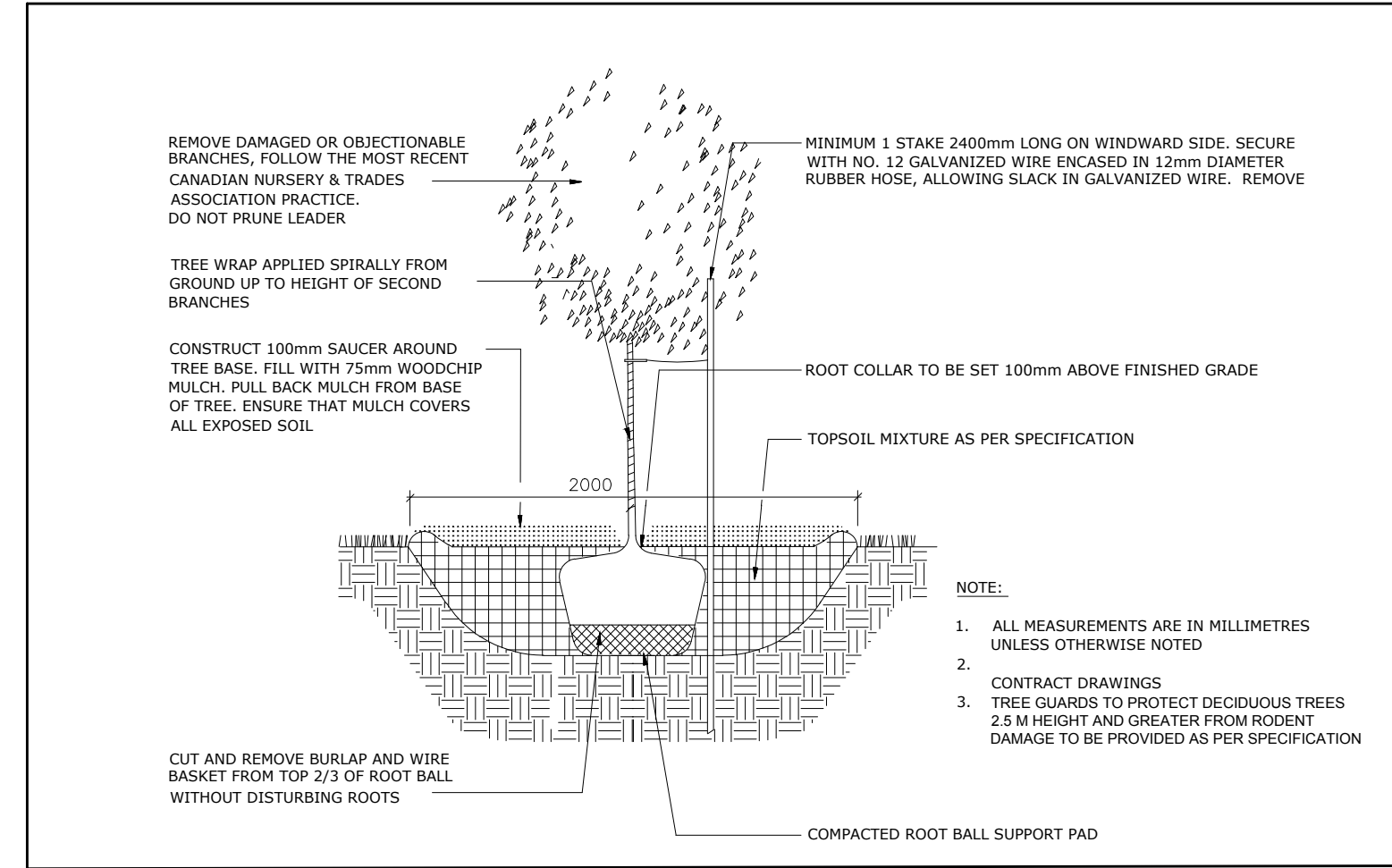

2 DECIDUOUS TREE PLANTING
SCALE: NTS

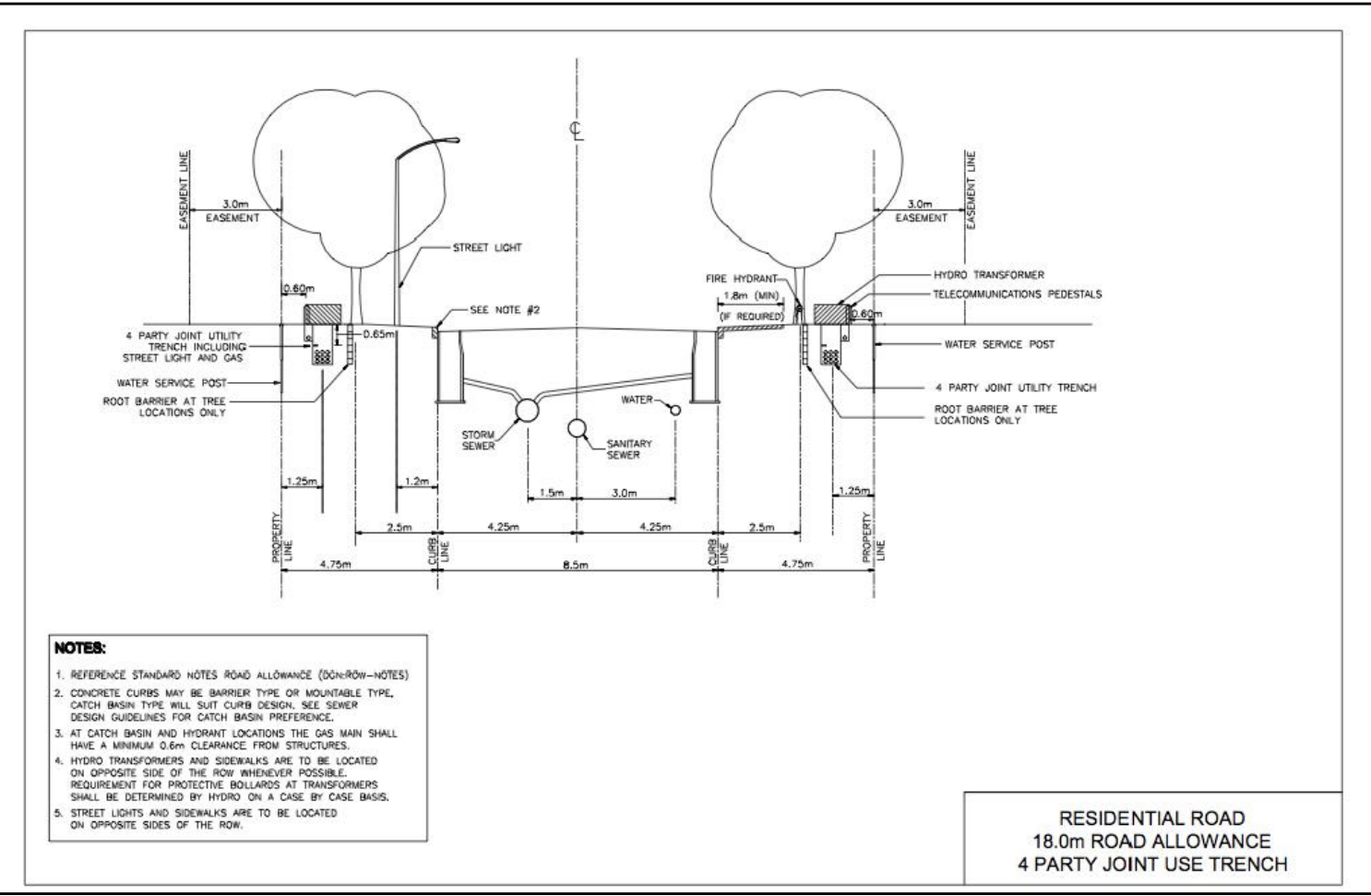

3 RESIDENTIAL ROAD 18.0m ROAD ALLOWANCE 4 PARTY JOINT USE TRENCH
SCALE: NTS

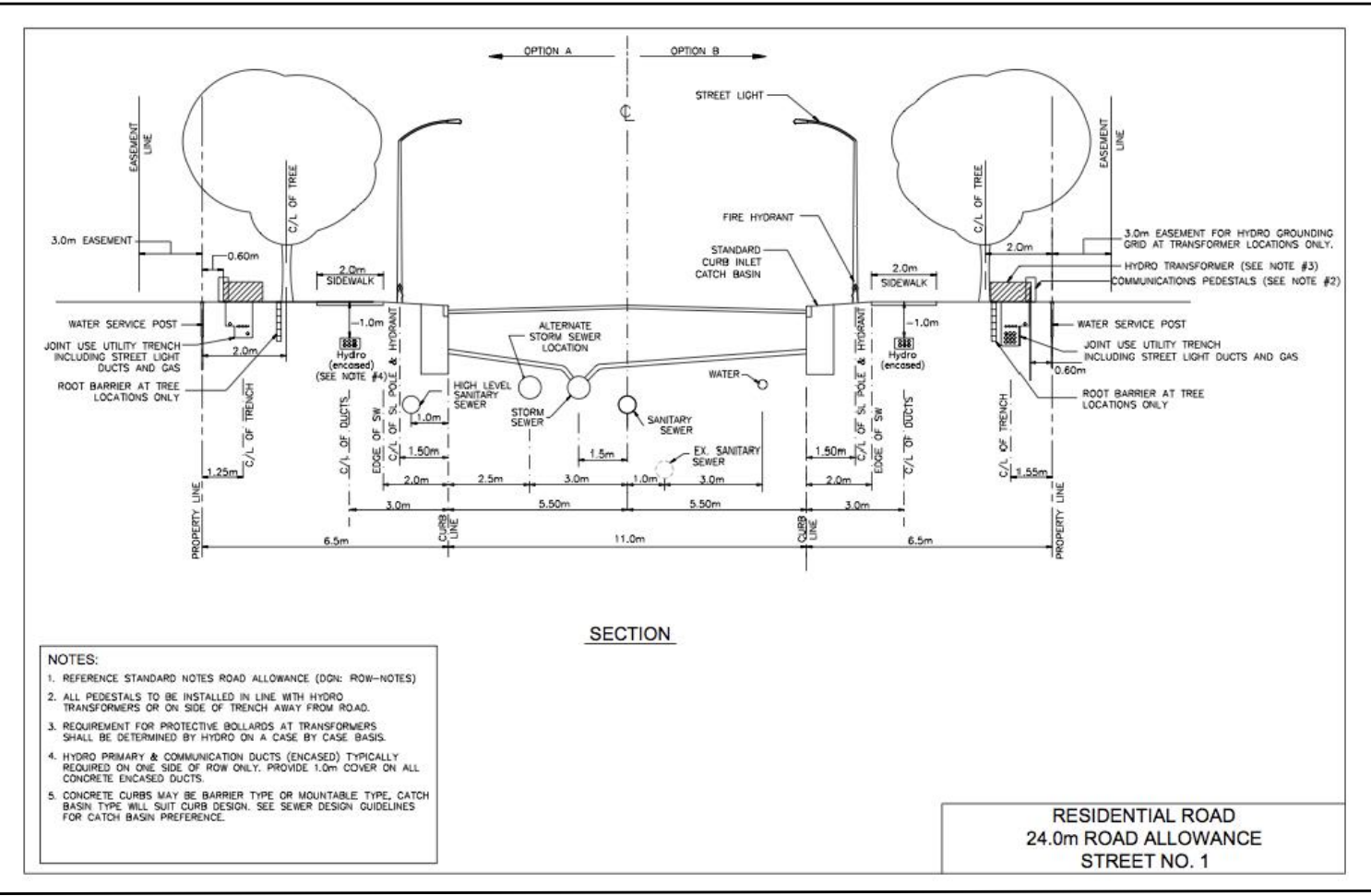

4 RESIDENTIAL ROAD 24.0m ROAD ALLOWANCE STREET NO. 1
SCALE: NTS

- GENERAL NOTES:**
- It is the responsibility of the appropriate contractor or official to report any errors, omissions or discrepancies on this plan with actual site conditions to the Landscape Architect before proceeding with construction.
 - The contractor is to notify all utility companies and authorities prior to any excavation and ascertain locations of underground services.
 - The contractor is to reinstatement all areas and items damaged as a result of construction activity.
 - The contractor is to comply with all pertinent codes and by-laws.
 - The contractor is to maintain a positive surface run-off throughout the entire construction period.
 - The Landscape Architect is not responsible for subsurface conditions.
 - The contractor is to identify all existing trees to remain on site with the Landscape Architect prior to construction.
 - The contractor is to stake the proposed location of all plant material in conjunction with the Landscape Architect prior to excavation.
 - Minimum distances for selected deciduous trees are as follows:
 - Building Foundations 7.5m
 - Sidewalks 1.5m
 - Public Streets 2.5m
 - Underground Infrastructure 2.0m
 - All trees within 1m of underground utility trenches are to be excavated by hand.
 - Remove all protective wrapping from tree trunks after installation.
 - Staking of trees shall only be performed if necessary.
 - Ensure that mulch is pulled back a min. distance of 75mm from base of tree trunk.

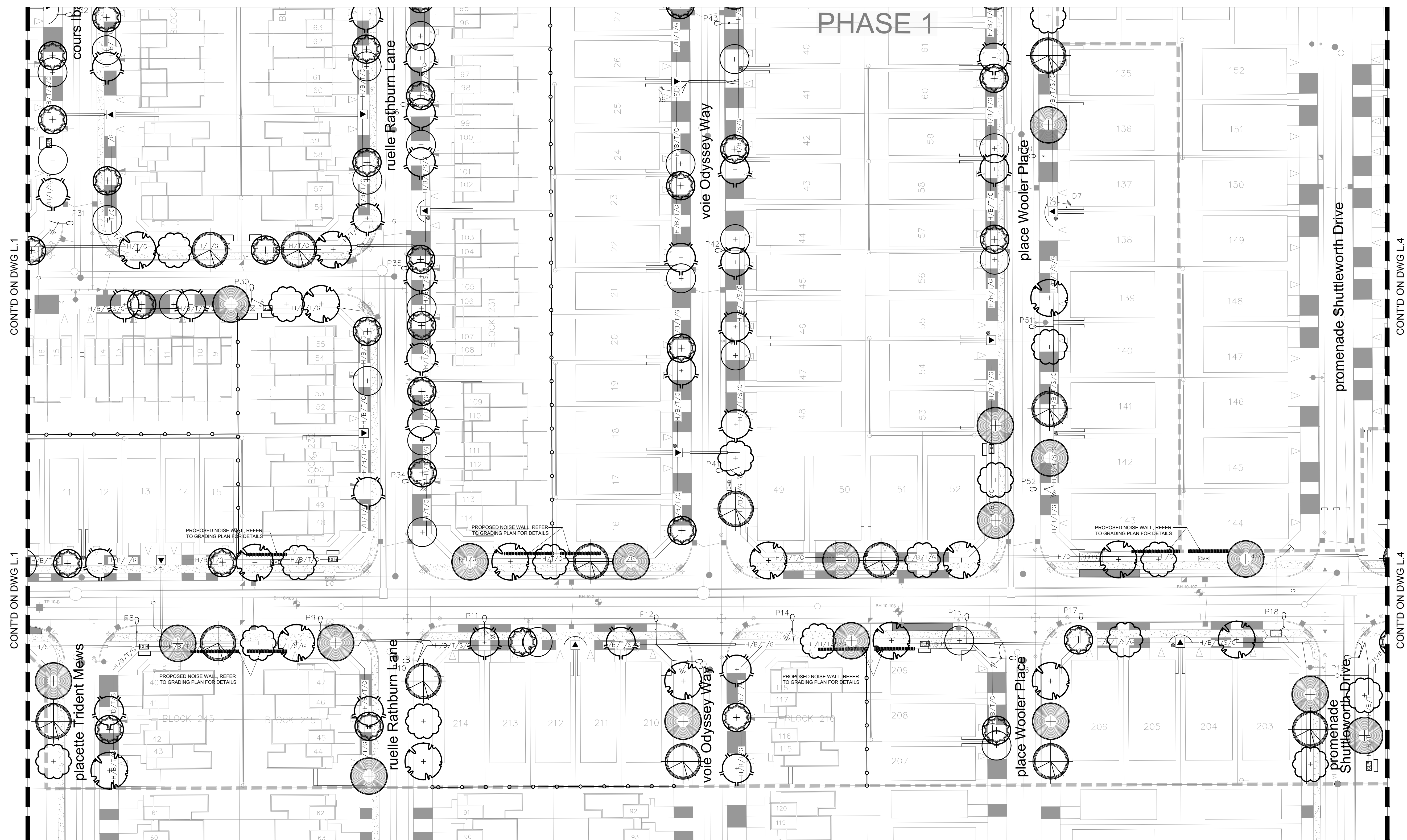

CONT'D ON DWG L.1

CONT'D ON DWG L.1

CONT'D ON DWG L.4

CONT'D ON DWG L.4

1 LANDSCAPE PLAN
SCALE 1:500

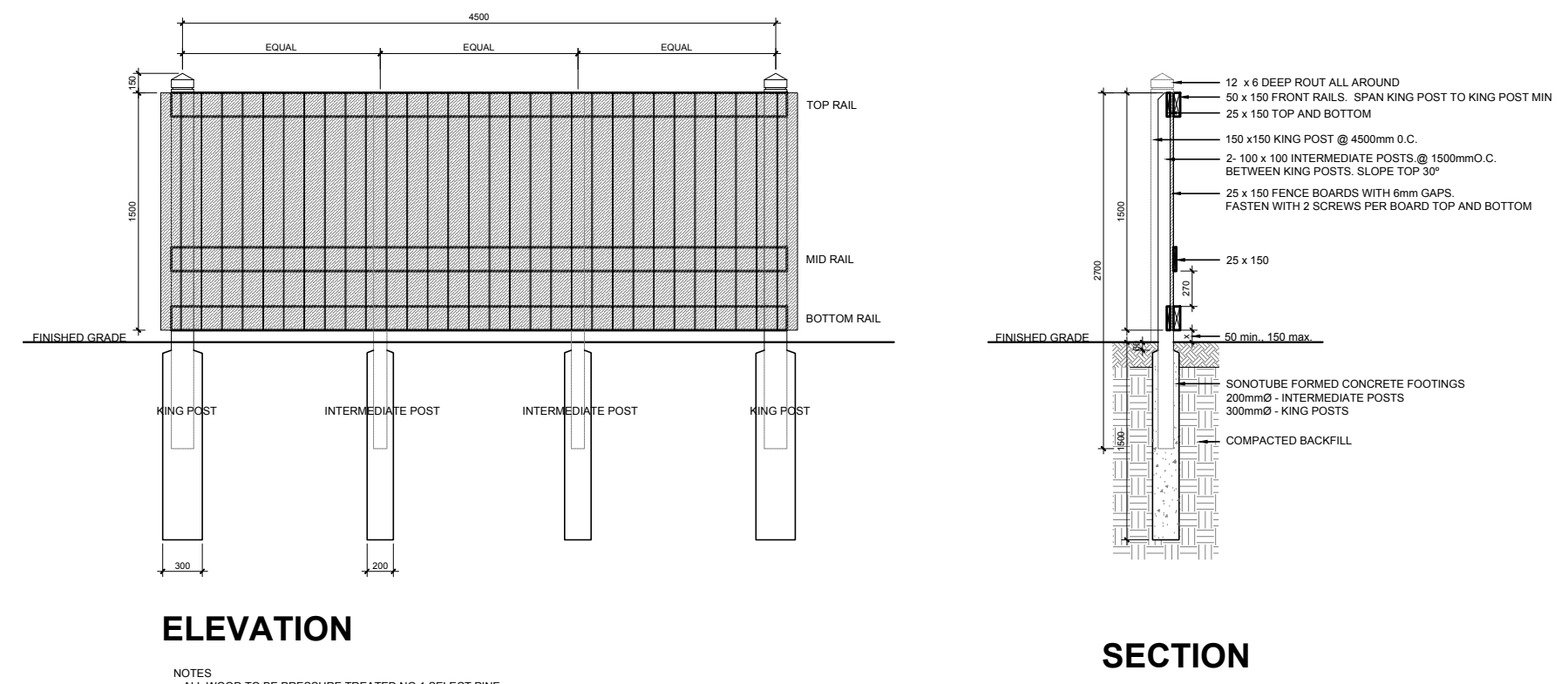

ELEVATION
SECTION
2 1.5m ht. WOOD SCREEN FENCE
N.T.S.

- GENERAL NOTES:**
- It is the responsibility of the appropriate contractor or official to report any errors, omissions or discrepancies on this plan with actual site conditions to the Landscape Architect before proceeding with construction.
 - The contractor is to notify all utility companies and authorities prior to any excavation and ascertain locations of underground services.
 - The contractor is to reinstatement all areas and items damaged as a result of construction activity.
 - The contractor is to comply with all pertinent codes and by-laws.
 - The contractor is to maintain a positive surface run-off throughout the entire construction period.
 - The Landscape Architect is not responsible for subsurface conditions.
 - The contractor is to identify all existing trees to remain on site with the Landscape Architect prior to construction.
 - The contractor is to stake the proposed location of all plant material in conjunction with the Landscape Architect prior to construction.
 - Minimum distances for selected deciduous trees are as follows:
 - Building Foundations 7.5m
 - Sidewalks 1.5m
 - Public Streets 2.5m
 - Underground Infrastructure 2.0m
 - All trees within 1m of underground utility trenches are to be excavated by hand.
 - Remove all protective wrapping from tree trunks after installation.
 - Staking of trees shall only be performed if necessary.
 - Ensure that mulch is pulled back a min. distance of 75mm from base of tree trunk.

CLIENT: CLARIDGE HOMES (BANK ST.) INC.
201-210 ELGIN ST. AVE., OTTAWA, ON
Tel: (613) 223-6030

LOCATION PLAN

CONSULTANTS

ARCHITECTS: XXXX
XXXX
Tel: (613)

CIVIL ENGINEERS: IBI GROUP
450-333 Preston Street, Ottawa, ON K1S 9M4
Tel: (613) 225-1311

LEGEND

PROPOSED TREES - QUANTITY	QUANTITY
DECIDUOUS Gleditsia tricanthos var. inermis 'Shademaster' / Shademaster Honeylocust 60mm ø B&B	16
Celtis occidentalis / Hackberry 60mm ø B&B	18
Syringa reticulata 'Ivory Silk' / Japanese Tree Lilac 60mm ø B&B	29
Tilia cordata 'Corzam' / Cormthian Littleleaf Linden 60mm ø B&B	17
Amelanchier canadensis / Shadblow Serviceberry 60mm ø B&B	28
Amelanchier laevis 'Spring Flurry' / Spring Flurry Serviceberry 60mm ø B&B	23
Acer saccharum / Sugar Maple 60mm ø B&B	13
PROPOSED 1.5m HT. WOOD SCREEN FENCE	

2	REVISED AS PER CITY COMMENTS	07/04/2019	LC	JL
1	ISSUED FOR SITE PLAN APPROVAL	05/23/2019	LC	JL
No.	Issue	Date	DR	CK

JAMES B. LENNOX & ASSOCIATES INC.
LANDSCAPE ARCHITECTS
3333 CARLING AVE. OTTAWA, ONTARIO K2H 5A8
Tel: (613) 722-5168 Fax: (613) 343-3942

PROJECT
LILYTHORNE
PHASE I

DRAWING
LANDSCAPE PLAN

STAMP
ASSOCIATION OF LANDSCAPE ARCHITECTS
MEMBER

SCALE
AS SHOWN

START DATE
NOVEMBER, 2018

PROJECT NO.
19-CLG-1919

PROJECT NORTH

DRAWING NO.
L.2

PLOT SIZE ARCH-D



1 LANDSCAPE PLAN
L.3 SCALE 1:500

CONT'D ON DWG L.2

CONT'D ON DWG L.2

CONT'D ON DWG L.2

GENERAL NOTES:

- It is the responsibility of the appropriate contractor or official to report any errors, omissions or discrepancies on this plan with actual site conditions to the Landscape Architect before proceeding with construction.
- The contractor is to notify all utility companies and authorities prior to any excavation and ascertain locations of underground services.
- The contractor is to reinstate all areas and items damaged as a result of construction activity.
- The contractor is to comply with all pertinent codes and by-laws.
- The contractor is to maintain a positive surface run-off throughout the entire construction period.
- The Landscape Architect is not responsible for subsurface conditions.
- The contractor is to identify all existing trees to remain on site with the Landscape Architect prior to construction.
- The contractor is to stake the proposed location of all plant material in conjunction with the Landscape Architect prior to excavation.
- Minimum distances for selected deciduous trees are as follows:
 - Building Foundations 7.5m
 - Sidewalks 1.5m
 - Public Streets 2.5m
 - Underground Infrastructure 2.0m
- All trees within 1m of underground utility trenches are to be excavated by hand.
- Remove all protective wrapping from tree trunks after installation.
- Staking of trees shall only be performed if necessary.
- Ensure that mulch is pulled back a min. distance of 75mm from base of tree trunk.

CLIENT: CLARIDGE HOMES (BANK ST.) INC.
201-210 ELKSTONE AVE., OTTAWA, ON
Tel: (613) 223-6030

LOCATION PLAN

CONSULTANTS

ARCHITECTS: XXXX
XXXX
Tel: (613)

CIVIL ENGINEERS: IBI GROUP
450-133 Preston Street, Ottawa, ON K1S 0A4
Tel: (613) 225-1311

LEGEND

PROPOSED TREES - DECIDUOUS	QUANTITY
Gleditsia tricanthos var. inermis 'Shademaster' / Shademaster Honeylocust 60mm ø B&B	9
Celtis occidentalis / Hackberry 60mm ø B&B	9
Syringa reticulata 'Ivory Silk' / Japanese Tree Lilac 60mm ø B&B	18
Tilia cordata 'Corzam' / Cornelian Littleleaf Linden 60mm ø B&B	6
Amelanchier canadensis / Shadblow Serviceberry 60mm ø B&B	16
Amelanchier laevis 'Spring Flurry' / Spring Flurry Serviceberry 60mm ø B&B	16
Acer saccharum / Sugar Maple 60mm ø B&B	5
PROPOSED 1.5m HT. WOOD SCREEN FENCE	

2	REVISED AS PER CITY COMMENTS	07/04/2019	LC	JL
1	ISSUED FOR SITE PLAN APPROVAL	05/23/2019	LC	JL
No.	Issue	Date	DR	CK

JAMES B. LENNOX & ASSOCIATES INC.
LANDSCAPE ARCHITECTS
3333 CARLING AVE. OTTAWA, ONTARIO K2H 5A8
Tel: (613) 722-5168 Fax: (866) 343-3942

PROJECT

LILYTHORNE
PHASE I

DRAWING

LANDSCAPE PLAN

STAMP

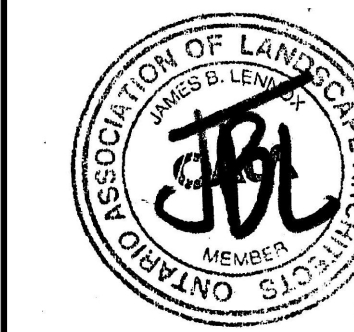

SCALE

AS SHOWN

START DATE

NOVEMBER, 2018

PROJECT NO.

19-CLG-1919

PROJECT NORTH

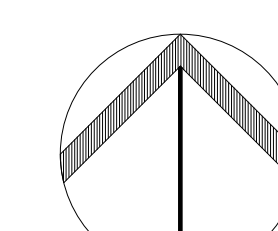

DRAWING NO.

L.3

PLOT SIZE ARCH-D



CONT'D ON DWG L.2

1 LANDSCAPE PLAN
L.4 SCALE 1:500

- GENERAL NOTES:**
- It is the responsibility of the appropriate contractor or official to report any errors, omissions or discrepancies on this plan with actual site conditions to the Landscape Architect before proceeding with construction.
 - The contractor is to notify all utility companies and authorities prior to any excavation and ascertain locations of underground services.
 - The contractor is to reinstate all areas and items damaged as a result of construction activity.
 - The contractor is to comply with all pertinent codes and by-laws.
 - The contractor is to maintain a positive surface run-off throughout the entire construction period.
 - The Landscape Architect is not responsible for subsurface conditions.
 - The contractor is to identify all existing trees to remain on site with the Landscape Architect prior to construction.
 - The contractor is to stake the proposed location of all plant material in conjunction with the Landscape Architect prior to excavation.
 - Minimum distances for selected deciduous trees are as follows:
 - Building Foundations 7.5m
 - Sidewalks 1.5m
 - Public Streets 2.5m
 - Underground Infrastructure 2.0m
 - All trees within 1m of underground utility trenches are to be excavated by hand.
 - Remove all protective wrapping from tree trunks after installation.
 - Staking of trees shall only be performed if necessary.
 - Ensure that mulch is pulled back a min. distance of 75mm from base of tree trunk.

CLIENT: CLARIDGE HOMES (BANK ST.) INC.
2051-210 ELKSTONE AVE., OTTAWA, ON
Tel: (613) 225-6030

LOCATION PLAN

CONSULTANTS

ARCHITECTS: XXXX
XXXX
Tel: (613)

CIVIL ENGINEERS: IBI GROUP
400-333 Preston Street, Ottawa, ON K1S 9M4
Tel: (613) 225-1311

LEGEND

PROPOSED TREES - DECIDUOUS	QUANTITY
Gleditsia tricanthos var. inermis 'Shademaster' / Shademaster Honeylocust 60mm ø B&B	8
Celtis occidentalis / Hackberry 60mm ø B&B	10
Syringa reticulata 'Ivory Silk' / Japanese Tree Lilac 60mm ø B&B	4
Tilia cordata 'Corzam' / Cornelian Littleleaf Linden 60mm ø B&B	6
Amelanchier canadensis / Shadblow Serviceberry 60mm ø B&B	1
Amelanchier laevis 'Spring Flurry' / Spring Flurry Serviceberry 60mm ø B&B	2
Acer saccharum / Sugar Maple 60mm ø B&B	7

No.	Issue	Date	DR	CK
2	REVISED AS PER CITY COMMENTS	07/04/2019	LC	JL
1	ISSUED FOR SITE PLAN APPROVAL	05/23/2019	LC	JL

JAMES B. LENNOX & ASSOCIATES INC.
LANDSCAPE ARCHITECTS
3333 CARLING AVE. OTTAWA, ONTARIO K2H 5A8
Tel: (613) 722-5168 Fax: (866) 343-3942

PROJECT
LILYTHORNE
PHASE I

DRAWING
LANDSCAPE PLAN

STAMP

SCALE
AS SHOWN

START DATE
NOVEMBER, 2018

PROJECT NO.
19-CLG-1919

PROJECT NORTH

DRAWING NO.
L.4

PLOT SIZE ARCH-D