

Copyright Reserved

The Contractor shall verify and be responsible for all dimensions. DO NOT scale the drawing - any errors or omissions shall be reported to Stantec without delay.
The Copyrights to all designs and drawings are the property of Stantec. Reproduction or use for any purpose other than that authorized by Stantec is forbidden.

Legend

- PROPOSED TRUNK SANITARY SEWER
- EXISTING TRUNK SANITARY SEWER
- SANITARY DRAINAGE BOUNDARY
- EXISTING SANITARY DRAINAGE BOUNDARY
- AREA ID
- POPULATION
- SANITARY DRAINAGE AREA (ha)
- FUTURE AREA ID
- FUTURE POPULATION
- FUTURE SANITARY DRAINAGE AREA (ha)
- EXISTING AREA ID
- EXISTING POPULATION
- EXISTING SANITARY DRAINAGE AREA (ha)

Notes

ULTIMATE CONTRIBUTION FROM EXISTING MAHOGANY ESTATES:
AREA=36.7ha
POPULATION=530

Area = 2.85 Ha

EXISTING SANITARY DRAINAGE AREAS
MAHOGANY PHASE 1:
211 SINGLE UNITS, 19.67ha
EXISTING DEVELOPMENT EAST OF MAHOGANY MAIN:
18 SINGLE UNITS, 10.7ha
EXISTING DEVELOPMENT WEST OF MAHOGANY MAIN:
20 SINGLE UNITS, 12.9ha
EXISTING PHASE 1 OF MAHOGANY DEVELOPMENT

2	REVISED PER CITY COMMENTS	DT	DT	18.04.25
1	ISSUED FOR DRAFT PLAN APPROVAL	DT	DT	17.06.16

Revision By Appd. YFMMDD

File Name:	160410140-DB	DT	AMP	DT	17.05.17
		Dim.	Chkd.	Desgn.	YFMMDD

Permit Seal

Client/Project
MINTO GROUP INC.

MAHOGANY SUBDIVISION
PHASES 2-4
OTTAWA, ON

Title
CONCEPTUAL
SANITARY DRAINAGE
PLAN

Project No. 160410140
Scale 1:1500

Drawing No. Sheet Revision

SA-1 5 of 9 2

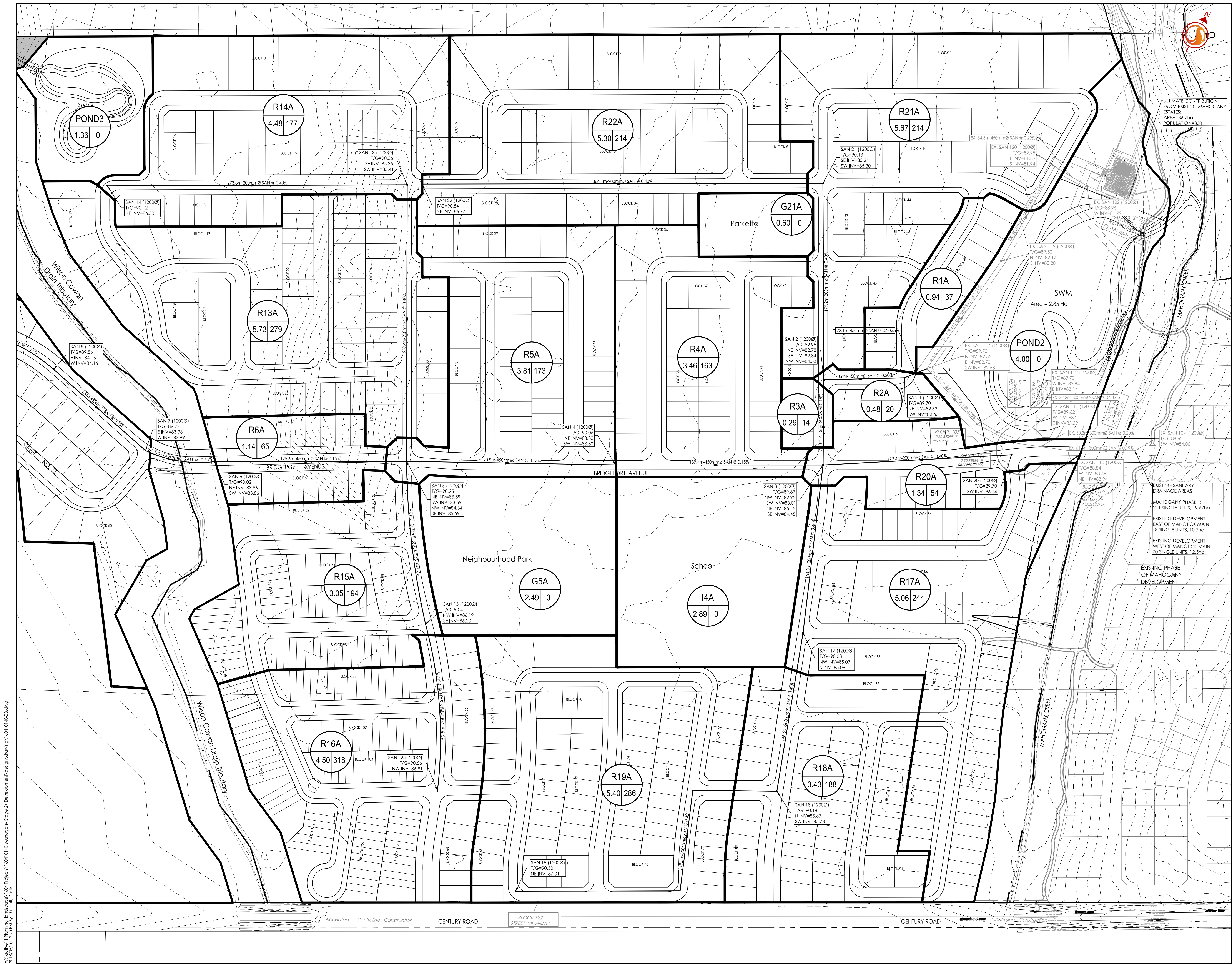

W:\active\160410140\160410140_Plan\160410140_Mahogany_Phase_2-4_Development\Design\Drawings\160410140-DB.dwg
25/05/2015 12:25 PM By: [Name]