

Copyright Reserved

The Contractor shall verify and be responsible for all dimensions. DO NOT scale the drawing - any errors or omissions shall be reported to Stantec without delay.
The Copyrights to all designs and drawings are the property of Stantec. Reproduction or use for any purpose other than that authorized by Stantec is forbidden.

Legend

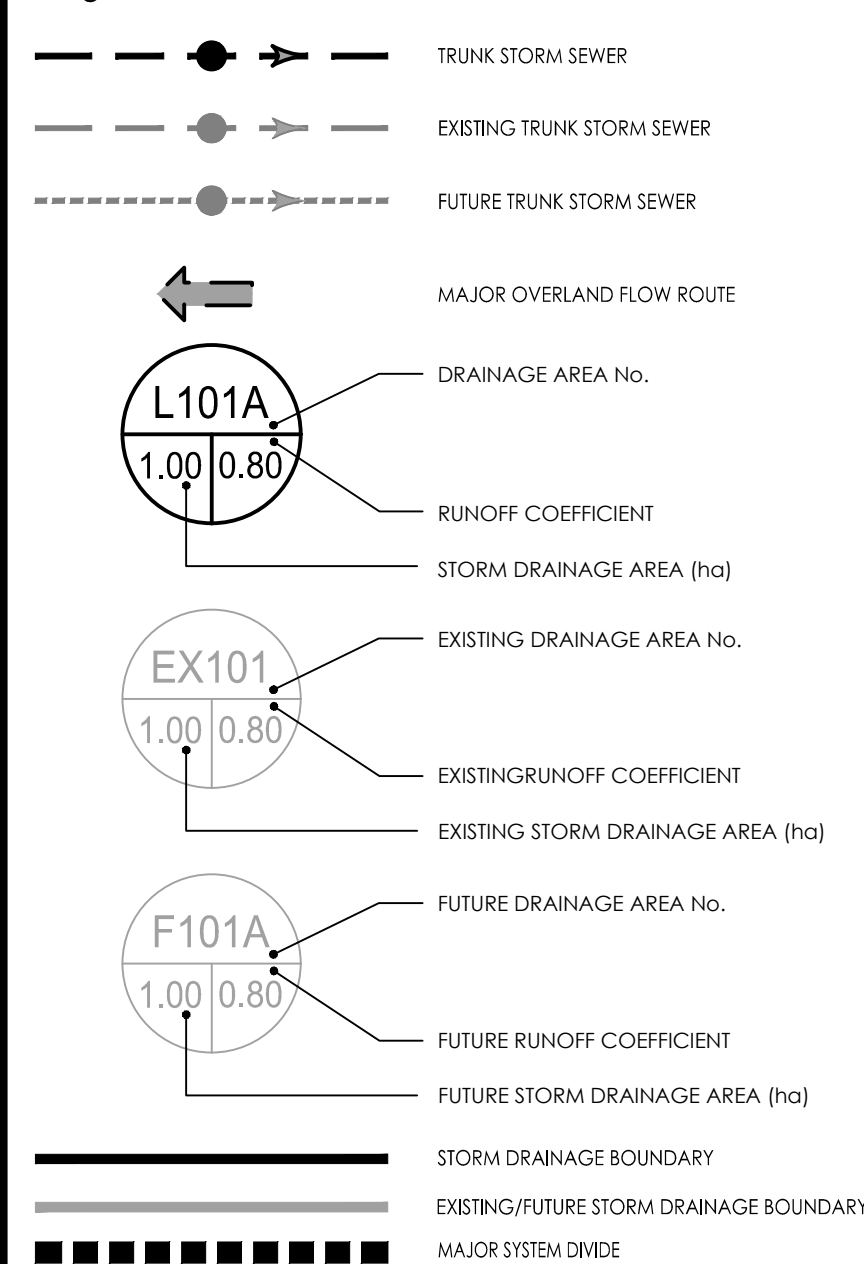

Notes

- SCHOOL AREA L105B TO RESTRICT MINOR SYSTEM PEAK FLOWS TO 48L/s AND TO PROVIDE ON-SITE STORAGE FOR UP TO THE 100-YEAR EVENT.
- AREA L207A TO REQUIRE SUMP PUMPS AND BACKWATER VALVES AND/OR ALTERNATE FOOTING DESIGN TO BE CONFIRMED AT THE DETAILED DESIGN STAGE.

2	REVISED PER CITY COMMENTS	DT	DT	18.04.25
1	ISSUED FOR DRAFT PLAN APPROVAL	DT	DT	17.06.16

Revision	By	Appd.	YY.MM.DD
----------	----	-------	----------

File Name:	160410140-DB	DT	AMP	DT	17.05.17
		Desn.	Chkd.	Desn.	YY.MM.DD

Permit-Seal

Client/Project
MINTO GROUP INC.

MAHOGANY SUBDIVISION
PHASES 2-4
OTTAWA, ON

Title
CONCEPTUAL
STORM DRAINAGE
PLAN

Project No.	Scale
160410140	0 15 45 75m 1:1500

Drawing No.	Sheet	Revision
ST-1	3 of 9	2

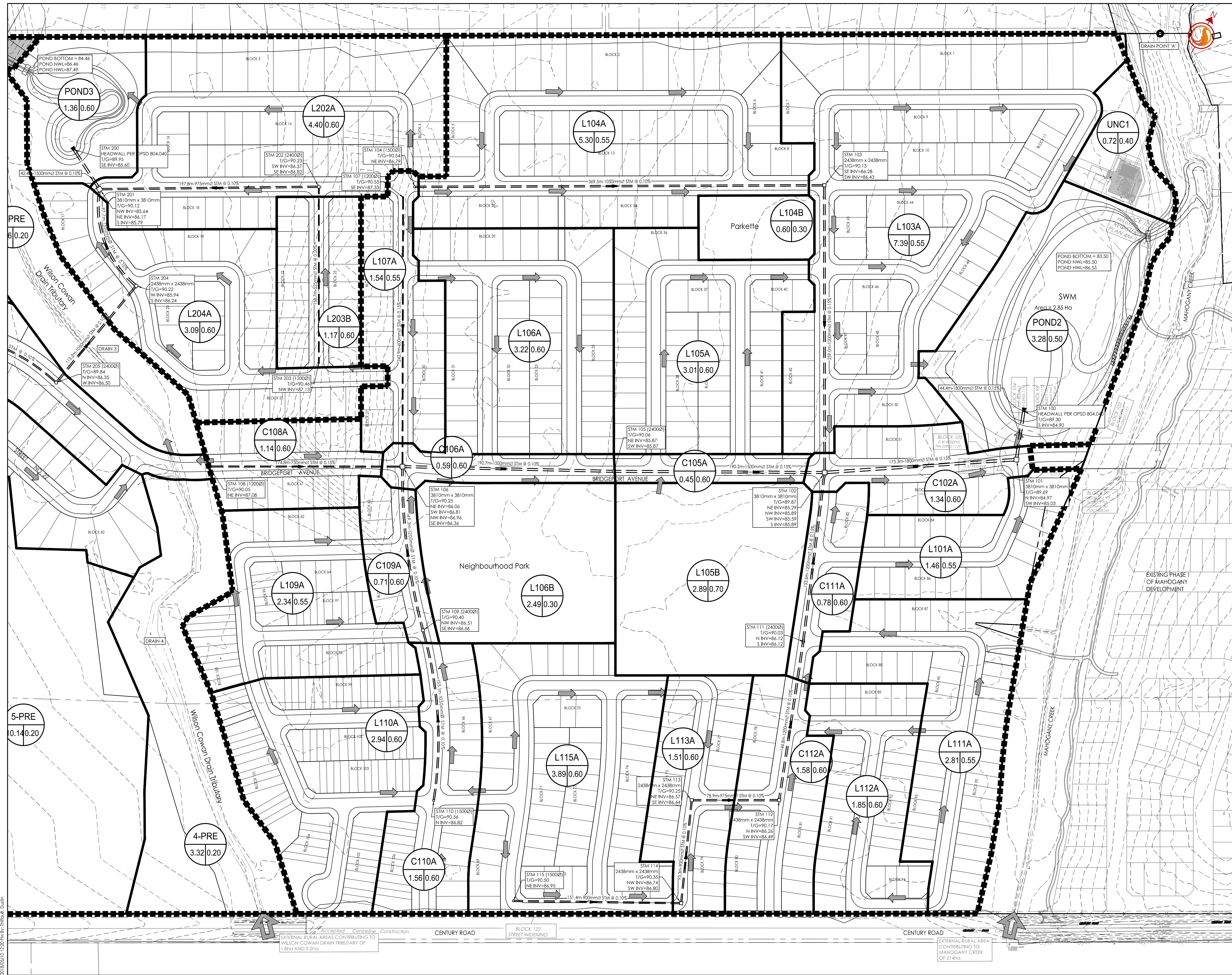

W:\active\17_Planing_Engineering\1604 Project\160410140_Mahogany Subdiv\Design\Drawings\160410140-DB.dwg
25/05/2017 12:25 PM By: [Name]