

LEGEND

- DRAINAGE AREA BOUNDARY
- 0.24
A5
0.43
- CATCHMENT AREA (ha)
AREA ID
RUNOFF COEFFICIENT
- EMERGENCY OVERLAND FLOW
- PROPOSED STORM SEWER C/W FLOW DIRECTION
- PROPOSED STORM MH

NORTH

KEY PLAN
N.T.S.

SITE BENCHMARK
REFERENCED TO LOCAL
GEODESIC DATUM

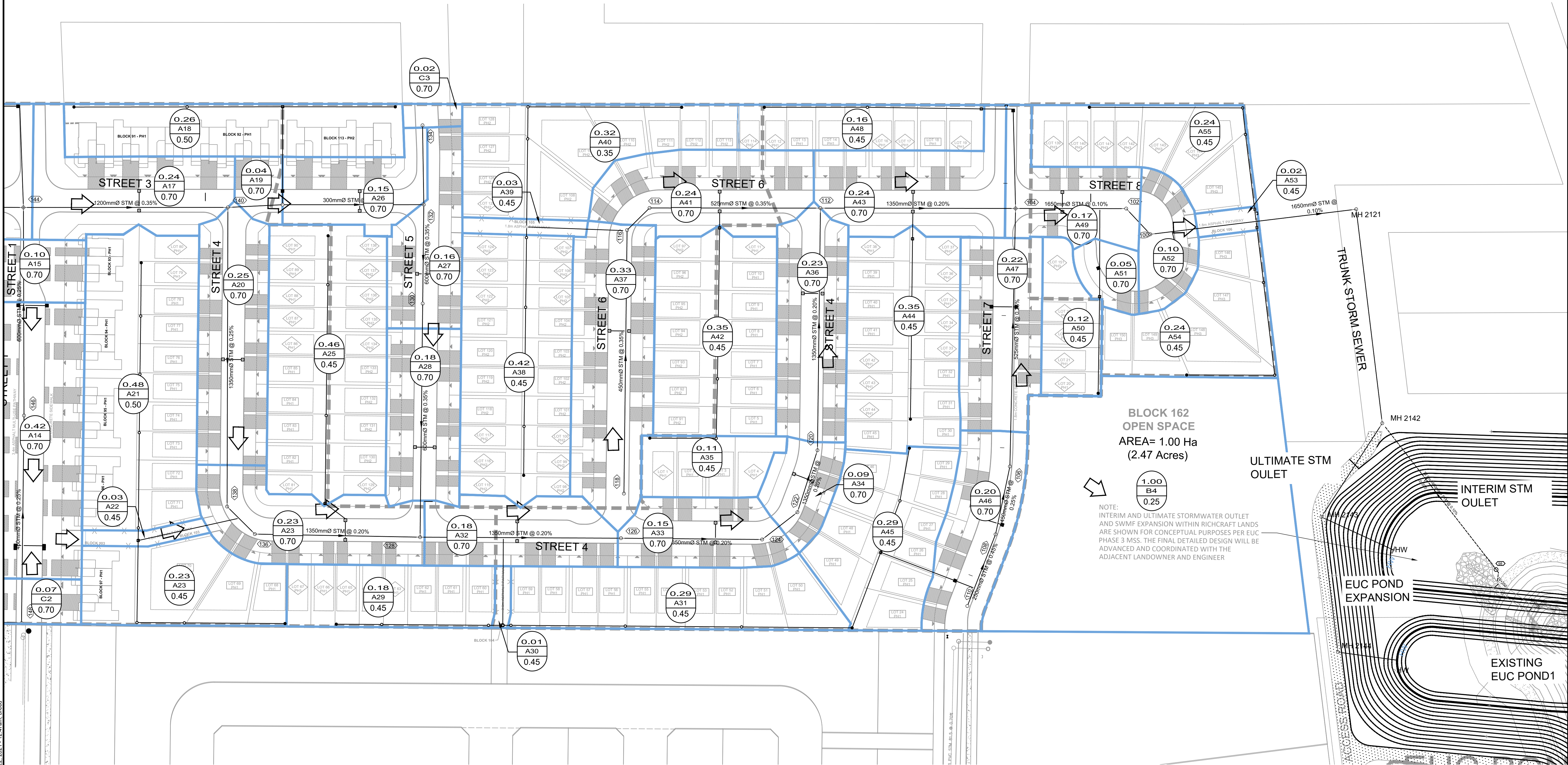

NOTE:
THE POSITION OF ALL POLE LINES, CONDUITS,
WATERMAINS, SEWERS AND OTHER
UNDERGROUND AND OVERGROUND UTILITIES AND
STRUCTURES IS NOT NECESSARILY SHOWN ON
THE CONTRACT DRAWINGS, AND WHERE SHOWN,
THE ACCURACY OF THE POSITION OF SUCH
UTILITIES AND STRUCTURES IS NOT GUARANTEED.
BEFORE STARTING WORK, DETERMINE THE EXACT
LOCATION OF ALL SUCH UTILITIES AND
STRUCTURES AND ASSUME ALL LIABILITY FOR
DAMAGE TO THEM.

PRELIMINARY

No.	REVISION	DATE	BY
4.	ISSUED FOR REVIEW	JUNE 18/21	BHB
3.	REVISED AND REISSUED FOR DRAFT PLAN APPROVAL	NOV 27/20	BHB
2.	REVISED AND REISSUED FOR DRAFT PLAN APPROVAL	APR 3/20	BHB
1.	DRAFT PLAN	OCT 4/19	BHB

SCALE

1:750

0 10 20 30

DESIGN	BR
CHECKED	BCS
DRAWN	BR
CHECKED	BCS
APPROVED	BHB

FOR REVIEW ONLY

NOVATECH

Engineers, Planners & Landscape Architects
Suite 200, 240 Michael Cowpland Drive
Ottawa, Ontario, Canada K2M 1P6
Telephone (613) 254-9643
Facsimile (613) 254-5867
Website www.novatech-eng.com

LOCATION
CITY OF OTTAWA
3610 INNES ROAD (FORMER BMR LANDS)

DRAWING NAME
STORM DRAINAGE AREA PLAN

PROJECT NO.
118224-00

REV
REV # 4

DRAWING NO.
118224-STM1