

**A POND SECTION A-A**  
SCALE: 1:100

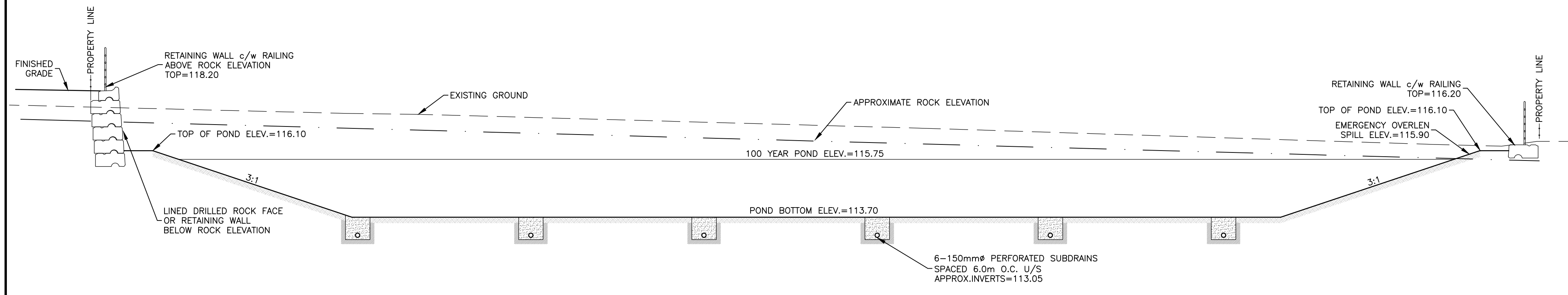

**B POND SECTION B-B**  
SCALE: 1:100

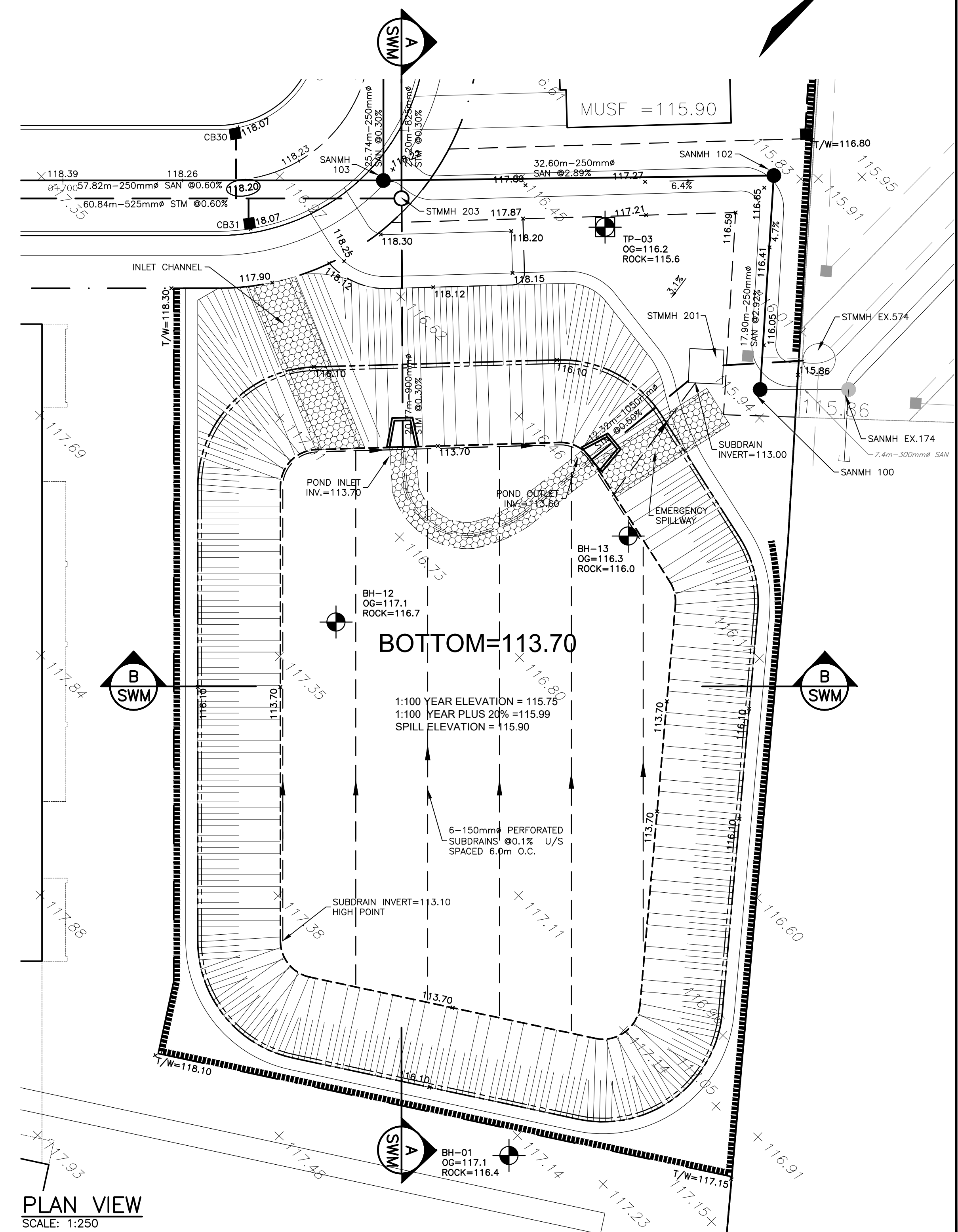
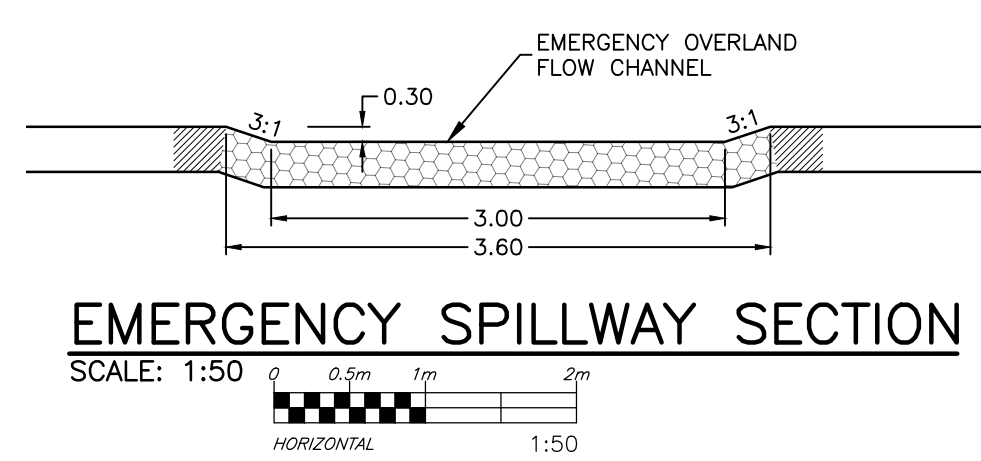
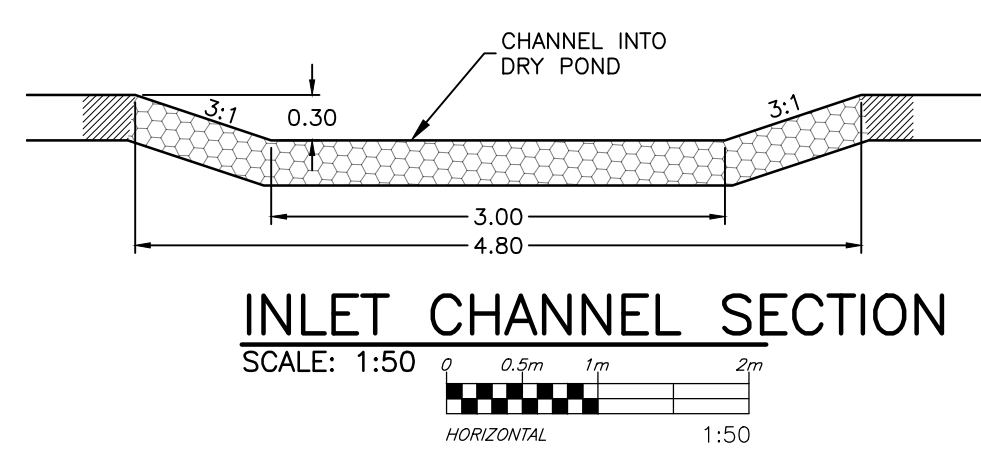

**PLAN VIEW**  
SCALE: 1:250

**CAUTION**  
THE POSITION OF ALL POLE LINES, CONDUITS, WATERMANS, SEWERS AND OTHER UNDERGROUND AND OVERGROUND UTILITIES AND STRUCTURES IS NOT NECESSARILY SHOWN ON THE CONTRACT DRAWINGS, AND WHERE SHOWN, THE ACCURACY OF THE POSITION OF SUCH UTILITIES AND STRUCTURES IS NOT GUARANTEED. BEFORE STARTING WORK, DETERMINE THE EXACT LOCATION OF ALL SUCH UTILITIES AND STRUCTURES AND ASSUME ALL LIABILITY FOR DAMAGE TO THEM.

**PRELIMINARY**  
NOT FOR CONSTRUCTION

REV	REVISION DESCRIPTION	DATE	BY	APPD
1	SUBMISSION NO.2	04/27/21	SK	BMT

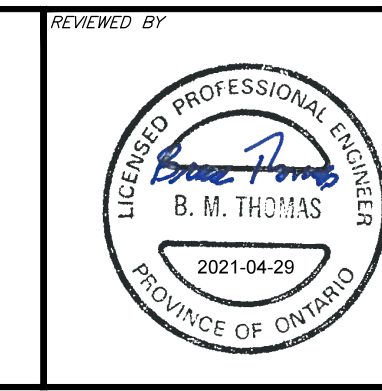
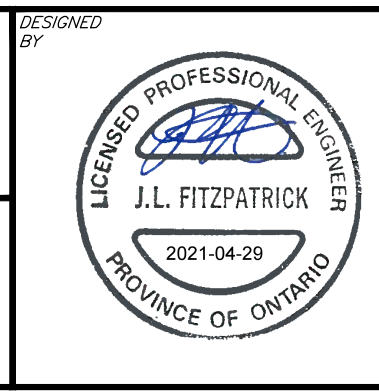
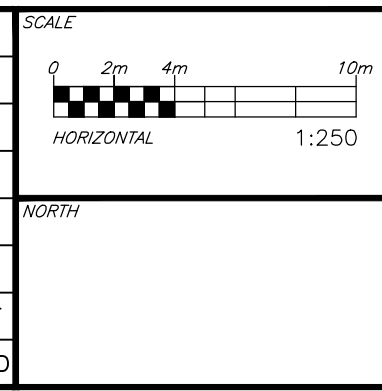

11654128 CANADA INC.  
768 BOULEVARD ST. JOSEPH  
GATINEAU, QC

exp Services Inc.  
1-813-688-1899 | 1-613-225-7330  
2050 St. Lawrence Blvd., Unit 100  
Ottawa, ON K2B 8K6  
Canada  
www.exp.com

• BUILDINGS • EARTH & ENVIRONMENT • ENERGY •  
• INDUSTRIAL • INFRASTRUCTURE • SUSTAINABILITY •

PROJECT	CLIENT	PROJECT NO.
6171 HAZELDEAN ROAD OTTAWA, ONTARIO.	11654128 CANADA INC.	258780
SWM-DETAILS		