

NOTES: 1. ELEVATIONS SHOWN ARE ASSUMED
2. CROSS-SECTION TO BE VIEWED LOOKING UP CHAINAGE

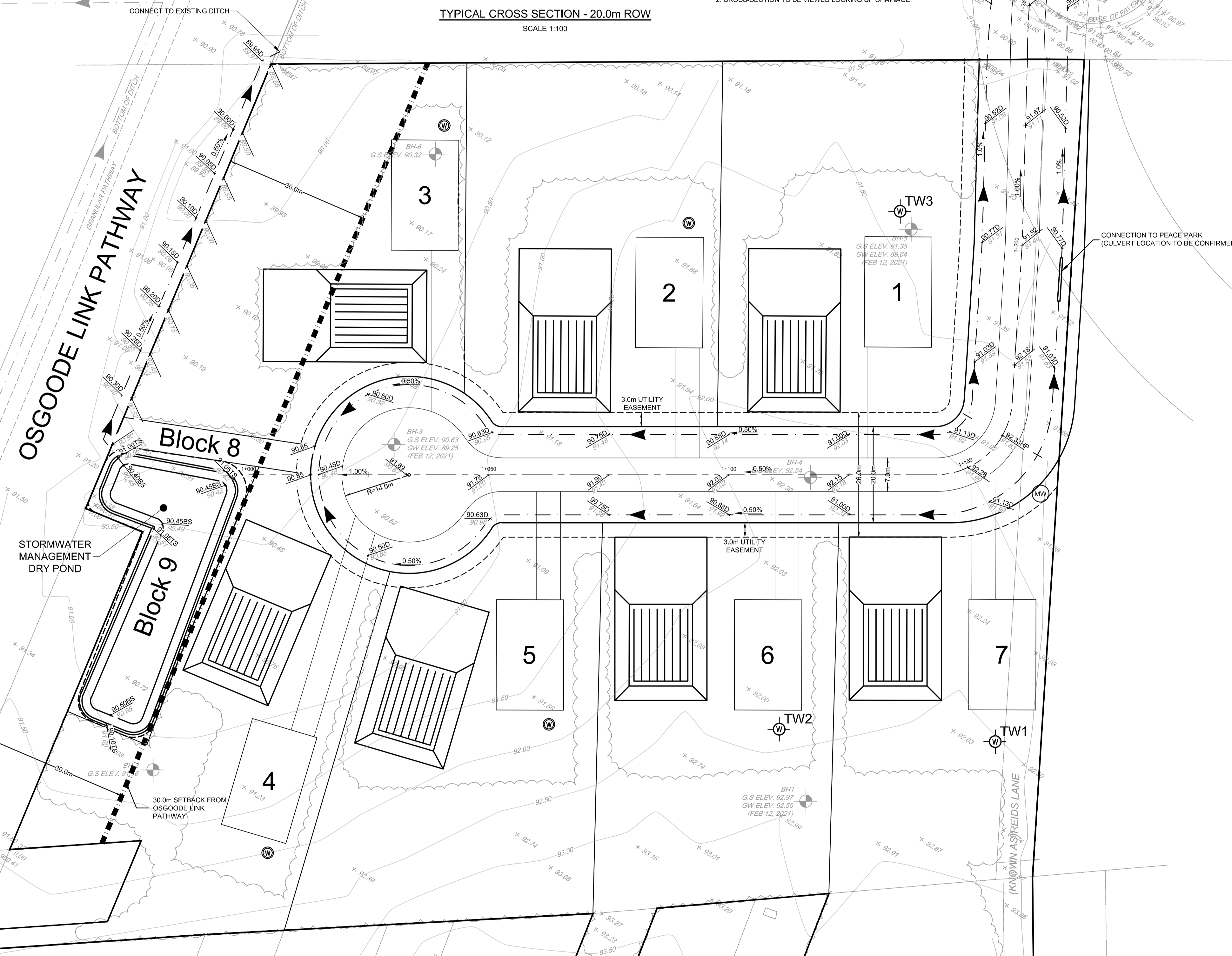
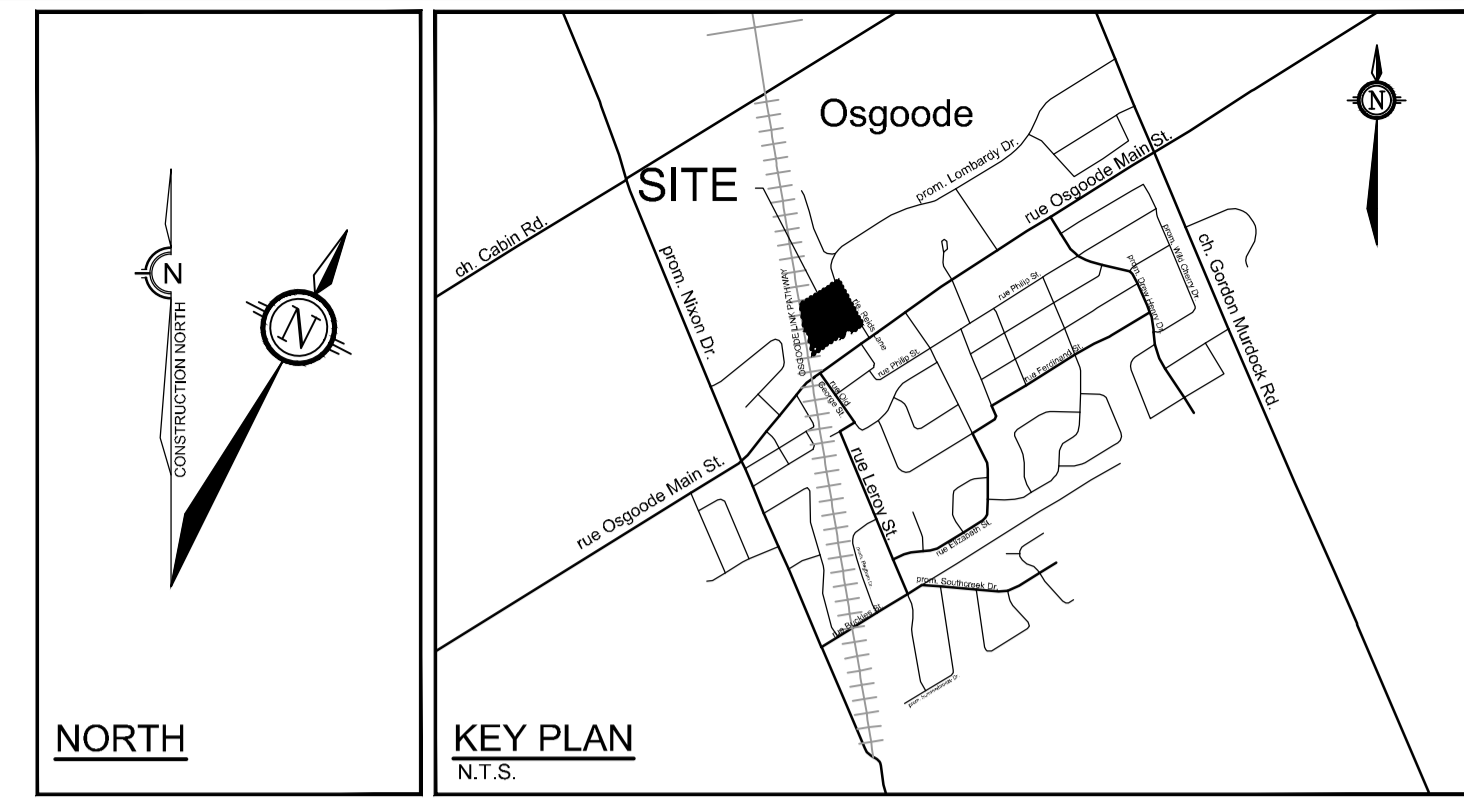

- LEGEND**
- PROPERTY LINE
 - 30m SETBACK FROM THE OSGOODE LINK PATHWAY
 - DITCH AND DIRECTION OF FLOW
 - 92.10 PROPOSED ELEVATION
 - 92.02 EXISTING ELEVATION
 - 92.53 PROPOSED ELEVATION
 - 90.97D PROPOSED DITCH ELEVATION
 - 0.50% GRADE AND DIRECTION
 - LIMIT OF TREE PRESERVATION (SOURCE: MAP 2 - TREE CONSERVATION REPORT AND ENVIRONMENTAL IMPACT STATEMENT BY MUNCATER ENVIRONMENTAL PLANNING INC. REPORT, DATED APRIL 1ST, 2021).
 - BH-1 G.S. ELEV. 91.35 G.W. ELEV. 89.84 BOREHOLE NUMBER, INFORMATION AND APPROXIMATE LOCATION (PROVIDED BY KOLLAARD ASSOCIATES, MARCH 9, 2021)
 - PROPOSED CULVERT
 - PROPOSED WELL
 - TW1 TEST WELL LOCATION AND NUMBER
 - MW PROPOSED MONITORING WELL
 - PROPOSED HOUSE FOOTPRINT (320m² / 3400 ft²)
 - PROPOSED PARTIALLY RAISED TILE FIELD AND MANTLE (BASED ON A DESIGN FLOW OF 3,000 L/day, WITH 8 RUNS OF 15m IN IMPORTED SAND WITH A PERCOLATION RATE OF 8min/cm)

NOTE:
THE POSITION OF ALL POLE LINES, CONDUITS, WATERMANS, SEWERS AND OTHER UNDERGROUND AND OVERGROUND UTILITIES AND STRUCTURES IS NOT NECESSARILY SHOWN ON THE CONTRACT DRAWINGS, AND WHERE SHOWN, THE ACCURACY OF THE POSITION OF SUCH UTILITIES AND STRUCTURES IS NOT GUARANTEED. BEFORE STARTING WORK, DETERMINE THE EXACT LOCATION OF ALL SUCH UTILITIES AND STRUCTURES AND ASSUME ALL LIABILITY FOR DAMAGE TO THEM.

No.	REVISION	DATE	BY
6.	ISSUED WITH REVISED CONCEPTUAL SWM REPORT	JUN 01/23	LAB
5.	ISSUED FOR COORDINATION	JUNE 13/22	LAB
4.	ISSUED FOR COORDINATION	MAY 5/22	LAB
3.	REVISED PER CITY COMMENTS	OCT 20/21	LAB
2.	ISSUED TO CITY OF OTTAWA	OCT 05/21	LAB
1.	ISSUED WITH CONCEPTUAL SWM REPORT	SEPT 03/21	LAB

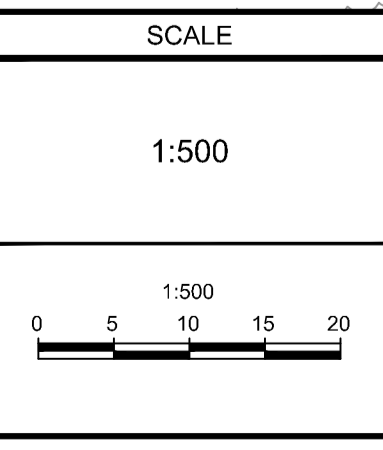

DESIGN	FOR REVIEW ONLY
RJK	
CHECKED	
LAB	
DRAWN	
RJK	
CHECKED	
LAB	
APPROVED	
SMG	

NOVATECH
Engineers, Planners & Landscape Architects
Suite 200, 240 Michael Cowpland Drive
Ottawa, Ontario, Canada K2M 1Y6
Telephone: (613) 254-9643
Facsimile: (613) 254-5867
Website: www.novatech-eng.com

LOCATION
CITY OF OTTAWA
REID'S LANE SUBDIVISION

DRAWING NAME
PRELIMINARY GRADING & SITE SERVICING PLAN

PROJECT No. 119089
REV # 6
DRAWING No. 119089-PGR

M:\2019\119089\CADD\Design\119089-PGR.dwg, PGR, May 31, 2023, 4:07pm, karamus