

NOTES: 1. ELEVATIONS SHOWN ARE ASSUMED  
2. CROSS-SECTION TO BE VIEWED LOOKING UP CHAINAGE

TYPICAL CROSS SECTION - 20.0m ROW  
SCALE 1:100

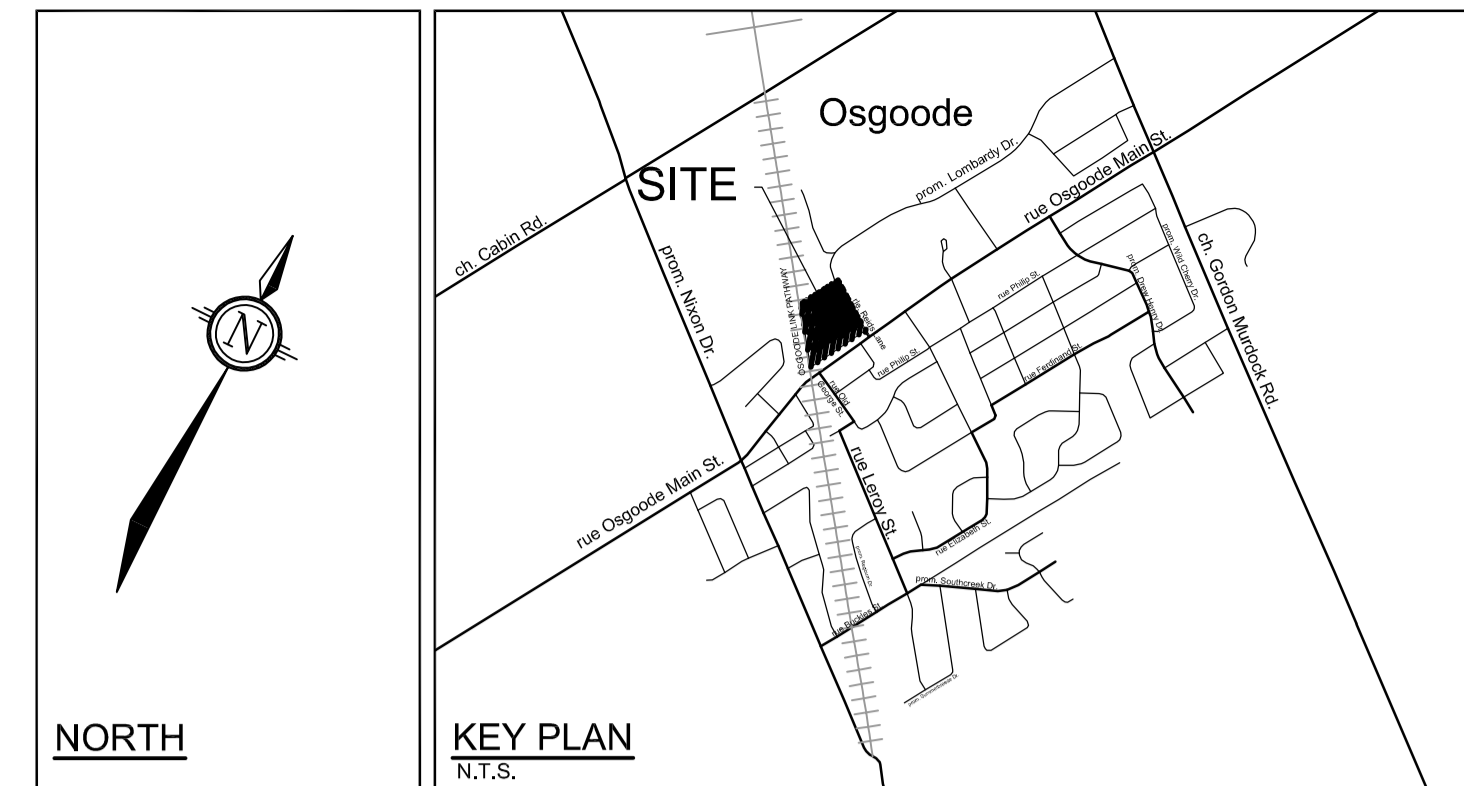

Osgoode Link Pathway

Lombardy Drive

PART

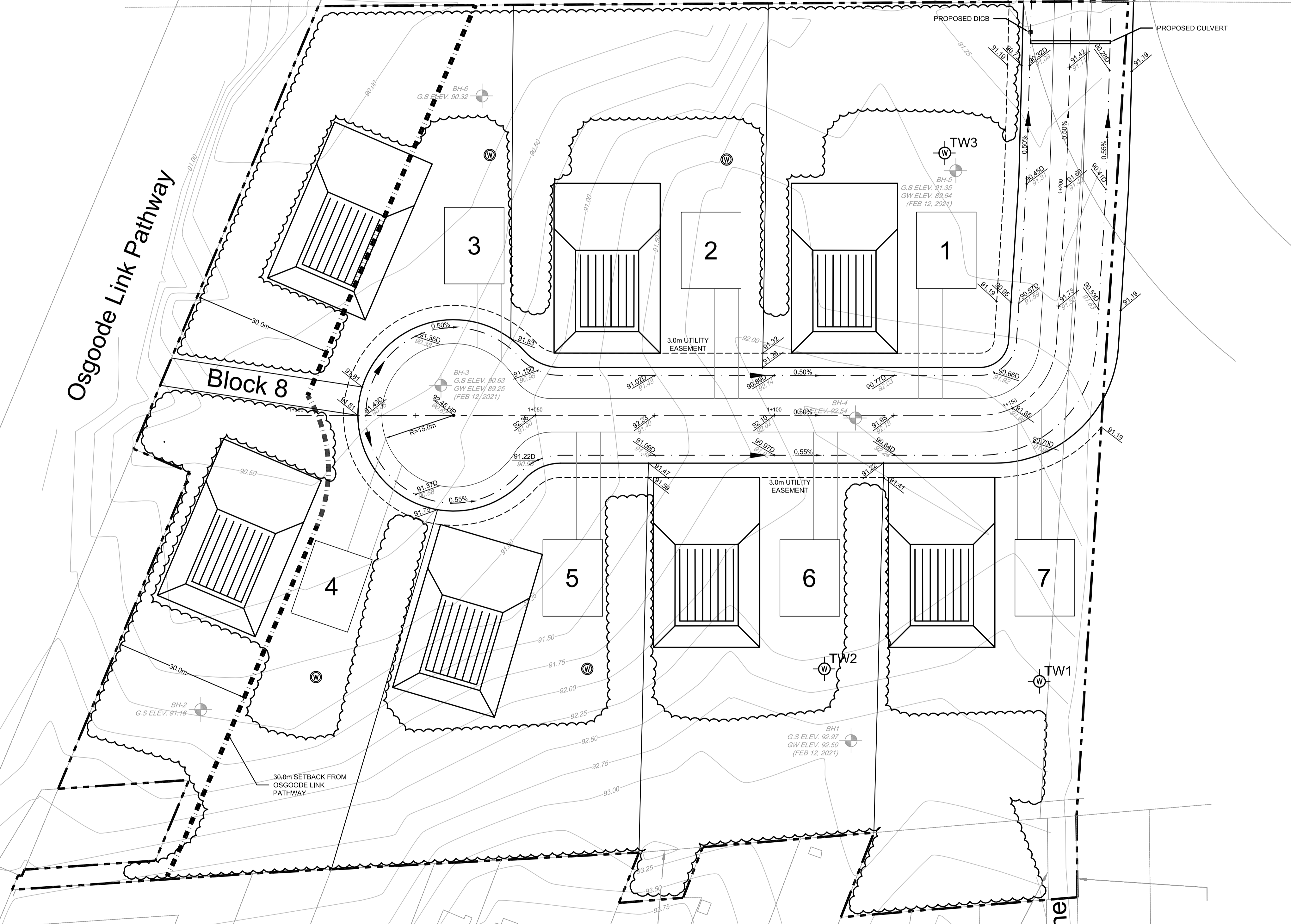

- LEGEND**
- PROPERTY LINE
  - - - 30m SETBACK FROM THE OSGOODE LINK PATHWAY
  - DITCH AND DIRECTION OF FLOW
  - 92.10 PROPOSED ELEVATION
  - 92.02 EXISTING ELEVATION
  - 92.53 PROPOSED ELEVATION
  - 90.97D PROPOSED DITCH ELEVATION
  - 0.5% GRADE AND DIRECTION
  - LIMIT OF TREE PRESERVATION (SOURCE: MAP 2 - TREE CONSERVATION REPORT AND ENVIRONMENTAL IMPACT STATEMENT BY MUNCATER ENVIRONMENTAL PLANNING INC. REPORT, DATED APRIL 1<sup>ST</sup>, 2021).
  - BH-1 G.S. ELEV. 91.35  
GW. ELEV. 89.64 BOREHOLE NUMBER, INFORMATION AND APPROXIMATE LOCATION (PROVIDED BY KOLLAARD ASSOCIATES, MARCH 9, 2021)
  - W PROPOSED WELL
  - W TW1 TEST WELL LOCATION AND NUMBER
  - PROPOSED HOUSE FOOTPRINT (200m<sup>2</sup> / 2150 ft<sup>2</sup>)
  - ▩ PROPOSED PARTIALLY RAISED TILE FIELD AND MANTLE (BASED ON A DESIGN FLOW OF 3.000 L/day, WITH 8 RUNS OF 15m IN IMPORTED SAND WITH A PERCOLATION RATE OF 8mm/min)

SOURCE REFERENCE:  
LEGAL INFORMATION:  
CITY OF OTTAWA LEGAL PLANS 5R-9330, 5R-13990, 4R-17009, 4R-20040 AND 4R-19665  
TOPOGRAPHIC INFORMATION:  
FAIRHALL, MOFFATT & WOOLAND LIMITED (208-1 OSGOODE) PART OF LOTS 27 & 28 CONCESSION 1 (OSGOODE) AND PART OF LOTS 50 & 51 REGISTERED PLAN 393 / NOVEMBER 5, 2020 / MTM ZONE 9 (NAD83 ORIGINAL)

NOTE:  
THE POSITION OF ALL POLE LINES, CONDUITS, WATERMANS, SEWERS AND OTHER UNDERGROUND AND OVERGROUND UTILITIES AND STRUCTURES IS NOT NECESSARILY SHOWN ON THE CONTRACT DRAWINGS, AND WHERE SHOWN, THE ACCURACY OF THE POSITION OF SUCH UTILITIES AND STRUCTURES IS NOT GUARANTEED. BEFORE STARTING WORK, DETERMINE THE EXACT LOCATION OF ALL SUCH UTILITIES AND STRUCTURES AND ASSUME ALL LIABILITY FOR DAMAGE TO THEM.

No.	REVISION	DATE	BY
2.	ISSUED TO CITY OF OTTAWA	OCT 05/21	LAB
1.	ISSUED WITH CONCEPTUAL SWM REPORT	SEPT 03/21	LAB

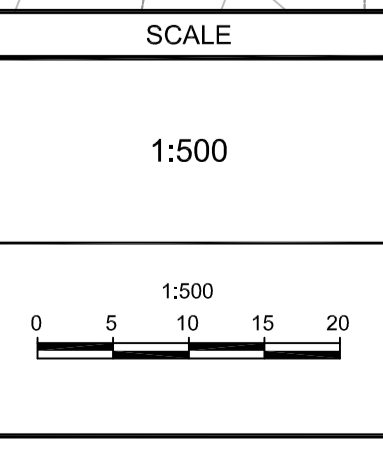

DESIGN	RJK
CHECKED	LAB
DRAWN	RJK
CHECKED	LAB
APPROVED	SMG

FOR REVIEW ONLY

**NOVATECH**  
Engineers, Planners & Landscape Architects  
Suite 200, 240 Michael Cowpland Drive  
Ottawa, Ontario, Canada K2M 1R6  
Telephone (613) 254-9643  
Facsimile (613) 254-5867  
Website www.novatech-eng.com

LOCATION CITY OF OTTAWA REID'S LANE SUBDIVISION	PROJECT No. 119089
DRAWING NAME PRELIMINARY GRADING & SITE SERVICING PLAN	REV # 2
	DRAWING No. 119089-PGR

M:\2019\119089\CADD\Design\119089-PGR.dwg, PGR\_Oct 05, 2021 - 3:55pm, k.magnus