

SUBJECT TO CONDITIONS, IF ANY, SET FORTH IN OUR LETTER DATED \_\_\_\_\_, 2021. THIS DRAFT PLAN IS APPROVED BY THE CITY OF OTTAWA UNDER SECTION 9 OF THE CONDOMINIUM ACT AND SECTION 51 OF THE PLANNING ACT THIS \_\_\_\_\_ DAY OF \_\_\_\_\_, 2021.

MICHAEL BOUGHTON, MCIP, RPP, ACTING PROGRAM MANAGER  
DEVELOPMENT REVIEW, SUBURBAN SERVICES, EAST  
PLANNING, INFRASTRUCTURE AND ECONOMIC DEVELOPMENT  
DEPARTMENT, CITY OF OTTAWA

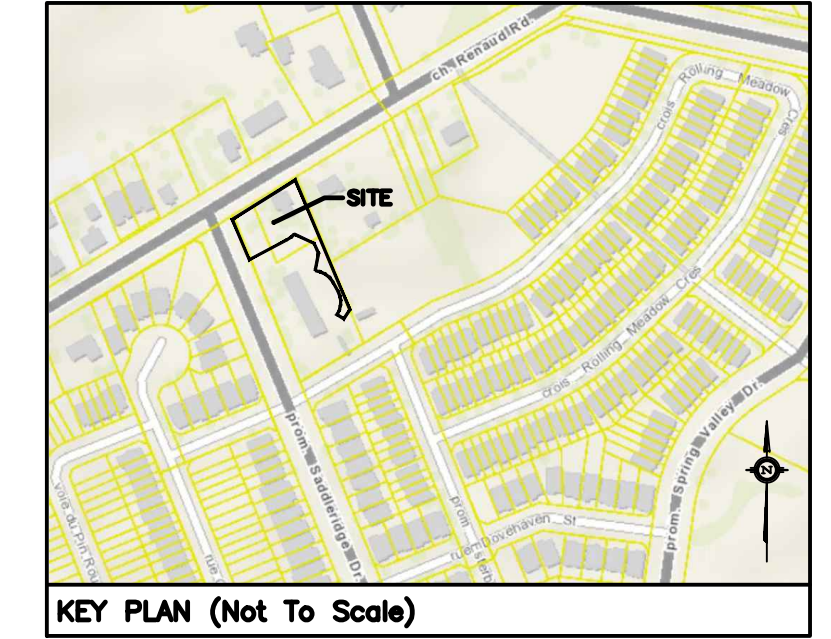

**DRAFT PLAN OF  
STANDARD CONDOMINIUM OF  
PART OF LOT 6  
CONCESSION 4 (OTTAWA FRONT)  
Geographic Township of Gloucester  
CITY OF OTTAWA**

Prepared by Annis, O'Sullivan, Vollebakk Ltd

Scale 1 : 250

Metric  
DISTANCES AND COORDINATES SHOWN ON THIS PLAN ARE IN METRES AND CAN BE CONVERTED TO FEET BY DIVIDING BY 0.3048

**Notes & Legend**

x 69.00 Denotes Existing Elevations  
- - - Property Line

**Surveyor's Certificate**  
I CERTIFY THAT the boundaries of the Lands to be subdivided and their relationship to the adjacent lands are accurately and correctly shown.

Date \_\_\_\_\_  
V. Andrew Shepl  
Ontario Land Surveyor

**Owner's Certificate**  
This is to certify that I am the owners / agent of the lands to be subdivided and that this plan was prepared in accordance my instructions.

Date \_\_\_\_\_  
C. Lacroix (Authorized Signing Officer)  
2597237 ONTARIO LIMITED  
I have the authority to bind the corporation.

BOUNDARY INFORMATION COMPILED FROM ANNIS, O'SULLIVAN VOLLEBEKK LTD, PLAN DATED SEPTEMBER 22, 2017.

Elevations shown hereon are referred to geodetic datum.

**ADDITIONAL INFORMATION REQUIRED UNDER SECTION 51 (17) OF THE PLANNING ACT.**

- (a) See Plan (Boundaries)
- (b) See Plan (Highways)
- (c) See Plan (Key Plan)
- (d) See Plan
- (e) See Plan (Adjoining Lands)
- (f) See Plan
- (g) See Plan (Features)
- (h) Municipal Water System Available
- (i) See Soils Report
- (j) See Plan (Elevations)
- (k) All Municipal Services Available (Hydro, Sewage & Telephone)
- (l) See Plan (Easements)

Bearings are grid, derived from GPS observations and are referred to the Central Meridian of MTM Zone 9 ( 76°30' West Longitude ) NAD-83 (original).



Y:\ENR\B\1103-21\Drawings\1103-21-2597237 Ontario Plan P116 C4 (OF)(GL) DPSSC D1.dwg