

REVISION SCHEDULE			
NO.	REVISION	DATE	BY
10	REVISED LEITRIM RD RE-ALIGNMENT	MAR. 14, 2023	N
9	REVISED LEITRIM RD ST. NO. 1 & 3 RE-ALIGNMENT BASED ON FIELD PICKUP OF HYDRO TOWERS	MAR. 10, 2023	MA
8	REVISED LEITRIM RD RE-ALIGNMENT & DEVELOPMENT LIMITS	MAR. 9, 2023	N
7	REVISED LEITRIM RD RE-ALIGNMENT	MAR. 1, 2023	N
6	ADJUSTED WIDTH STREETS 2 & 3	FEB. 23, 2023	N
5	REVISED CONCEPT	FEB. 21, 2023	N
4	ADDED BLOCKS 14 & 15, FUTURE MUP & PATH	JUNE 17, 2022	ns
3	REVISIONS	APR. 20, 2022	N
2	ADJUSTED STREET No. 2	MAY 23, 2019	N
1	PLAN PREPARED	MAY 21, 2019	N

SUBJECT TO THE CONDITIONS, IF ANY, SET FORTH IN OUR LETTER DATED _____

THIS DRAFT PLAN IS APPROVED BY THE CITY OF OTTAWA UNDER SECTION 51 OF THE PLANNING ACT THIS _____ DAY OF _____ 20____

_____ DON HERVEYER, M.C.P. R.P.P. MANAGER
DEVELOPMENT REVIEW-SOUTH
PLANNING, REAL ESTATE AND ECONOMIC
DEVELOPMENT DEPARTMENT, CITY OF OTTAWA

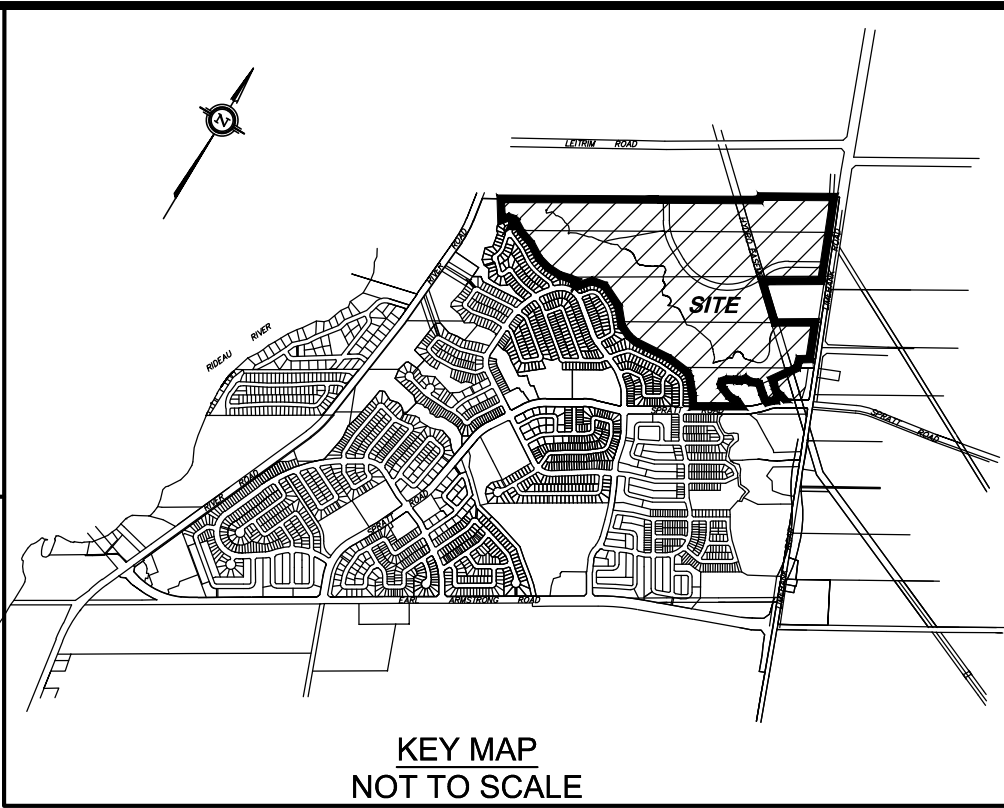

**DRAFT PLAN OF SUBDIVISION OF
PART OF LOTS 16, 17 AND 18
CONCESSION 1 (RIDEAU FRONT)**
Geographic Township of Gloucester
CITY OF OTTAWA
Prepared by ANNIS, O'SULLIVAN, VOLLEBEKK LTD.

Scale 1:2500
100 75 50 25 0 50 100 Metres

Metric
DISTANCES SHOWN ON THIS PLAN ARE IN METRES AND CAN BE CONVERTED TO FEET BY DIVIDING BY 0.3048

SURVEYOR'S CERTIFICATE

I CERTIFY THAT:
The boundaries of the lands to be subdivided and their relationship to adjoining lands have been accurately and correctly shown.

Date _____ T. Hartwick
ONTARIO LAND SURVEYOR

OWNER'S CERTIFICATE

This is to certify that I am the owner / agent of the lands to be subdivided and that this plan was prepared in accordance with my instructions.

Date _____ Marcel Denomme
Authorized Signing Officer
Riverside South Development Corp.
I have authority to bind the corporation.

ADDITIONAL INFORMATION REQUIRED UNDER SECTION 51-17 OF THE PLANNING ACT

- (a) see plan
- (b) see plan
- (c) see plan
- (d) Business Park, Institutional, Valley Lands, and Storm Water Management Area
- (e) see plan
- (f) see plan
- (g) see plan
- (h) City of Ottawa
- (i) see soils report
- (j) see plan
- (k) sanitary, storm sewers, municipal water, bell, hydro, cable and gas to be available
- (l) see plan

AREA SCHEDULE

BLOCK	AREA Ha / Ac
1	4.213 / 10.41
2	2.560 / 6.33
3	4.288 / 10.60
4	3.184 / 7.87
5	1.708 / 4.22
6	3.172 / 7.84
7	2.084 / 5.15
8	4.194 / 10.36
9	1.225 / 3.03
10	2.488 / 6.15
11	2.136 / 5.28
12	0.868 / 2.14
13	8.211 / 20.29
14	34.178 / 84.45
15	0.108 / 0.27
STREETS	5.140 / 12.70
TOTAL	79.577 / 197.09

