

**SURVEYOR'S REAL PROPERTY REPORT**  
PART 1)) BUILDING LOCATION SURVEY

PART OF LOT 20, JUNCTION GORE  
GEOGRAPHIC TOWNSHIP OF GLOUCESTER  
NOW IN THE CITY OF OTTAWA

© Copyright 2006 Stantec Geomatics Ltd. The reproduction, alteration or use of this REPORT in whole or in part without the express permission of Stantec Geomatics Ltd. is STRICTLY PROHIBITED.

ASSOCIATION OF ONTARIO  
LAND SURVEYORS  
PLAN SUBMISSION FORM  
1587468

THIS PLAN IS NOT VALID UNLESS IT IS AN ENRICHED ORIGINAL COPY ISSUED BY THE SURVEYOR

REGISTRATION NO. 2983

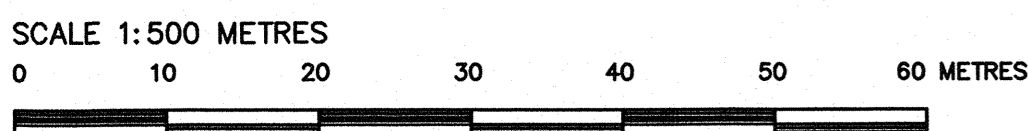

METRIC  
DISTANCES SHOWN ON THIS PLAN ARE IN METRES AND CAN BE CONVERTED TO FEET BY DIVIDING BY 0.3048

BEARING NOTE  
BEARINGS ARE GEODETIC AND ARE DERIVED FROM I.S.C.M. MONUMENT NO.'S 3-3848 (N 5028795.597, E 371002.298) AND 3-3715 (N 5028785.741, E 371248.415) AND ARE REFERRED TO THE CENTRAL MERIDIAN OF ZONE 8 OF THE ONTARIO COORDINATE SYSTEM, LONGITUDE 76°30'W.

NO.	NORTHING	EASTING
1	5028992.190	371133.435
2	5027084.689	371123.109
3	5027079.102	371023.975
4	5027081.028	371023.737
5	5027078.732	371050.545
6	5027098.899	371048.432
7	5027091.872	370987.390
8	5027123.533	370983.922
9	5027123.207	370980.940
10	5027117.807	370932.421
11	5027187.335	370928.957
12	5027286.703	371022.635
13	5027359.708	371242.549
14	5027008.351	371278.240

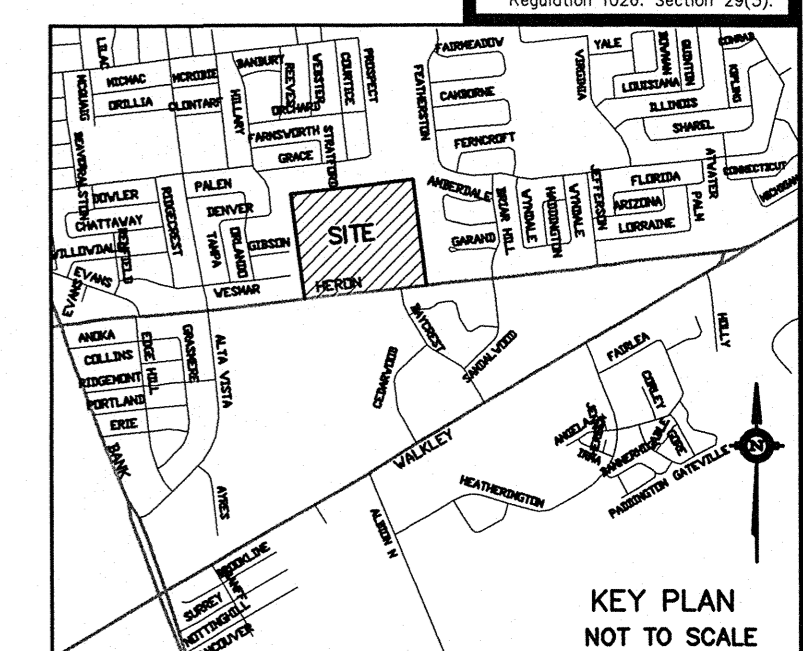

LEGEND & NOTES: (IF APPLICABLE)

■ DENOTES FOUND MONUMENTS	○ DENOTES ANCHOR	● DENOTES POWER POLE	DEC DENOTES DECIDUOUS	SAN DENOTES SANITARY
□ DENOTES SET MONUMENTS	○ DENOTES SIGN	○ DENOTES FLAG PALE	BP DENOTES BELL PEDESTAL	ST DENOTES STORM
▣ DENOTES IRON BAR	○ DENOTES CATCH BASIN	○ DENOTES FIRE HYDRANT	BS DENOTES BOUND STANDARD IRON BAR	SR DENOTES ROUND STANDARD IRON BAR
SB DENOTES STANDARD IRON BAR	○ DENOTES MANHOLE	○ DENOTES STEEL PIPE	MEAS. DENOTES MEASURED	WB DENOTES WEBSTER & SIMMONDS SURVEYING LTD.
SSB DENOTES SHORT STANDARD IRON BAR	○ DENOTES CONIFEROUS TREE	○ DENOTES CONCRETE CURB	PROP. DENOTES PROPORTIONED	WB&S(1473) DENOTES TREE LINE
CC DENOTES CUT CROSS	○ DENOTES DECIDUOUS TREE	○ DENOTES WATER VALVE	INVT DENOTES INVERT	FL DENOTES PLAN 4R-699
M&W DENOTES NAIL & WASHER	○ DENOTES WATERMAIN	○ DENOTES GAS VALVE	WTR DENOTES WATER	FL DENOTES PLAN 4R-1729
WT DENOTES WITNESS	○ DENOTES DECIDUOUS TREE	○ DENOTES WATER VALVE CHAMBER	CONV DENOTES CONDUIT, DUCT, PIPES	CONV DENOTES CONDUIT, DUCT, PIPES
∅ DENOTES DIAMETER	○ DENOTES LAMP POLE	○ DENOTES TEST PIT		

NOTE:

CALCULATED BEARINGS SHOWN HEREON ARE BASED ON THE CALCULATED DIFFERENCE OF 3725" BETWEEN MEAS GEODETIC BEARINGS AND THE BEARING SHOWN ON PLAN 4R-699.

Report Summary Filed: PWGSC Date:

PART 2)) This Report was prepared for PWGSC and the undersigned accepts no responsibility for the use by other parties.

LEGEND & NOTES: (IF APPLICABLE)

■ DENOTES FOUND MONUMENTS	○ DENOTES ANCHOR	● DENOTES POWER POLE	DEC DENOTES DECIDUOUS	SAN DENOTES SANITARY
□ DENOTES SET MONUMENTS	○ DENOTES SIGN	○ DENOTES FLAG PALE	BP DENOTES BELL PEDESTAL	ST DENOTES STORM
▣ DENOTES IRON BAR	○ DENOTES CATCH BASIN	○ DENOTES FIRE HYDRANT	BS DENOTES BOUND STANDARD IRON BAR	SR DENOTES ROUND STANDARD IRON BAR
SB DENOTES STANDARD IRON BAR	○ DENOTES MANHOLE	○ DENOTES STEEL PIPE	MEAS. DENOTES MEASURED	WB DENOTES WEBSTER & SIMMONDS SURVEYING LTD.
SSB DENOTES SHORT STANDARD IRON BAR	○ DENOTES CONIFEROUS TREE	○ DENOTES CONCRETE CURB	PROP. DENOTES PROPORTIONED	WB&S(1473) DENOTES TREE LINE
CC DENOTES CUT CROSS	○ DENOTES DECIDUOUS TREE	○ DENOTES WATER VALVE	INVT DENOTES INVERT	FL DENOTES PLAN 4R-699
M&W DENOTES NAIL & WASHER	○ DENOTES WATERMAIN	○ DENOTES GAS VALVE	WTR DENOTES WATER	FL DENOTES PLAN 4R-1729
WT DENOTES WITNESS	○ DENOTES DECIDUOUS TREE	○ DENOTES WATER VALVE CHAMBER	CONV DENOTES CONDUIT, DUCT, PIPES	CONV DENOTES CONDUIT, DUCT, PIPES
∅ DENOTES DIAMETER	○ DENOTES LAMP POLE	○ DENOTES TEST PIT		

NOTE:

1. This PLAN OF SURVEY to be READ in conjunction with the Report Summary

2. This REPORT can be updated only by this office, however NO ADDITIONAL PRINTS of this ORIGINAL REPORT will be issued subsequent to the DATE OF CERTIFICATION.

161611207\_110\_PWGSC\_HERONRD\_042006.DWG

DATE: April 2006

STANTEC GEOMATICS LTD.

Ontario Land Surveyors  
2111 WILSON AVENUE  
(613) 722-4420 FAX (613) 722-0769  
www.stantec.com

AREA OF PARCEL IS 7,3269 ha

STANTEC