

Copyright Reserved

The Contractor shall verify and be responsible for all dimensions. DO NOT scale the drawing - any errors or omissions shall be reported to Stantec without delay.  
The Copyrights to all designs and drawings are the property of Stantec. Reproduction or use for any purpose other than that authorized by Stantec is forbidden.

Legend

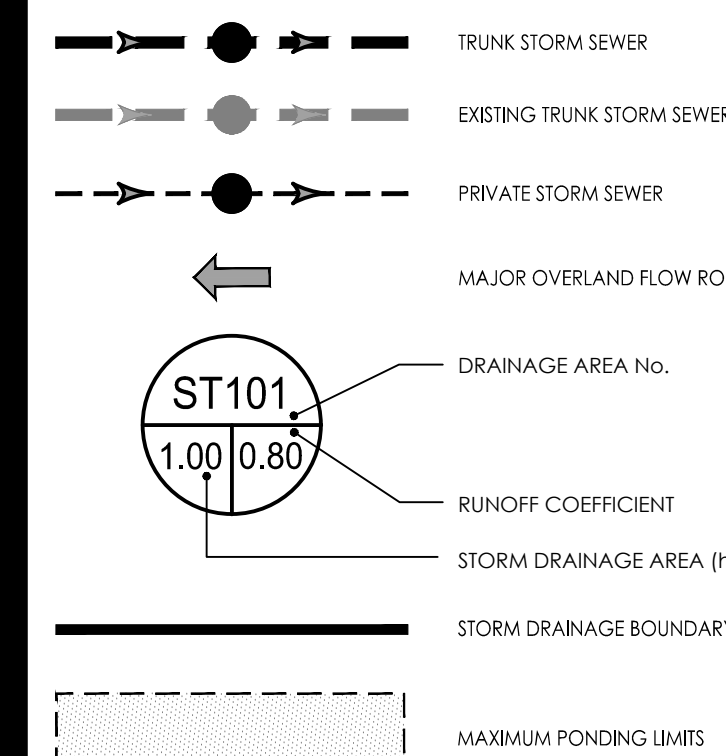

Notes

Revision	By	Appd.	YY.MM.DD
1	MJS	RB	24.03.06
0	MJS	RB	23.08.08

File Name: 160401751\_DRAFT LEVEL.dwg  
Dwn. Chk. Dgn. MJS RB MJS 23.06.01 YY.MM.DD

Permit-Seal



Client/Project

BRIGIL  
98 LOIS STREET  
GATINEAU, QC J8T 3R7  
PETRIES LANDING III  
OTTAWA, ON

Title

OVERALL STORM SEWER SYSTEM

Project No.

160401751

Drawing No.

STM-1

Scale

1:1000

Sheet

1 of 4

Revision

1

PLAN #

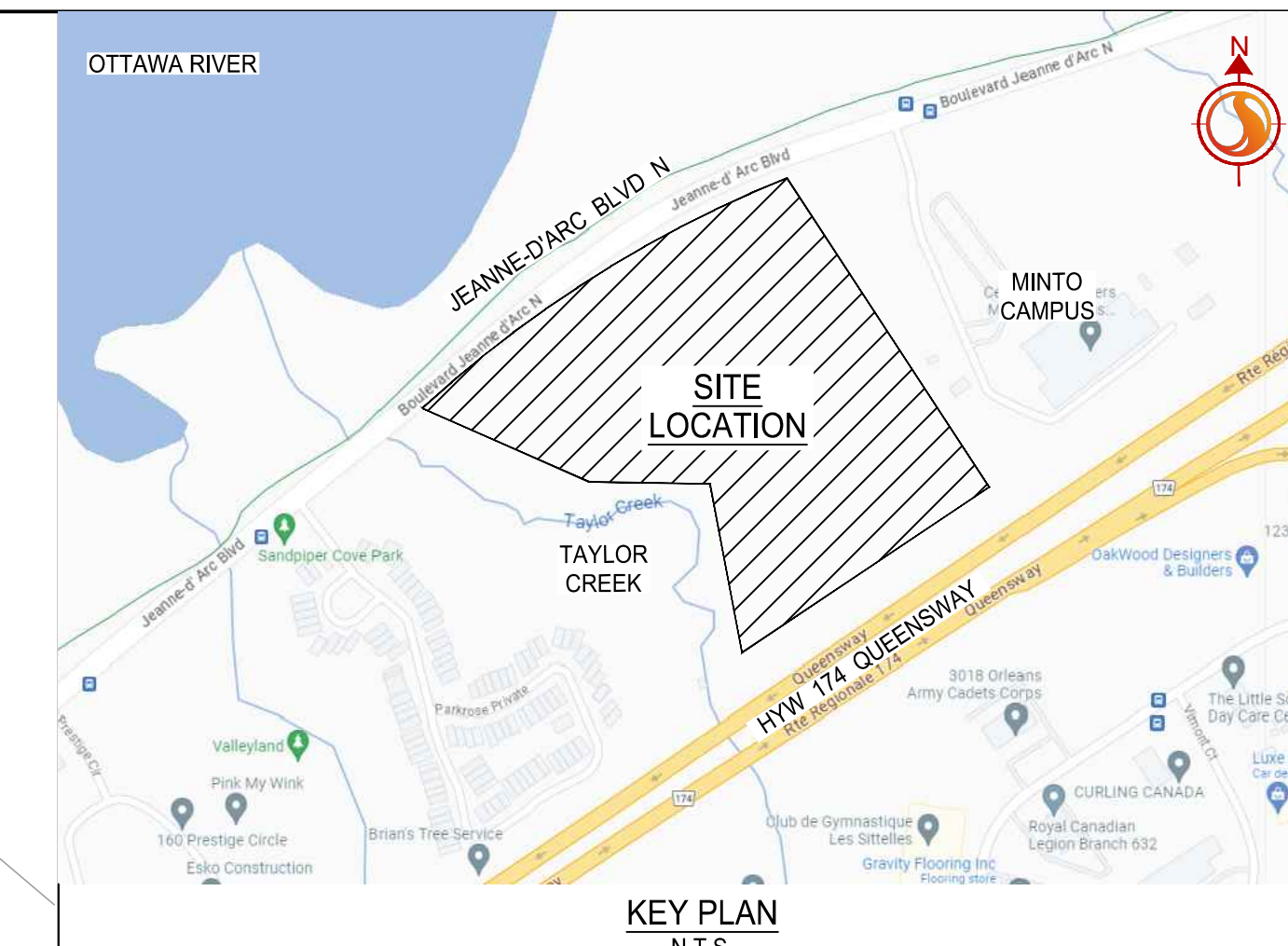
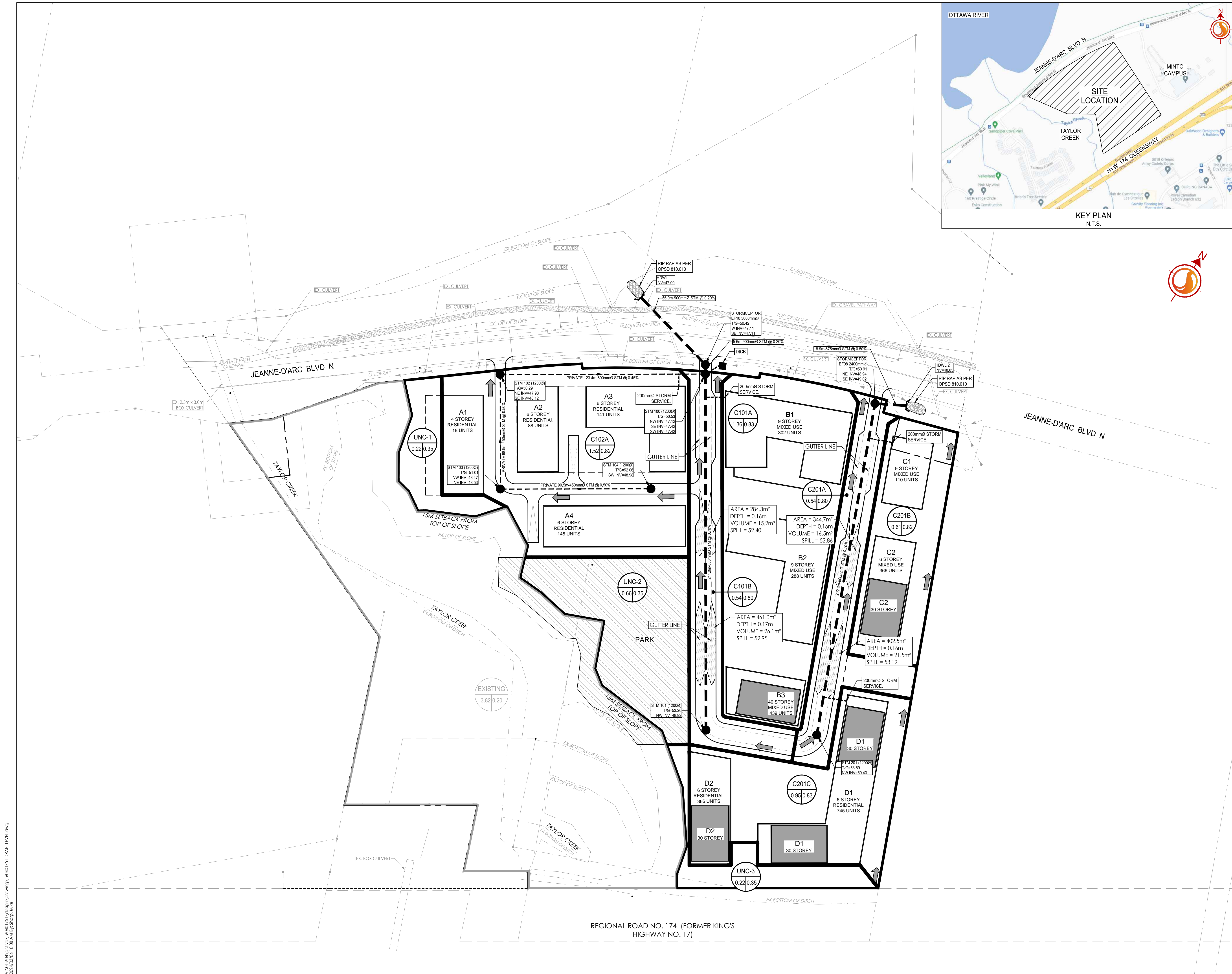

V:\016040\active\160401751\design\drawing\160401751\_DRAFT LEVEL.dwg  
24/03/24 09:10:38 AM By: shap.wae