

NOTE:
THE POSITION OF ALL POLE LINES, CONDUITS,
WATERMAINS, SEWERS AND OTHER
UNDERGROUND AND OVERGROUND UTILITIES AND
STRUCTURES IS NOT NECESSARILY SHOWN ON
THE CONTRACT DRAWINGS, AND WHERE SHOWN,
THE ACCURACY OF THE POSITION OF SUCH
UTILITIES AND STRUCTURES IS NOT GUARANTEED.
BEFORE STARTING WORK, DETERMINE THE EXACT
LOCATION OF ALL SUCH UTILITIES AND
STRUCTURES AND ASSUME ALL LIABILITY FOR
DAMAGE TO THEM.

1.	ISSUED FOR CITY REVIEW	NOV 7/25	JLL	
No.	REVISION	DATE	BY	

SCALE
1:500
1:500
0 5 10 15 20

DESIGN	RCH
CHECKED	JRA
DRAWN	TGS
CHECKED	JRA
APPROVED	JLL

FOR REVIEW ONLY	

NOVATECH
Engineers, Planners & Landscape Architects
Suite 200, 240 Michael Cowpland Drive
Ottawa, Ontario, Canada K2M 1P6
Telephone (613) 254-9643
Facsimile (613) 254-5867
Website www.novatech-eng.com

LOCATION
CITY of OTTAWA
CARP AIRPORT PH2 BUSINESS PARK

DRAWING NAME
FUNCTIONAL DESIGN
MARCH RD & THOMAS ARGUE RD

PROJECT No.	102085-14
REV	REV # 1
DRAWING No.	102085-FD1

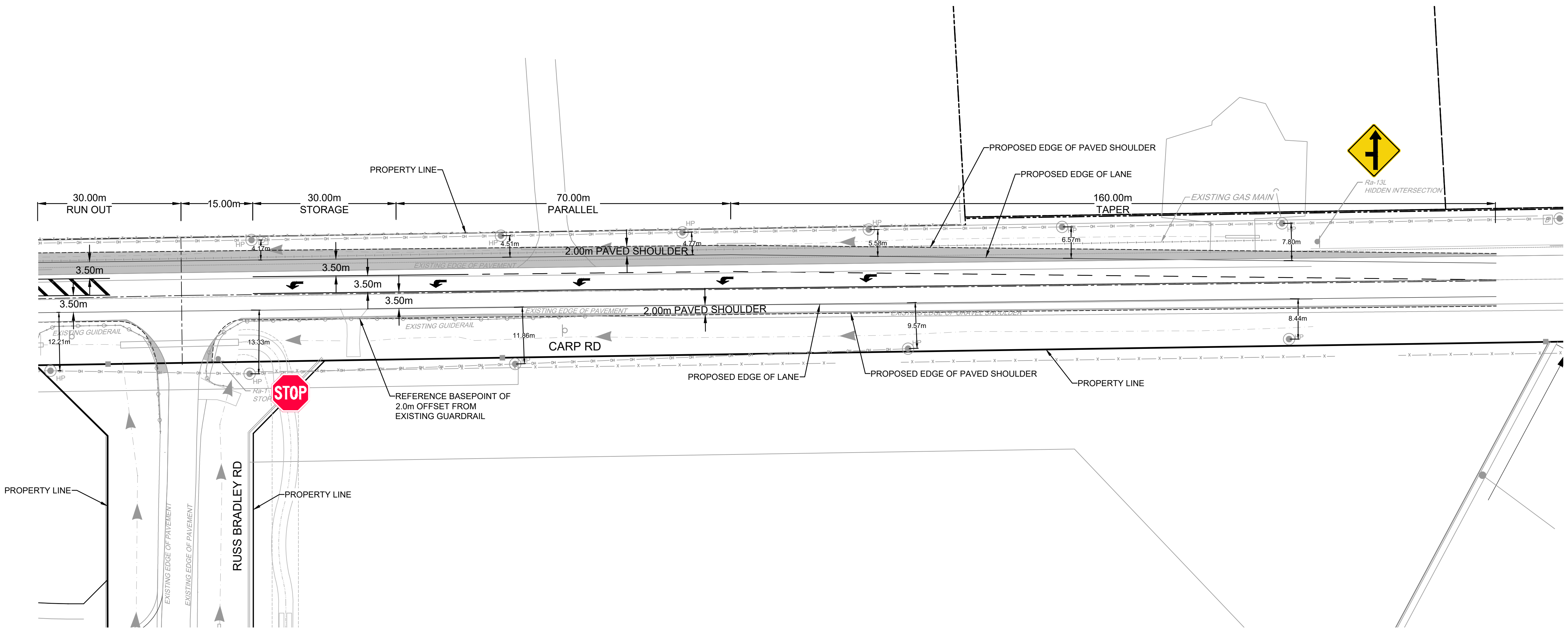
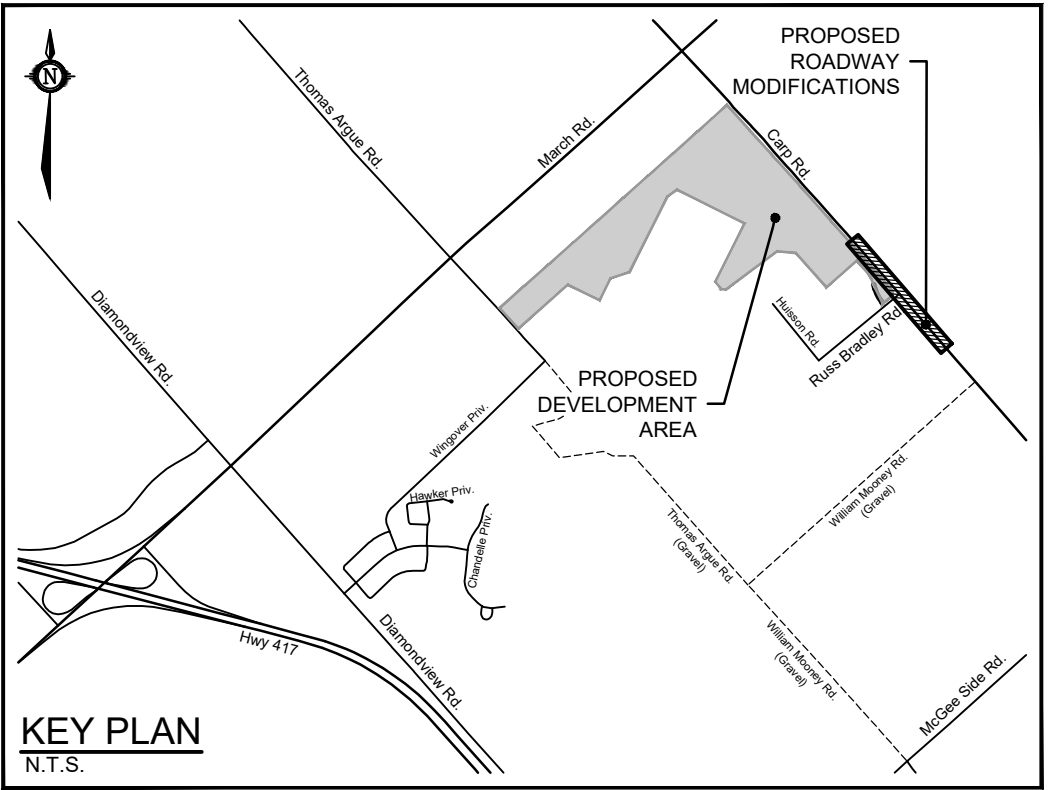
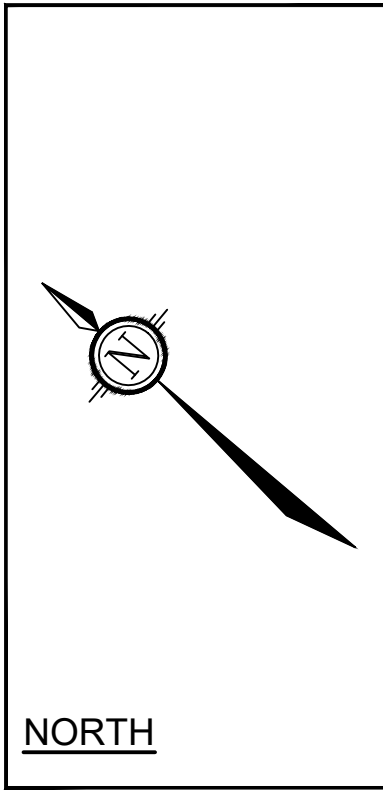
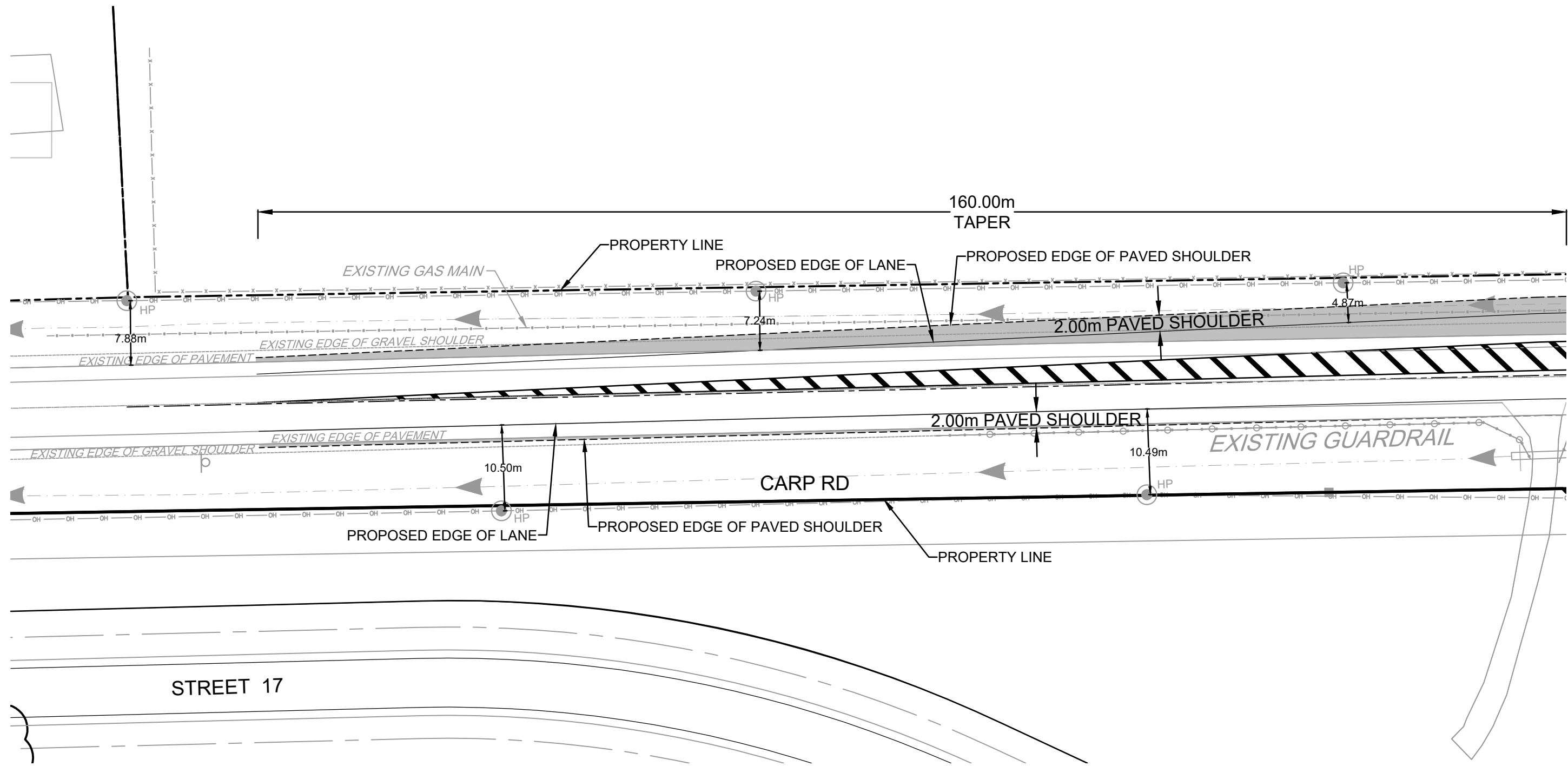

NOTE:
THE POSITION OF ALL POLE LINES, CONDUITS,
WATERMAINS, SEWERS AND OTHER
UNDERGROUND AND OVERGROUND UTILITIES AND
STRUCTURES IS NOT NECESSARILY SHOWN ON
THE CONTRACT DRAWINGS, AND WHERE SHOWN,
THE ACCURACY OF THE POSITION OF SUCH
UTILITIES AND STRUCTURES IS NOT GUARANTEED.
BEFORE STARTING WORK, DETERMINE THE EXACT
LOCATION OF ALL SUCH UTILITIES AND
STRUCTURES AND ASSUME ALL LIABILITY FOR
DAMAGE TO THEM.

No.	REVISION	DATE	BY
1.	ISSUED FOR CITY REVIEW	NOV 7/25	JLL

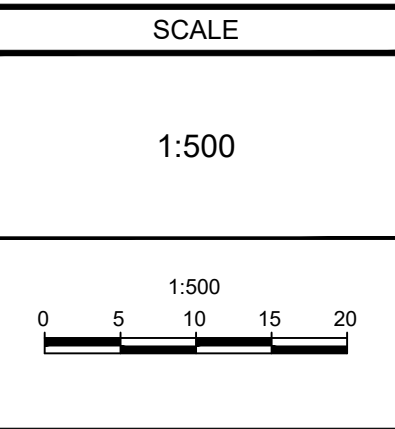

DESIGN	RCH
CHECKED	JRA
DRAWN	TGS
CHECKED	JRA
APPROVED	JLL

FOR REVIEW ONLY	



LOCATION
CITY of OTTAWA
CARP AIRPORT PH2 BUSINESS PARK
DRAWING NAME
FUNCTIONAL DESIGN
CARP RD & RUSS BRADLEY RD

PROJECT No.	102085-14
REV	REV # 1
DRAWING No.	102085-FD2

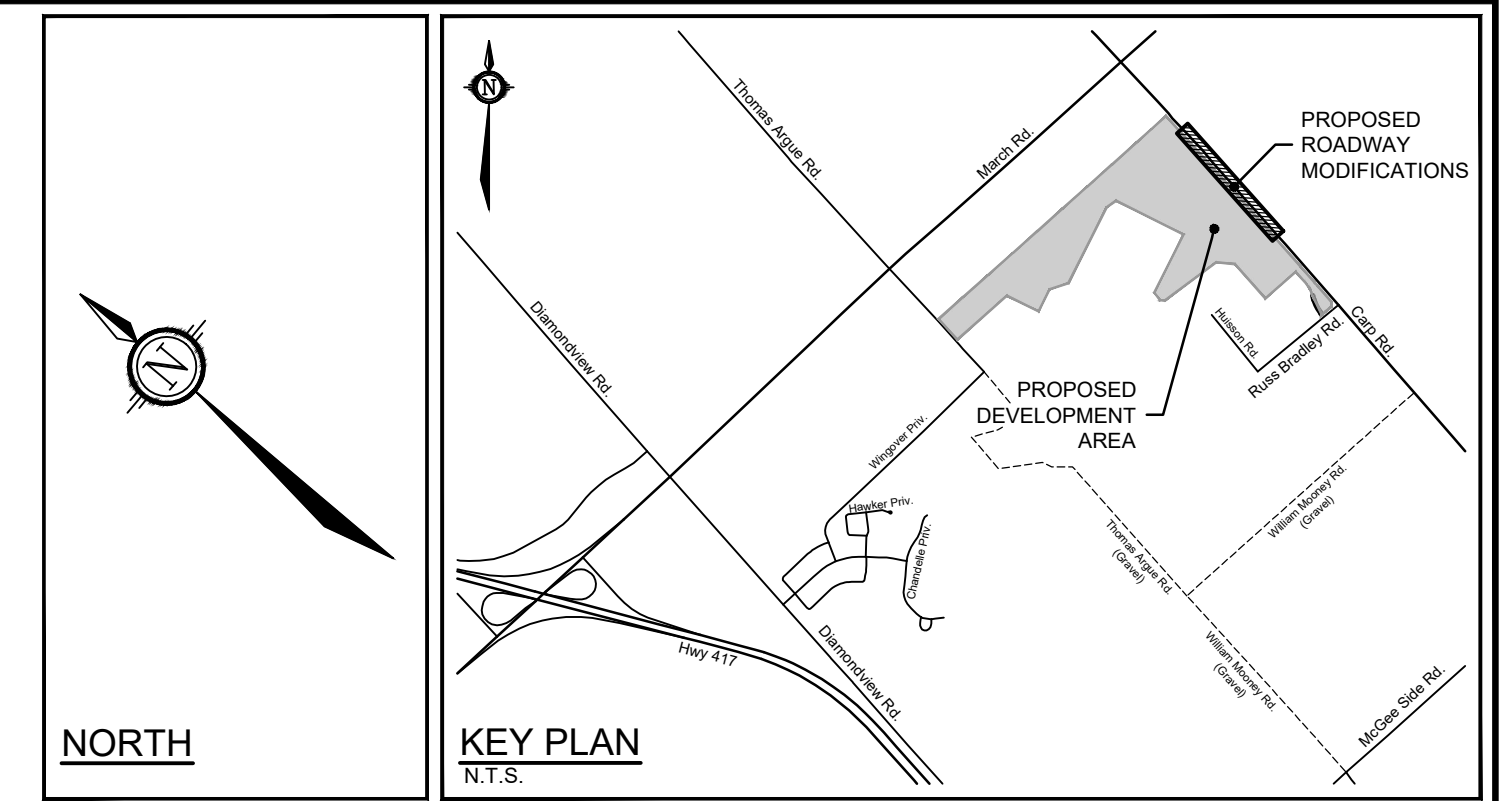

1.	ISSUED FOR CITY REVIEW	NOV 7/25	JLL
No.	REVISION	DATE	BY

DESIGN	RCH
CHECKED	JRA
DRAWN	TGS
CHECKED	JRA
APPROVED	JLL

PROJECT No.	102085-14
	REV # 1
DRAWING No.	102085-FD3