

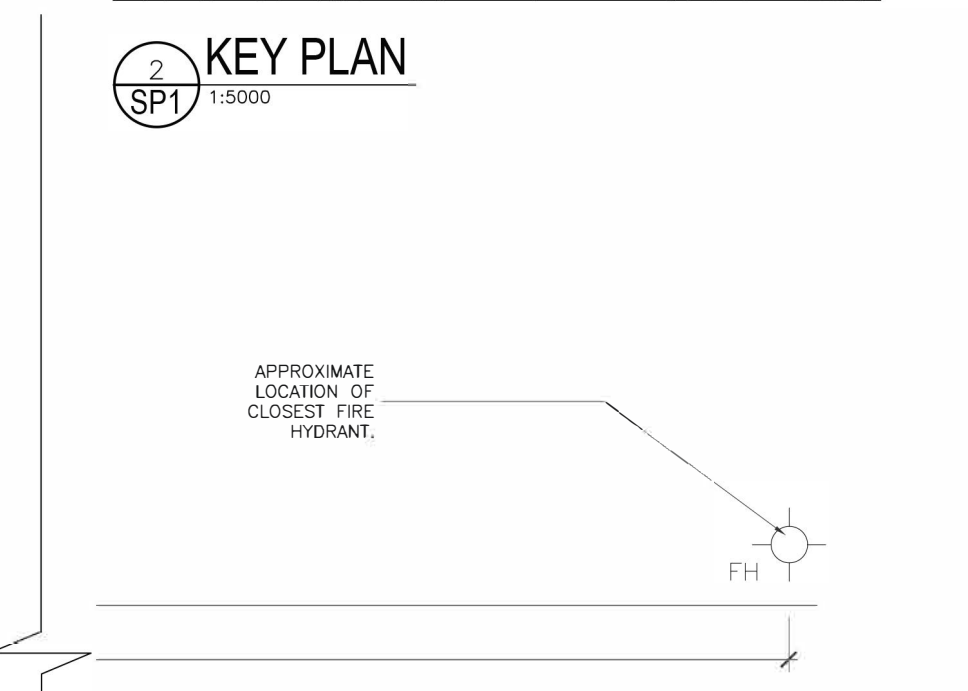

| DEVELOPMENT INFORMATION | | | | # OF UNITS |
|---|-----------------|--|------------|--------------|
| ZONING RAUD (478) - RAUD (479) | | | | 31 |
| SITE AREA SQ.M | 832 | 8955.6 | SQ.FT | |
| % L.O.S | 253 | 2728 | SQ.FT | |
| AREAS ABOVE GRADE | | | | SQ.FT |
| TOTAL GROSS BUILDING AREA | | | | 22802 |
| TOTAL GROSS FLOOR AREA OF APARTMENTS | | | | 18431 |
| BUILDING EFFICIENCY ABOVE GRADE | | | | 81% |
| AREAS BELOW GRADE | | | | SQ.FT |
| TOTAL GROSS BUILDING AREA | | | | 5205 |
| TOTAL GROSS FLOOR AREA OF APARTMENTS | | | | 1033 |
| BUILDING EFFICIENCY BELOW GRADE | | | | 20% |
| AREAS ABOVE GRADE (INCLUDING BASEMENT UNITS) | | | | SQ.FT |
| TOTAL GROSS BUILDING AREA | | | | 23835 |
| TOTAL GROSS FLOOR AREA OF APARTMENTS | | | | 19464 |
| BUILDING EFFICIENCY | | | | 82% |
| PARKING AREA | | | | UNITS |
| UNDERGROUND PARKING | | | | 7+1 VISITS |
| GROSS AREA BY FLOOR | | | | |
| LEVEL | TOTAL | APART | UNITS | |
| FIRST FLOOR | 5325 | 3929 | 6 | |
| 2ND & THIRD | 10227 | 8715 | 13 | |
| 4TH TO 5TH | 7250 | 5787 | 10 | |
| BASEMENT | 5205 | 1033 | 2 | |
| UNIT | AREA SQ.FT | CONFIGURATION | # OF UNITS | |
| TYPE A | 925 | 2BR | 1 | |
| TYPE B | 707 | 2BR | 2 | |
| TYPE B2 | 498 | 1BR | 1 | |
| TYPE B1 (BF) | 707 | 2BR | 2 | |
| TYPE C | 454 | 1BR | 5 | |
| TYPE D1 | 803 | 2BR | 1 | |
| TYPE D2 | 652 | 1BR & DEN | 1 | |
| TYPE D | 628 | 1BR & DEN | 2 | |
| TYPE E | 763 | 2BR | 1 | |
| TYPE F | 393 | 2BR | 1 | |
| TYPE G | 558 | 1BR | 1 | |
| TYPE G1 (BF) | 664 | 1BR | 2 | |
| TYPE H | 434 | BACHELOR | 1 | |
| TYPE H1 (BF) | 447 | BACHELOR | 1 | |
| TYPE I | 850 | 2BR | 1 | |
| TYPE J | 925 | 2BR | 1 | |
| TYPE K | 421 | BACHELOR | 1 | |
| TYPE L | 458 | BACHELOR | 1 | |
| TYPE M | 1188 | 2BR & DEN | 1 | |
| TYPE N | 514 | 1BR | 1 | |
| TYPE O | 519 | 1BR | 1 | |
| TYPE P | 486 | 1BR | 1 | |
| TYPE Q | 388 | BACHELOR | 1 | |
| UNIT | # OF UNITS | REQUIRED BY BY-LAW OF THE TOTAL # OF UNITS | PROVIDED | |
| 2BR | 11 | 2 | 2 | |
| 1BR | 15 | 2 | 2 | |
| BACHELOR | 5 | 1 | 1 | |
| AMENITY AREA | OUTDOOR (SQ.FT) | INDOOR (SQ.FT) | | |
| COMMUNAL | 1785 | 249 | | |
| PRIVATE | 724 | - | | |
| AMENITY AREA | SQ.FT | SQ.M | | |
| TOTAL | 2758 | 256 | | |
| REQUIRED | 2035 | 186 | | |

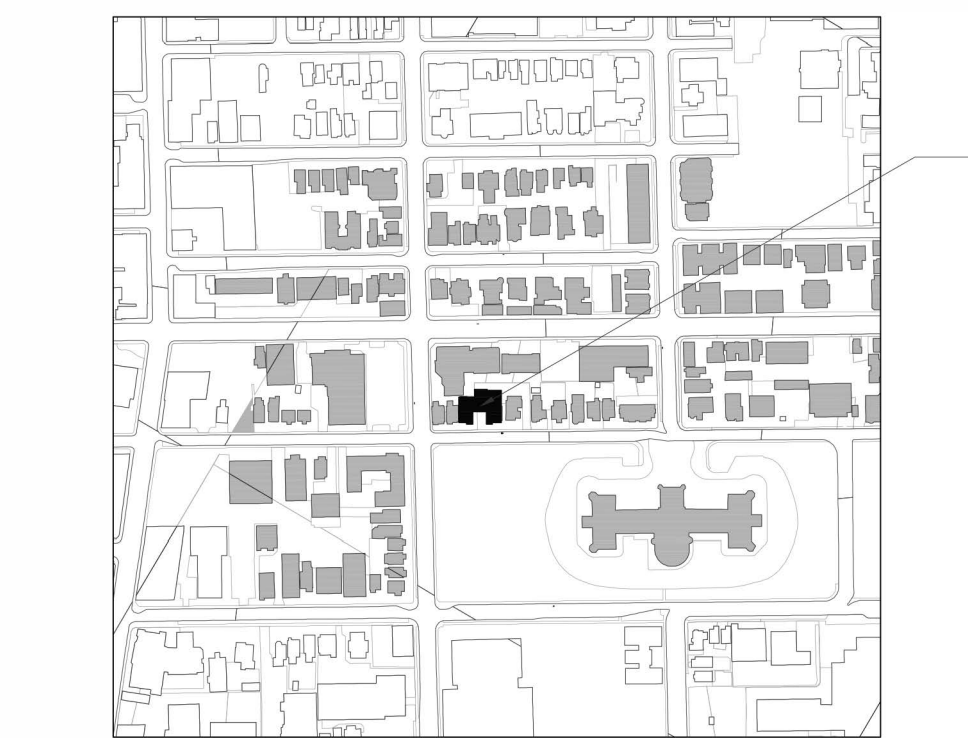

01 APR 25/23 FOR ZONING AMENDMENT RESUBMISSION
NO. REV DATE REV DESCRIPTION

COLIZZA BRUNI
architecture

76 CHAMBERLAIN AVE • OTTAWA • ONTARIO • K1S 1V8
T 613.236.2944 • F 613.236.6777 • www.colizzabruni.com

PROJECT NAME
283 + 285 MCLEOD ST
OTTAWA, ON

OTTAWA, ON
DRAWING TITLE
SITE PLAN

SCALE
AS NOTED
DRAWN BY
DAVID MURCIA
DATE
5/2/23
PROJECT NO.
019-17
DRAWING NO.
SP1
PLAN NO.: 18721
D01-01-21-0014 & D02-02-21-0084

SITE PLAN
SP1 1:1000